

# SPECIFICATIONS

## Material:

Insulator: Glass filled PA6T (UL94V-0), BK, 30%G/F

Contacts: Brass

Contact Plating: Au or Sn over 50u'' Ni

Plating: 1u'' Au

## Electrical Characteristics:

Contact Resistance: 20mΩ Max.

Insulator Resistance: 1000MΩ Min.

Withstanding Voltage: AC 500V

Current Rating: 1.5 AMP

Operating Temperature: -40°C to +105°C

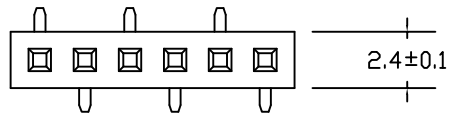

TYPE 1

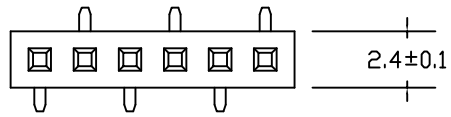

TYPE 2

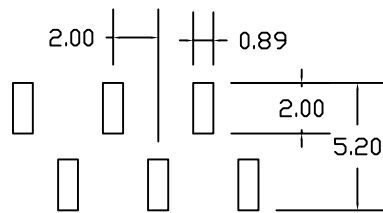
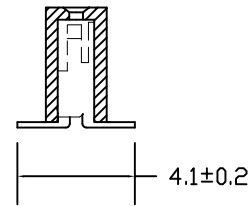
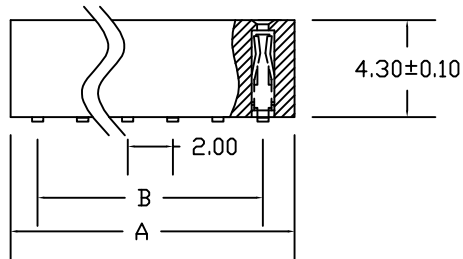

TYPE 1

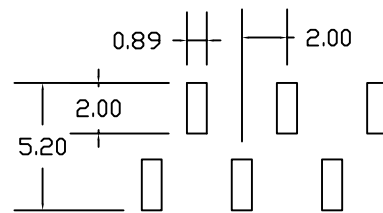

TYPE 2

P. C. B LAYOUT

Position Dimension	1 Thru 40
A± 0.30	2.00 * No. of Positions+0.40
B± 0.20	2.00 * No. of Contacts-2.00

MATERIAL(材质)		单位 MM	比例 按图纸缩放	日期 2013-04-20	深圳市百富特电子 有限公司	
主体	PA6T				制图	审查
端子	黄铜镀金	刘建				
公差 分段	>10 ±0.30 <10 ±0.20 <3 ±0.10				2.0(H4.3)1mP SMT	
视角						