

# Pressure Regulator for Battery with Joint Supply

RE / R135

<b>Description</b>	Diaphragm pressure regulator, with joint pressure supply. Modular assembly without need for double nipples or other fittings. Outlet at rear side, gauge port in the front.		
<b>Media</b>	compressed air or non-corrosive gases		
<b>Supply pressure</b>	max. 16 bar, max. 10 bar for R135		
<b>Air consumption</b>	without constant bleed		
<b>Adjustment</b>	by plastic knob with snap-lock, R135 without snap-lock		
<b>Relieving function</b>	relieving, optionally non-relieving		
<b>Gauge port</b>	G $\frac{1}{8}$ at R135 and RE-02,		G $\frac{1}{4}$ at all others
<b>Mounting position</b>	any		
<b>Temperature range</b>	0 °C to 50 °C / 32 °F to 122 °F		
<b>Material</b>	Body: zinc die-cast, POM at R135	Adjusting knob: plastic	Inner valve: brass
	Elastomer: NBR/Buna-N		
	Thread insert: brass at R135		

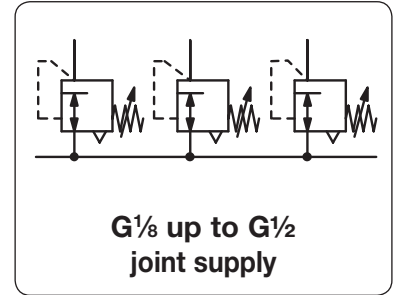

Dimensions			K <sub>v</sub> partition	K <sub>v</sub> value	Flow rate		Connection thread	Pressure range	Order number
A	B	C			m <sup>3</sup> /h*1	l/min*1			

## Pressure regulator supply pressure max. 16 bar, relieving series R135 max. 10 bar, without gauge **RE / R135**

36	61	12	36	0.11	15	250	G $\frac{1}{8}$	0 ... 6	<b>R135-01RE</b>
40	84	12	40	0.60	60	1000	G $\frac{1}{4}$	0.1 ... 3 0.2 ... 6 0.5 ... 10	<b>RE-02B</b> <b>RE-02C</b> <b>RE-02D</b>
48	94	22	45	1.3	126	2100	G $\frac{1}{4}$	0.1 ... 3 0.2 ... 6 0.5 ... 10 0.5 ... 16	<b>RE-A2B</b> <b>RE-A2C</b> <b>RE-A2D</b> <b>RE-A2E</b>
58	114	27	55	1.9	192	3200	G $\frac{3}{8}$	0.1 ... 3 0.2 ... 6 0.5 ... 10 0.5 ... 16	<b>RE-03B</b> <b>RE-03C</b> <b>RE-03D</b> <b>RE-03E</b>
70	133	36	66	2.4	240	4000	G $\frac{1}{2}$	0.1 ... 3 0.2 ... 6 0.5 ... 10 0.5 ... 16	<b>RE-04B</b> <b>RE-04C</b> <b>RE-04D</b> <b>RE-04E</b>



## Accessories, enclosed

<b>pressure gauge</b>	Ø 23 mm, 0 ... *2 bar, G $\frac{1}{8}$	for RE-02 / R135	<b>MA2301-...*2</b>
	Ø 40 mm, 0 ... *2 bar, G $\frac{1}{4}$ , connection parts required	for RE-A2	<b>MA4001-...*2</b>
	Ø 50 mm, 0 ... *2 bar, G $\frac{1}{4}$	for RE-03 / RE-04	<b>MA5002-...*2</b>
<b>connection parts</b>	for gauge MA4001, G $\frac{1}{4}$ m to G $\frac{1}{8}$ f		<b>VI-0201</b>
<b>mounting bracket</b>	made of steel	for RE-02 / RE-A2	<b>BW30-02</b>
<b>mounting nut</b>	made of plastic	for RE-02 / RE-A2	<b>M30x1,5K</b>
<b>mounting bracket</b>	made of steel	for RE-03	<b>BW00-25</b>
<b>mounting nut</b>	made of plastic	for RE-03	<b>M42x1,5K</b>
<b>mounting bracket</b>	made of steel	for RE-04	<b>BW50-03</b>
<b>mounting nut</b>	made of plastic	for RE-04	<b>M50x1,5K</b>
<b>connection clips</b>	made of plastic	for R135	<b>C350100018</b>
<b>connector kit</b>	for RE-02	for RE-03	<b>KP22</b>
	for RE-A2	for RE-04	<b>KP33</b>

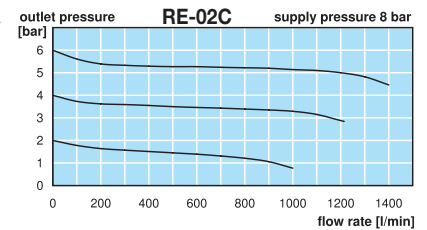
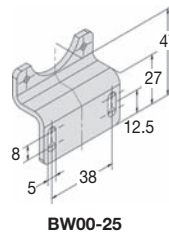
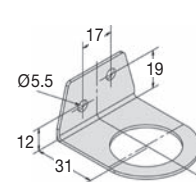
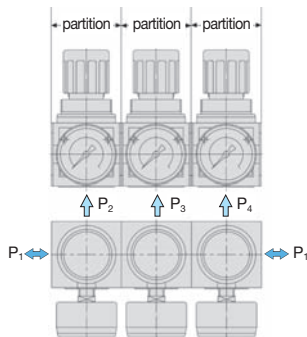
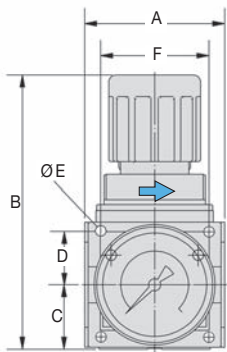

series	D	Ø E	F
R135	8	3.5	20
RE-A2	12	4.4	36
RE-04	18	5.5	54

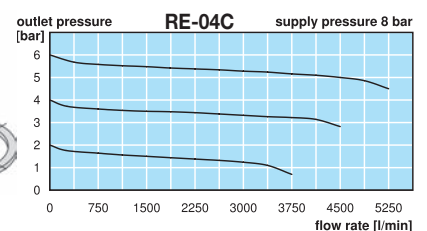
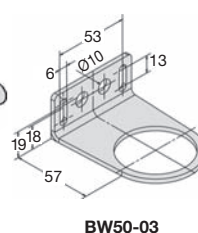
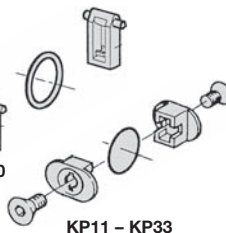

\*1 at 8 bar supply pressure, 6 bar outlet pressure and 1 bar pressure drop  
\*2 04 = 0...4 bar, 06 = 0...6 bar, 10 = 0...10 bar, 16 = 0...16 bar



**Order example:**  
**R135-01RE**

China website: [www.duray-control.cn](http://www.duray-control.cn)