

Leica

LED 1000

modular daylight illumination

for stereomicroscopes

Leica

Daylight quality illumination

This Leica-LED-illumination sets new standards in the illumination for stereo microscopes by providing daylight quality illumination in combination with additional unique features:

- Daylight light quality (5.000 K)
- Flicker-free illumination
- Ripple-free illumination
- “Cold light”
- Continuous brightness control
- Long lifetime of the bulbs, as typical for LED's
- Operation without noise and vibration
- Extremely compact design
- No breakable or sensitive light guides
- Antistatic ringlight and spotlight-housing
- Noise- and vibration-free
- Possibility of mobile operation, by using a 24 V battery
- Power supply with automatic calibration for operation from 100 - 240 V
- Modular system
- Extensive range of accessories
- Excellent price-performance ratio

The system

The modular system consists of the following basic modules:

- Power supply with control unit
- LED-modules
- Accessories

The following combinations are possible:

power supply and control unit together with:

- One ringlight
- One or two spotlights
- One ringlight and one spotlight

The modules



Power supply

The automatic switch mode power supply is adjusting itself automatically to the available mains voltage from 100 V to 240 V and provides a stable light output during voltage fluctuations. It has a 3-pin plug connector.



Control unit

The compact control unit features an ON-OFF switch, an infinitely adjustable brightness regulator with a "turbo range", and two connection sockets for accommodating the LED illumination units.



LED ringlight

The LED ringlight contains 40 LED's and provides an exceptionally bright and homogenous illumination of the object. It is designed for microscopes with an objective diameter of 66 mm. The fixation of the ringlight at the microscope is secured by means of a screw and spring in a way which protects the objective. For other objectives suitable adapters are available.



LED spotlight

The LED spotlight contains 19 LED's and can be attached directly to the microscope and positioned as required by means of a gooseneck. The goosenecks also can be attached to the base plate.



Adapters for ringlight

For the fixation of the ringlight to other objectives, suitable adapters are available.



Polarisation filter for ringlight

The polarisation filter set consists of a polarizer and an analyzer and eliminates reflections. The analyser is inserted into the ringlight, the turnable polarizer is attached outside the ringlight.



Filters for spotlight

Snap-on filters are available in the colours blue, green, yellow and red.



Goose neck arms for spotlight

The semi rigid gooseneck arms allow the required positioning of the spotlight. They are available in different lengths. They are inserted into the spotlight and can be fixed either on the microscope or on the base plate.



Base plate for goose neck arm

The base plate allows, in combination with the gooseneck arm, an absolutely free positioning of the spotlight.



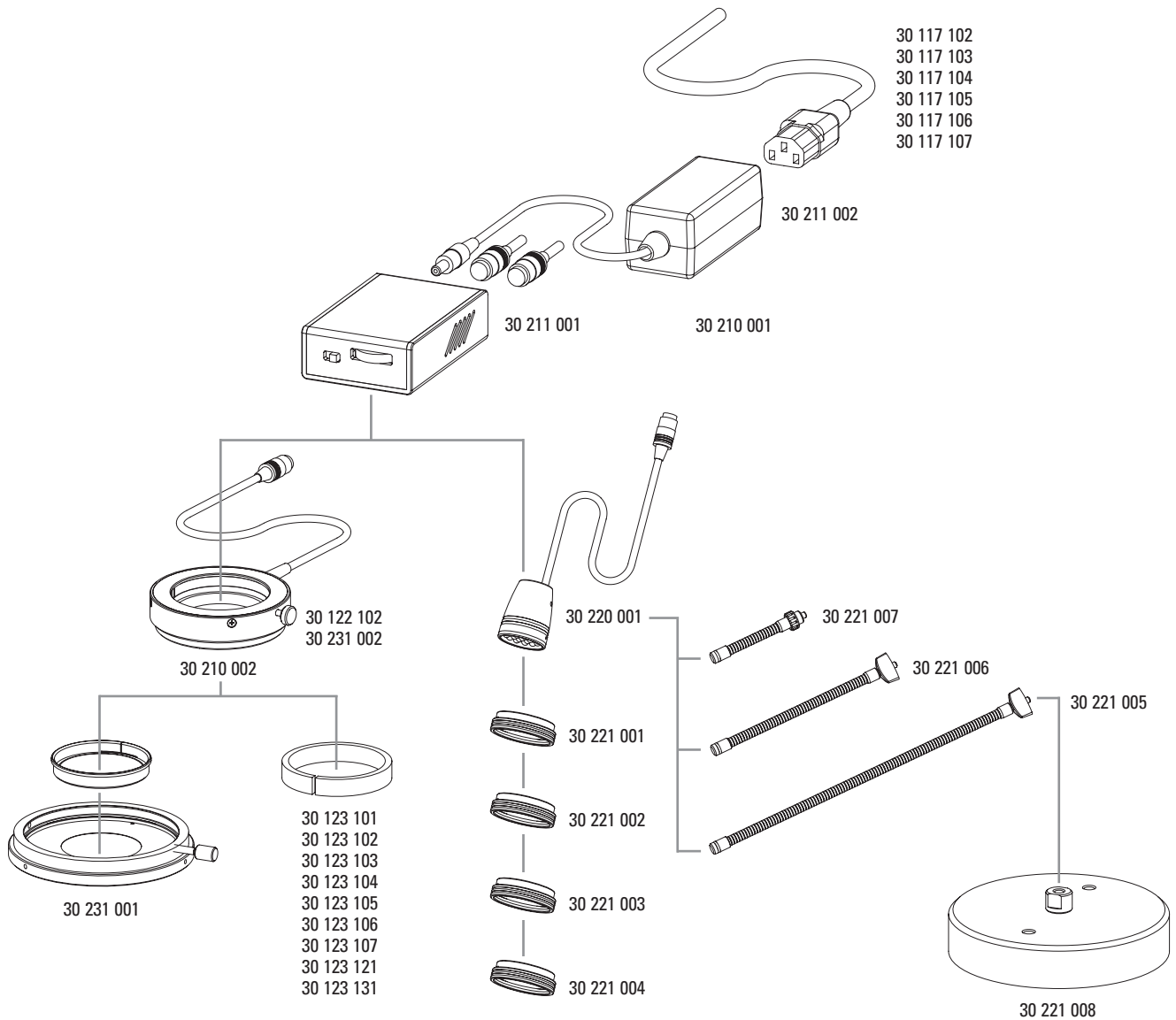

Catalogue references

Item No.

30 210 001 Power supply with control unit
 30 211 001 Control unit
 30 211 002 Power supply
 30 210 002 LED ringlight (incl. adapter 66/58 mm)
 30 220 001 LED spotlight
 30 117 102 Power cord USA/Can/J
 30 117 103 Power cord Italy
 30 117 104 Power cord EU
 30 117 105 Power cord Switzerland
 30 117 106 Power cord UK
 30 117 107 Power cord Australia
 30 221 005 Goose neck L = 85mm
 30 221 006 Goose neck L = 200mm
 30 221 007 Goose neck L = 300mm
 30 221 008 Base plate for M5 screw

30 123 101 Adapter for MS5/MZ6 (Achr. obj. 1.0x/0.8x/0.63x/0.32x)
 30 123 102 Adapter for MS5/MZ6 (Achr. obj. 1.5x)
 30 123 103 Adapter for MS5/MZ6 (Achr. obj. 2.0x)
 30 123 104 Adapter for M420 (Obj. Makro/Apo Zoom)
 30 123 105 Adapter for M5A (Add. obj. 2.0x/1.5x/0.5x)
 30 123 106 Adapter for MZ6 Obj. 411597
 30 123 107 Adapter for ringlight 66/58 mm
 30 123 121 Adapter for GZ6 (only for working distance 150 mm and more)
 30 123 131 Adapter for GZ4
 30 231 001 Polarizing filter set
 30 221 001 Filter blue
 30 221 002 Filter green
 30 221 003 Filter yellow
 30 221 004 Filter red
 30 122 102 Clamping ring for LED ringlight
 30 231 002 Screw for clamping ring for ringlight

Technical data

Mains supply unit:

Plug connector	3-pin IEC 320
Voltage range	100 - 240 V AC
Mains frequency	50/60 Hz
Max. power input	15 VA
Dimensions	91.5 x 40.5 x 28.5 mm

Control unit:

Power supply	24 V DC +/- 5 %, hollow pin plug 5.5 x 2.1 mm, 250 mA
Connections to ring- and spotlight	2 x 9-pin mini DIN sockets
Other elements	ON-OFF switch and potentiometer wheel
Brightness control	3 - 30 mA
Dimensions	95.5 x 64 x 28.5 mm

Ringlight:

LED's	40
Colour temperature	5.000 K
Material	anti static
Dimensions	for objective \varnothing 66 mm, exterior \varnothing 94 mm, h = 25 mm
Length of cable	1.000 mm

Spotlight:

LED's	19
Colour temperature	5.000 K
Material	anti static
Dimensions	\varnothing 34 mm, h = 45 mm
Length of cable	1.000 mm

Goose necks:

Material	semirigid brass-steel, black painted
Dimensions	\varnothing 8 mm, l = 85/200/300 mm

Conformity with standards

CE

Dimensions

