

緩啟動控制器 KL-SS1

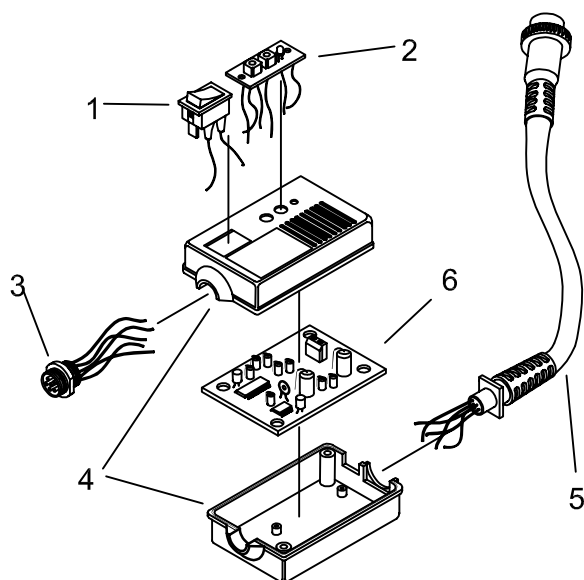

No.	料號	名稱
1.	HC10004	切換開關
2.	HC10002	微調電阻半成品
3.	PZ50165	插座
4.	EC30006-2	外殼(組)
5.	AA50001-6	電線(六芯一尺)
6.	EG50103	電路板
*		
*		

需求:

本控制器需與下列電源控制器配合使用:
SK-DU1(2), SKP-32HL(VR).

規格:

可調緩啟動時間: 0~3 秒.

可調緩啟動速度: 30%~100% 額定轉速.

電線長度: 1 尺.

體積: 58*95*35mm (L*W*H)

剎車信號輸出: 繼電器接點. (Normal open)

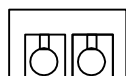

剎車信號輸出接點額定規格:
30Vac 1A, 60Vdc 0.3A.

操作說明:

- 關閉電源控制器的電源.
- 將電線接頭連接到電源控制器, 將電動起子電線接至插座上.
- 打開電源控制器的電源, 調整需求的緩啟動時間與速度即可.

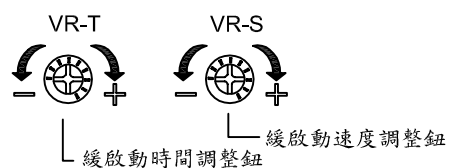

- 當反轉鬆退螺絲時可用切換開關關閉緩啟動的功能.

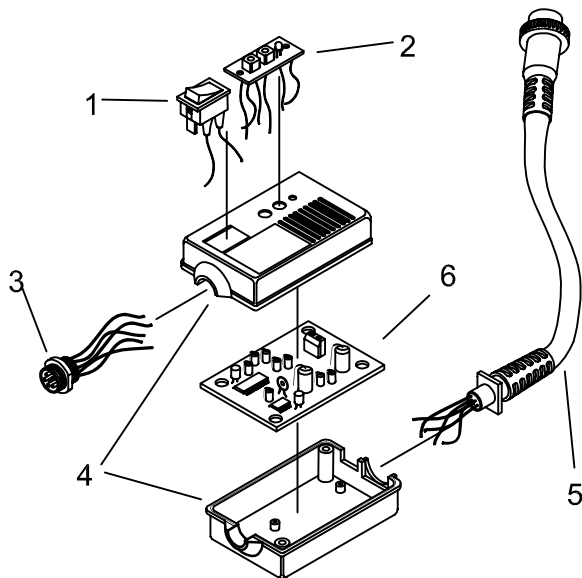

CONTROL MODULE

Model: **KL-SS1**

No.	Part no.	Description.
1.	HC10004	Bypass Switch
2.	HC10002	Potentiometer Ass'y
3.	PZ50165	Receptacle
4.	EC30006-2	Case (A pair)
5.	AA50001-6	Cable 1 feet
6.	EG50103	Control Board
*		
*		

Requirements:

This control module needs to be used with controllers: SK-DU1(2) ,SKP-32HL(VR).

Specifications:

Slow-Start time: 0~3 seconds.

Slow-Start speed: 30%~100% of full speed.

Cable: 1 feet.

Dimension: 58*95*35mm (L*W*H)

Signal output: Relay contact. (Normal Open)

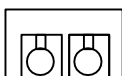

Signal output contact rating:
30Vac 1A , 60Vdc 0.3A.

Operating Instruction:

- . Turn off the power controller.
- . Connect the cable to controller, and the receptacle to screwdriver.
- . Turn on the power controller, then adjust the speed and time from potentiometer for any need.

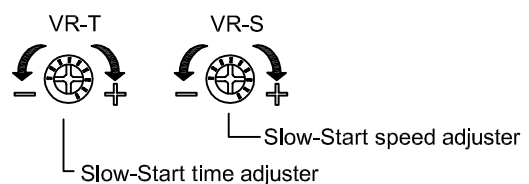

- . Switch the by-pass switch to stop the slow-start action when reverse.