



Introducing Corcom Medium Performance P Series Power Entry Modules

TE Connectivity has expanded the Corcom P Series power entry modules to include a new medium performance filter option. The medium P Series modules features better performance than the standard filter option in a smaller size than the high performance filter. Filters are available in 3, 6 or 10A ratings. Modules are available in either snap-in or flange mount versions with a choice of horizontal or vertical mounting ears. The medium performance P Series modules are available with either single or dual fuses and may be configured with an optional DPST switch. The medium performance P Series modules are suitable for applications with increased attenuation requirements in higher frequencies where a smaller size is desirable.





KEY FEATURES

- Dual stage electrical setup
- High attenuation at higher frequencies
- Compact design
- Snap-in or flange mounting
- Standard IEC 60321-1 C14 power inlet
- Optional DPST switch
- Single or dual North American or Metric fusing capabilities
- UL Recognized, CSA Certified and VDE Approved

APPLICATIONS

- Switch mode power supplies
- Vending & service machines
- Computing & accessories
- Home appliances
- Gaming equipment
- Fitness equipment
- Measuring & test equipment
- Instrumentation

STANDARDS AND SPECIFICATIONS

- UL Recognized
- CSA Certified
- VDE Approved



ELECTRICAL SPECIFICATIONS

Maximum leakage current each Line to Ground:	@120 VAC 60 Hz:	.25 mA
	@ 250 VAC 50 Hz:	.50 mA
Hipot rating (one minute):	Line to Ground:	2250 VDC
	Line to Line:	1450 VDC
Rated Voltage (max.):		250 VAC
Operating Frequency:		50/60 Hz
Rated Current:		3 to 10A
Fuseholder:		Accepts one or two fuses .25 x 1.25" (not included) or 5 x 20mm (not included)
Switch:		DPST 10,000 operations at 51A max. inrush

ELECTRICAL SCHEMATICS

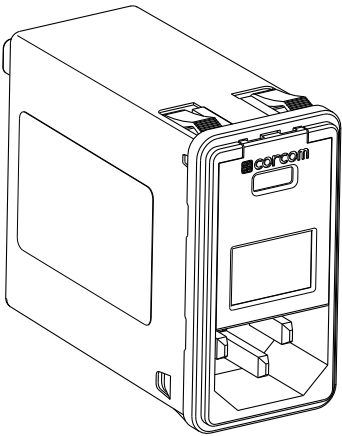
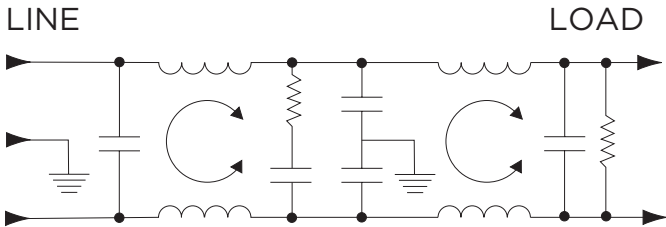

www.jielingchina.com

ORDERING INFORMATION

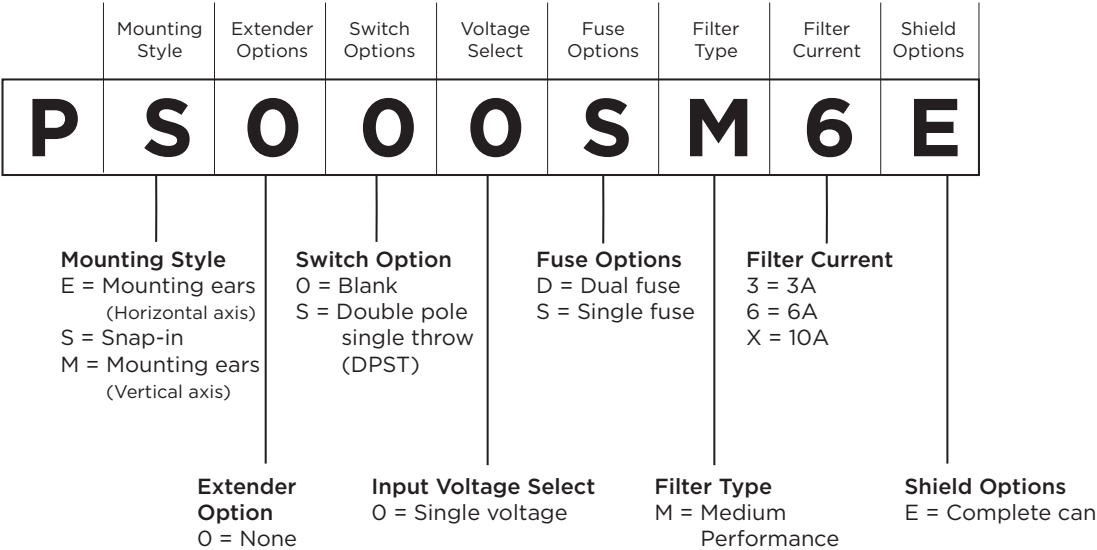

PRODUCT OFFERING

E Style Mounting Ears		M Style Mounting Ears		Snap-In	
4-1609154-1:	PEO0SM3E	4-1609155-3:	PM00SM3E	4-1609152-7:	PS00SM3E
4-1609154-2:	PEO0SM6E	4-1609155-4:	PM00SM6E	4-1609152-8:	PS00SM6E
4-1609154-3:	PEO0SMXE	4-1609155-5:	PM00SMXE	4-1609152-9:	PS00SMXE
4-1609154-4:	PEO0DM3E	4-1609155-6:	PM00DM3E	4-1609153-0:	PS00DM3E
4-1609154-5:	PEO0DM6E	4-1609155-7:	PM00DM6E	4-1609153-1:	PS00DM6E
4-1609154-6:	PEO0DMXE	4-1609155-8:	PM00DMXE	4-1609153-2:	PS00DMXE
4-1609154-7:	PEOSM3E	4-1609155-9:	PMOSM3E	4-1609153-3:	PSOSM3E
4-1609154-8:	PEOSM6E	4-1609156-0:	PMOSM6E	4-1609153-7:	PSOSM6E
4-1609154-9:	PEOSMXE	4-1609156-1:	PMOSMXE	4-1609153-5:	PSOSMXE
4-1609155-0:	PEOSDM3E	4-1609156-2:	PMOSDM3E	4-1609153-6:	PSOSDM3E
4-1609155-1:	PEOSDM6E	4-1609156-3:	PMOSDM6E	4-1609153-9:	PSOSDM6E
4-1609155-2:	PEOSDMXE	4-1609156-4:	PMOSDMXE	4-1609154-0:	PSOSDMXE

www.jielingchina.com

PERFORMANCE DATA

Typical Insertion Loss - Measured in closed 50 Ohm system

Common Mode / Asymmetrical (L-G)
Differential Mode / Symmetrical (L-L)

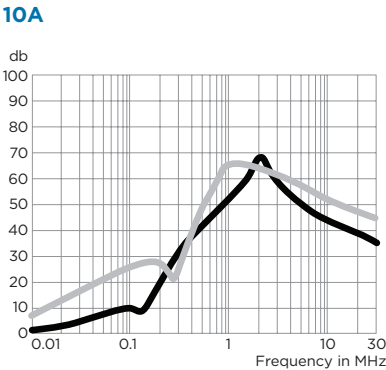
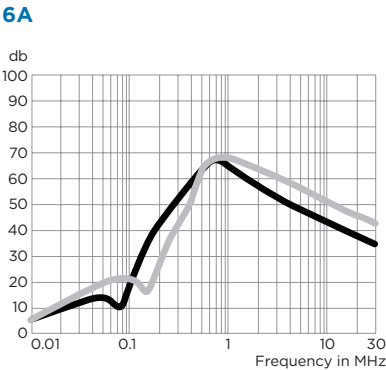
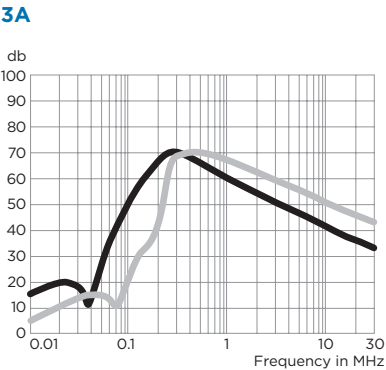

Minimum Insertion Loss - Measured in closed 50 Ohm system

Common Mode / Asymmetrical (Line to Ground)

Current Rating	Frequency — MHz					
	.15	.5	1	5	10	30
3A	50	60	60	45	40	30
6A	34	58	58	42	37	30
10A	6	35	45	45	38	30

Differential Mode / Asymmetrical (Line to Line)

Current Rating	Frequency — MHz					
	.15	.5	1	5	10	30
3A	25	60	60	50	45	40
6A	9	50	62	51	46	40
10A	10	20	59	52	48	40

www.jielingchina.com

QUESTIONS TO ASK WHEN DESIGNING IN A CORCOM FILTER

- “Are you experiencing unwanted conducted radio frequency interference (RFI¹) ?”
- “How are you addressing your CE or FCC conducted RFI issues ?”
- “How are you ensuring compliance with safety agency standards ?”

CORCOM ADVANTAGE:

- Broad standard catalog product offering
- Superior Corcom brand equity & print position
- Product samples available
- Customized and value-added solutions available
- Complimentary screen room services available to assist customers with product selections
- Easy website to navigate – corcom.com

¹ Radio Frequency Interference is also commonly referred to as “electronic noise”

CASE STYLES

Front View

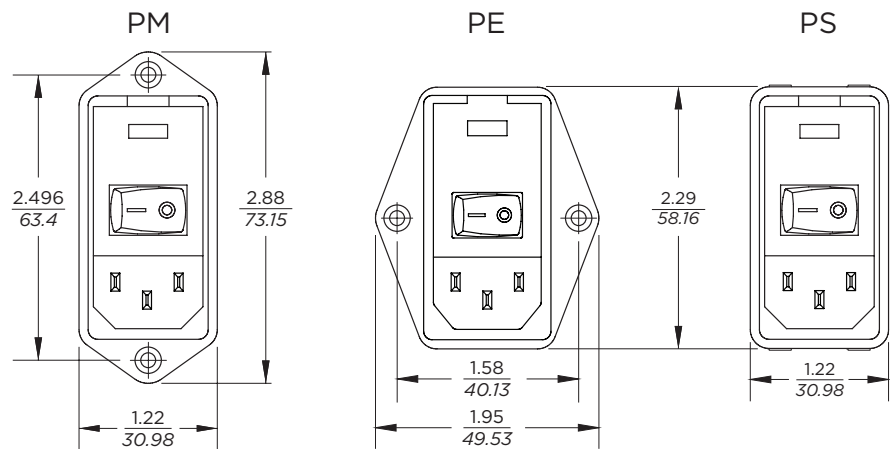

Side View

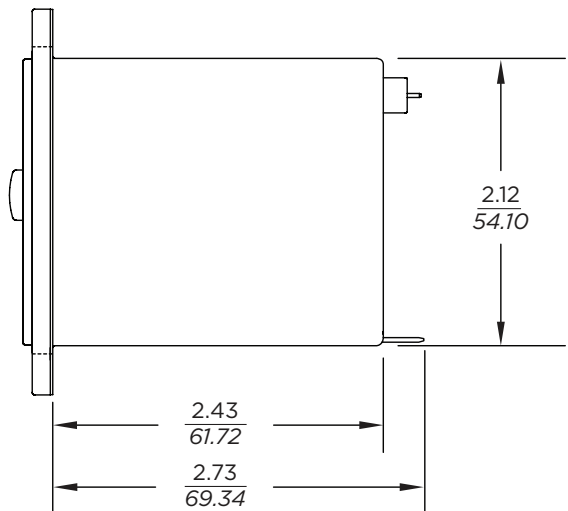

Typical Dimensions:

Line Inlet (1):	IEC 60320-1 C14
Mounting Holes (2):	.135 [3.43] Dia. with .23 [5.9] Dia. x 90° countersink for #4 flathead screw (PM, PE only)
Terminals (2):	.187 [4.8] quick connect tabs

www.jielingchina.com