

LOC	DIST	REVISIONS					
		P	LTR	DESCRIPTION	DATE	DWN	APVD
ES	00		D6	REVISED -17	11JULY2012	OL	SZ
			D8	ADDED NEW DASH NUMBER -18	27JUN2013	CZ	SZ
			D9	REV PER ECR-13-012441	27AUG2013	CZ	SZ

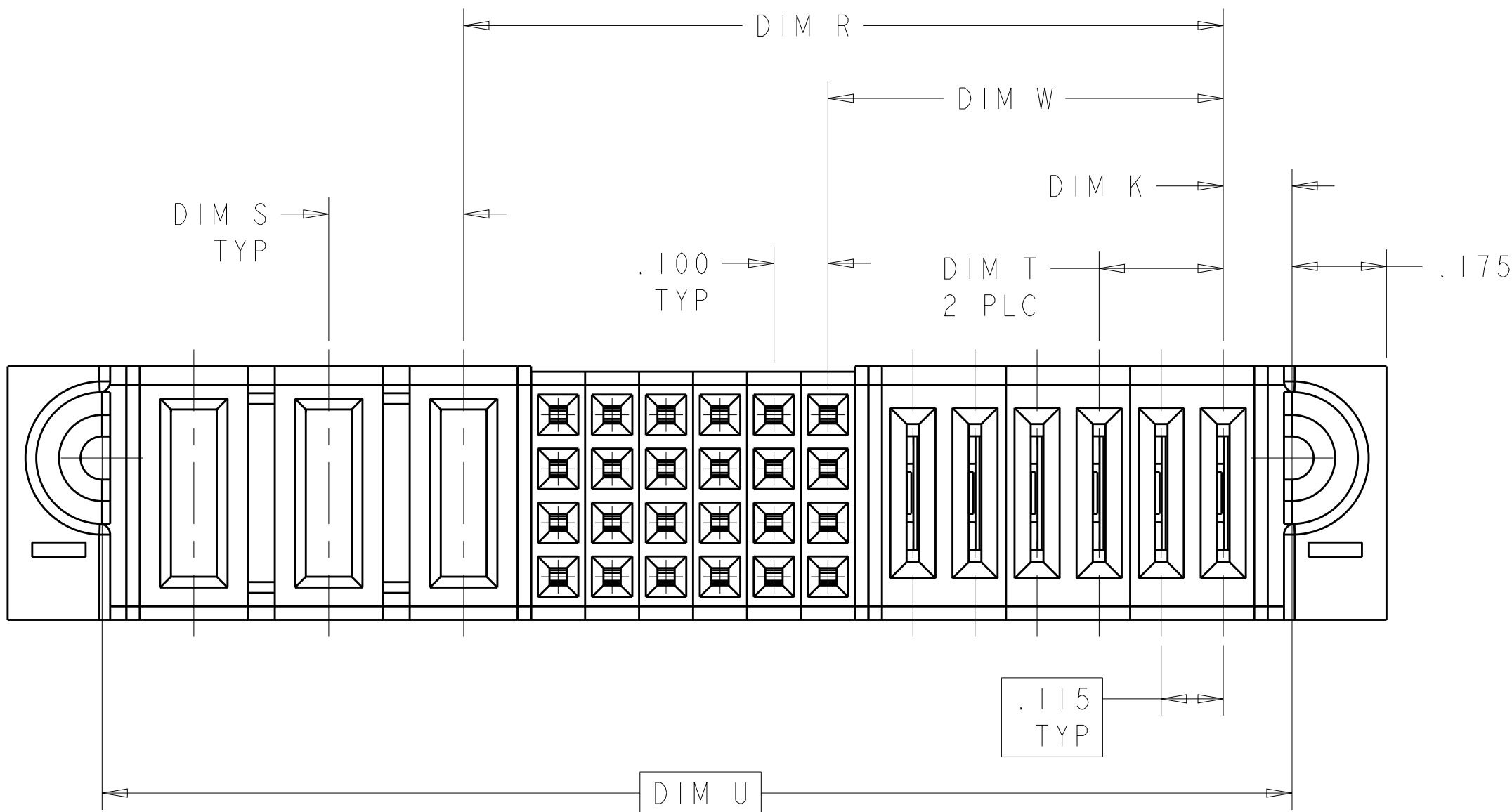

- 1 "AMP", TRADEMARK, PART NUMBER AND DATE CODE TO BE MARKED IN AREA SHOWN
- 2 MATERIAL: HOUSING - GLASS FILLED HIGH TEMP THERMO PLASTIC, UL94 V-O, BLACK
SIGNAL CONTACT - HIGH CONDUCTIVITY COPPER ALLOY
POWER CONTACT - HIGH CONDUCTIVITY COPPER ALLOY
- 3 CONTACT PLATING: NOBLE METAL PLATING ON CONTACT FUNCTIONAL AREA OF POWER AND SIGNAL CONTACTS
- 4 MECHANICAL CONNECTOR KEEP OUT ZONE
- 5 DATUM AND BASIC DIMENSIONS ESTABLISHED BY CUSTOMER
- 6 PCB - ALL HOLE DIAMETERS ARE FINISHED HOLE SIZES
- 7 PCB - .0453 ±.0010 DRILLED HOLES PLATED WITH .0003 MIN Sn OVER .001 TO .003 CU PLATING TO ACHIEVE A .040±.003 DIA HOLE
- 8 DIM W & DIM R ARE APPLICABLE TO P+S+P CONFIGURATION.
- 9 FOR P/N 6450850-3,-11,THE VARIABLE DIMENSIONS PLEASE SEE SHEET 2.
- 10 VARIABLE DIMENSIONS SHOW ON TABLE OR PART VIEW

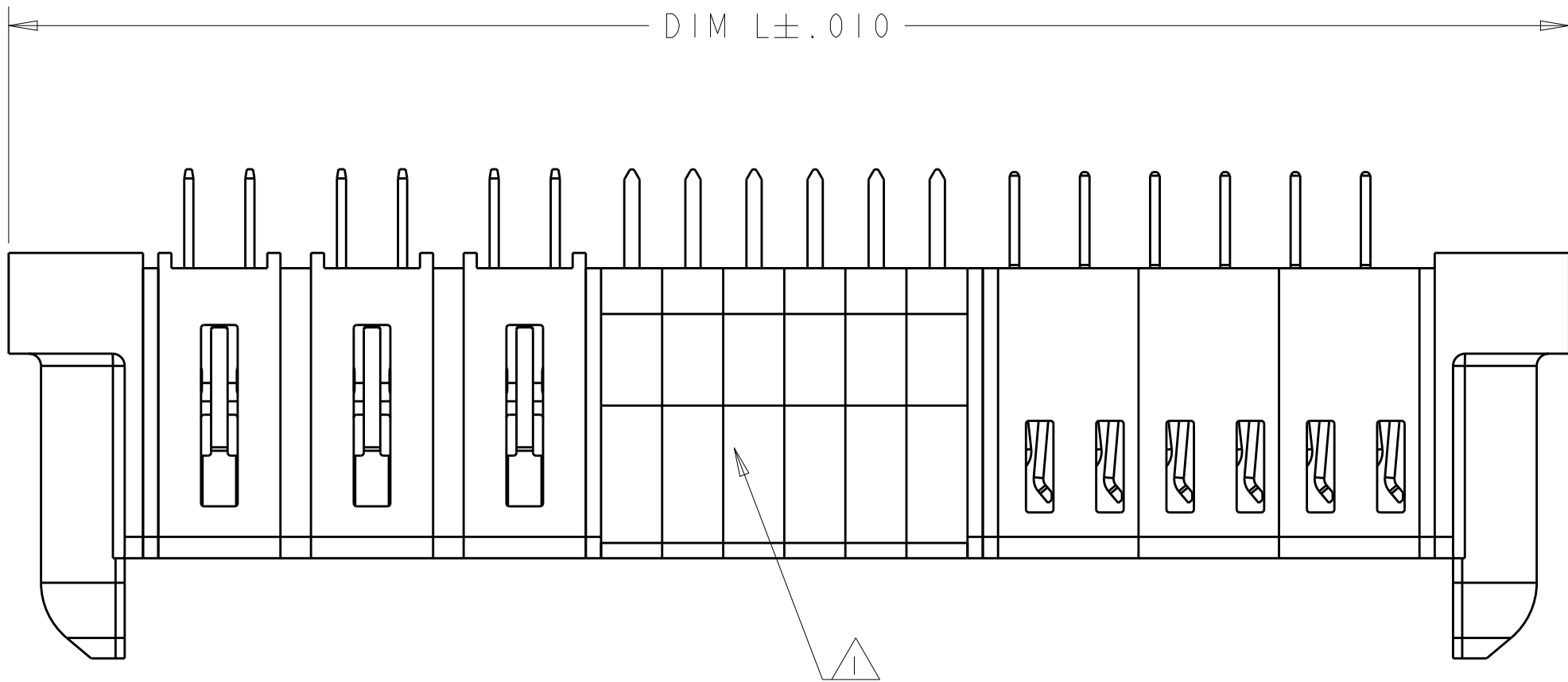
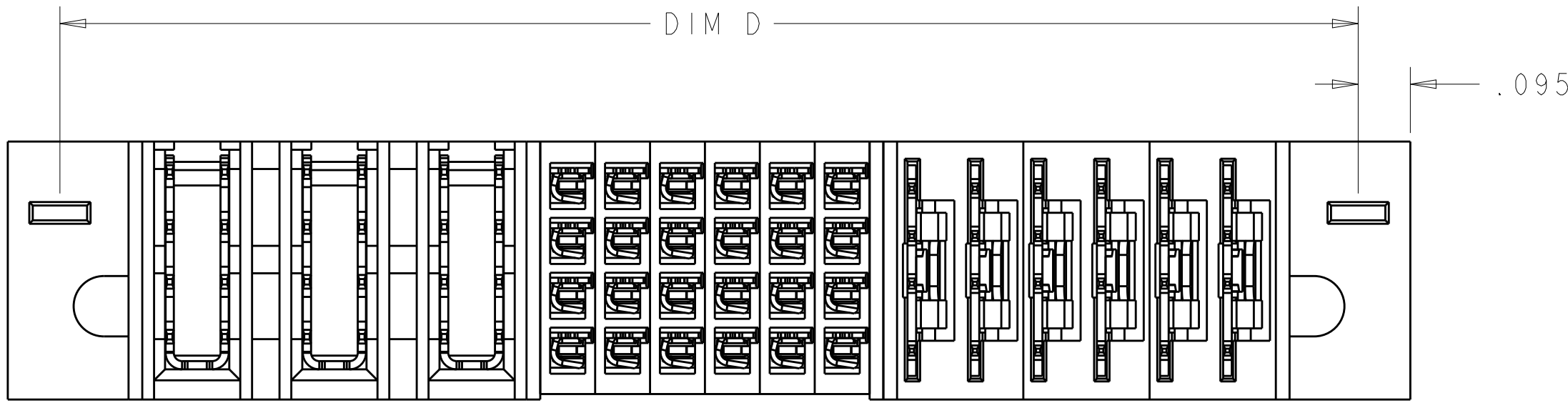
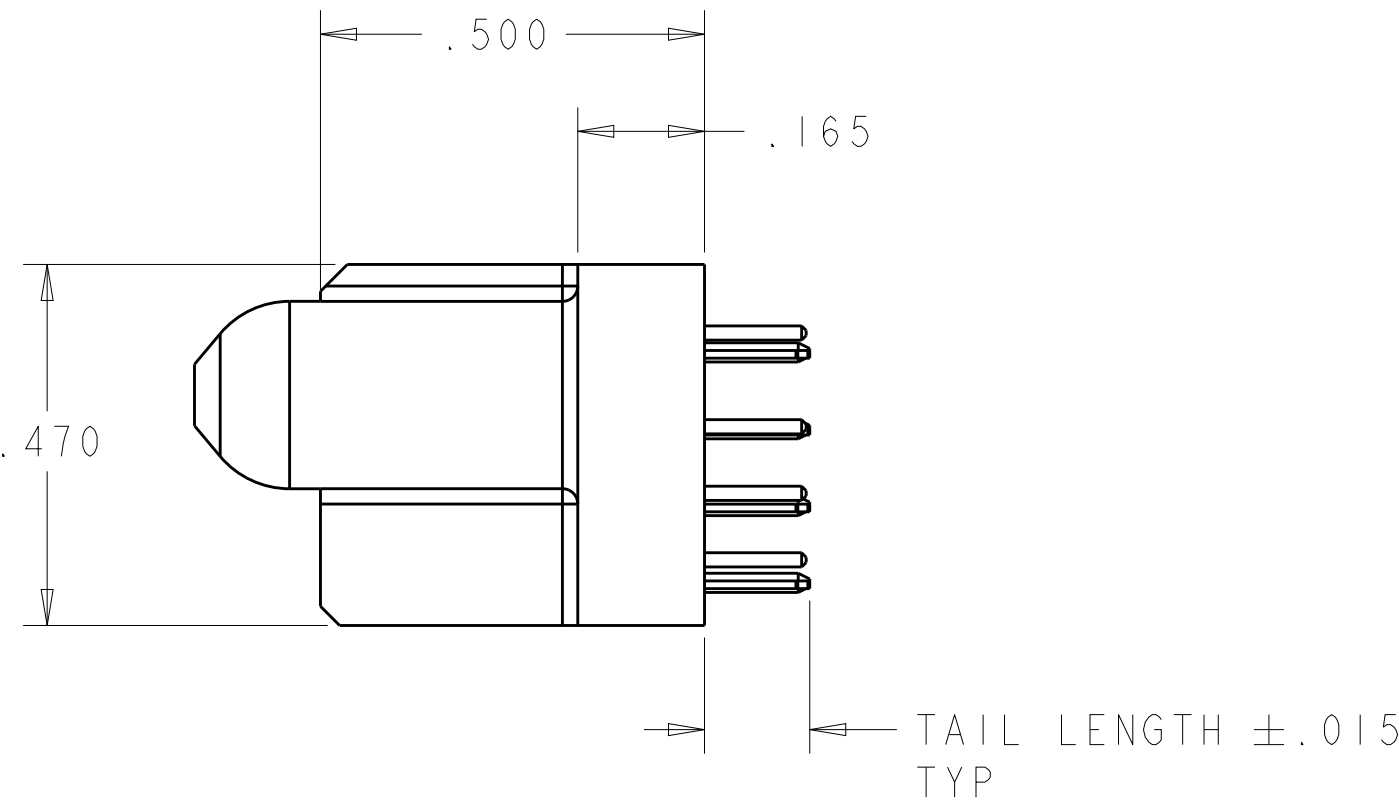

D8	10	10	10	10	3.270	2.920	3.080	.170	5HDP + 24S + 1P + 7LP	I-6450850-8
	-	-	.500	.200	1.140	.790	.950	.145	IP + 8S + 1P	I-6450850-7
	.300	.250	1.250	.775	2.940	2.590	2.750	.170	3ACP + 16S + 5P	I-6450850-6
	.200	.200	.800	.350	1.840	1.490	1.650	.145	2P + 16S + 3P	I-6450850-4
	.250	.250	1.300	.925	2.740	2.390	2.550	.170	4P + 12S + 4P	I-6450850-3
	-	-	.850	.175	1.540	1.190	1.350	.170 9	IP + 24S + 1P	I-6450850-1
	-	-	.850	.175	1.540	1.190	1.350	.170 4	IP + 24S + 1P	6450850-3
	.230	.250	1.4075	.7325	2.555	2.205	2.365	.1275	6LP + 24S + 3P	6450850-2
	DIM T	DIM S	DIM R 8	DIM W 8	DIM L	DIM U	DIM D	DIM K	DESCRIPTION	PART NUMBER

THIS DRAWING IS A CONTROLLED DOCUMENT.

DIMENSIONS:
INCHES

MATERIAL

TOLERANCES UNLESS OTHERWISE SPECIFIED:

0 PLC ±.01
1 PLC ±.01
2 PLC ±.01
3 PLC ±.005
4 PLC ±.0020
ANGLES ±2°
FINISH

DWN S.ZHAO 20SEP2007
CHK S.ZHAO 20SEP2007
APVD S.YAO -

PRODUCT SPEC 108-1973
APPLICATION SPEC 114-13038
WEIGHT -

CUSTOMER DRAWING

TE Connectivity

VERTICAL RECEPTACLE ASSEMBLY, WITH GUIDES MULTI-BEAM XLE

SIZE A100779 CAGE CODE 6450850
SCALE 4:1 SHEET 1 OF 6 REV D9

LOC	DIST	REVISIONS					
ES	00	P	LTR	DESCRIPTION	DATE	DWN	APVD
		-	-	SEE SHEET 1	-	-	-

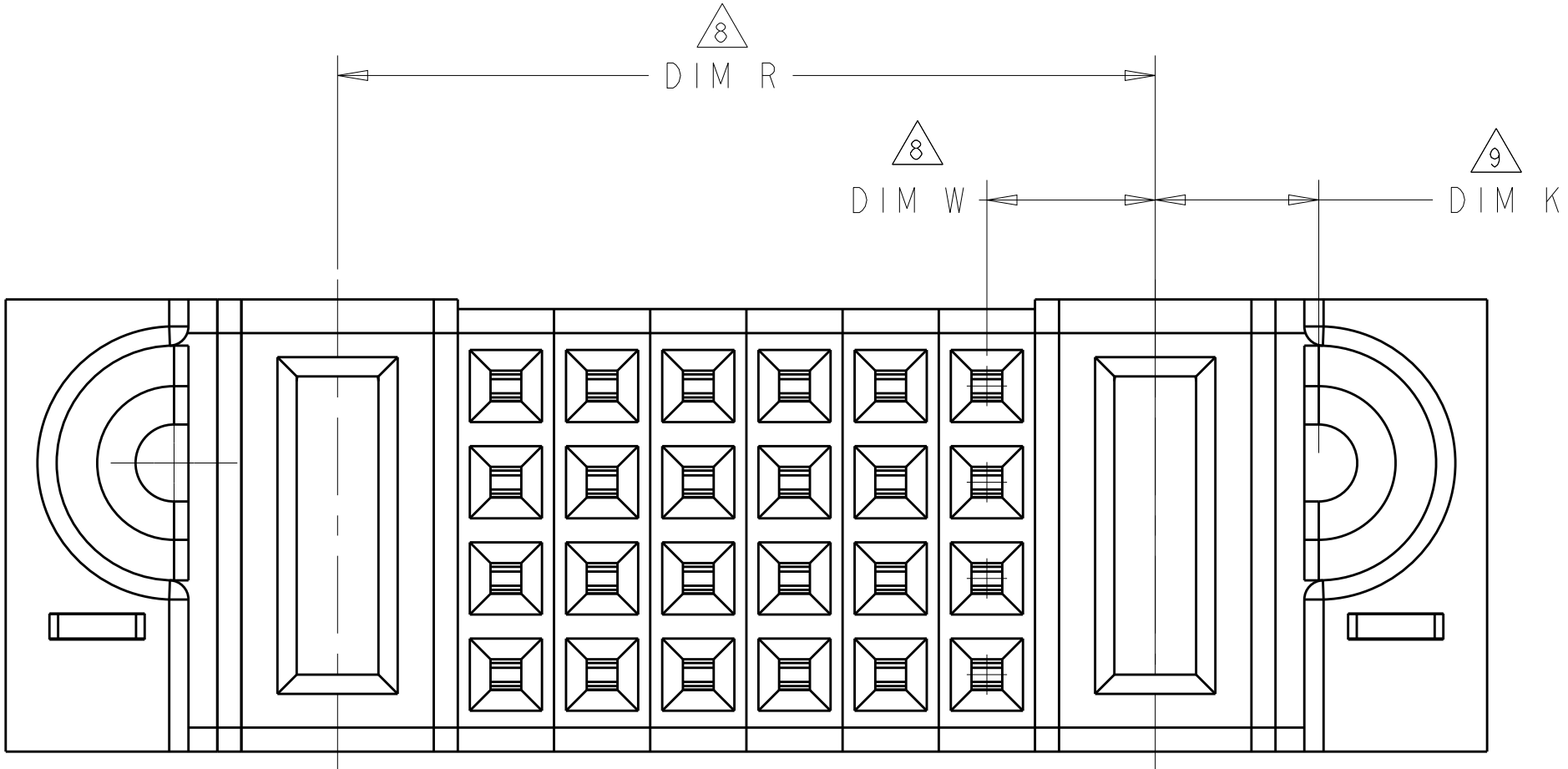

FOR P/N 6450850-3,-11,THE OTHER DIMENSIONS PLEASE SEE THE TABLE OF SHEET 1.

THIS DRAWING IS A CONTROLLED DOCUMENT.

DWN
S.ZHAO
20SEP2007

CHK
S.ZHAO
20SEP2007

APVD
S.YAO
-

DIMENSIONS:
INCHES

0 PLC ±"
1 PLC ±.01
2 PLC ±.01
3 PLC ±.005
4 PLC ±.0020
ANGLES ±2°
FINISH -

TOLERANCES UNLESS
OTHERWISE SPECIFIED:

PRODUCT SPEC
108-1973
APPLICATION SPEC
114-13038
WEIGHT -

MATERIAL
-

CUSTOMER DRAWING

NAME
VERTICAL RECEPTACLE ASSEMBLY,
WITH GUIDES
MULTI-BEAM XLE

SIZE
A1

CAGE CODE
00779

DRAWING NO
C=6450850

RESTRICTED TO
-

TE Connectivity

SCALE
4:1

SHEET
2

OF
6

REV
D9

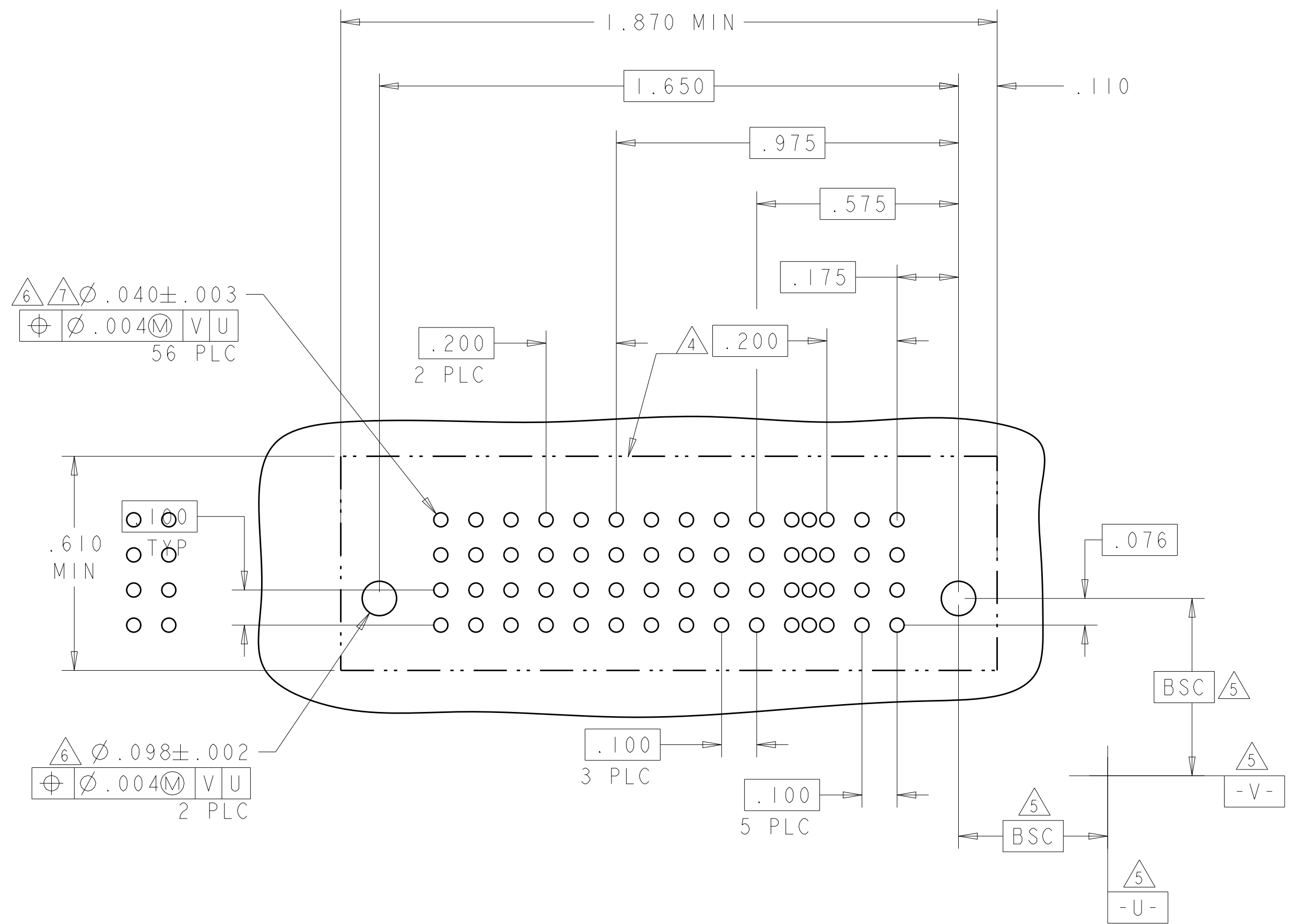
[illegible]4805 (3/11)

LOC		DIST		REVISIONS			
ES	00	P	LTR	DESCRIPTION	DATE	DWN	APVD
		-		SEE SHEET 1	-	-	-

PART NUMBER	ROWS		POWER					SIGNAL				POWER			
			P8	P7	P6	P5	P4	4	3	2	1	P3	P2	P1	
1-6450850-6	D		VA	VM	VM	VM	VA	E	E	E	E	VM	VM	VA	
	C							E	E	E	E				
	B							E	E	E	E				
	A							E	E	E	E				
3ACP + 16S + 5P															

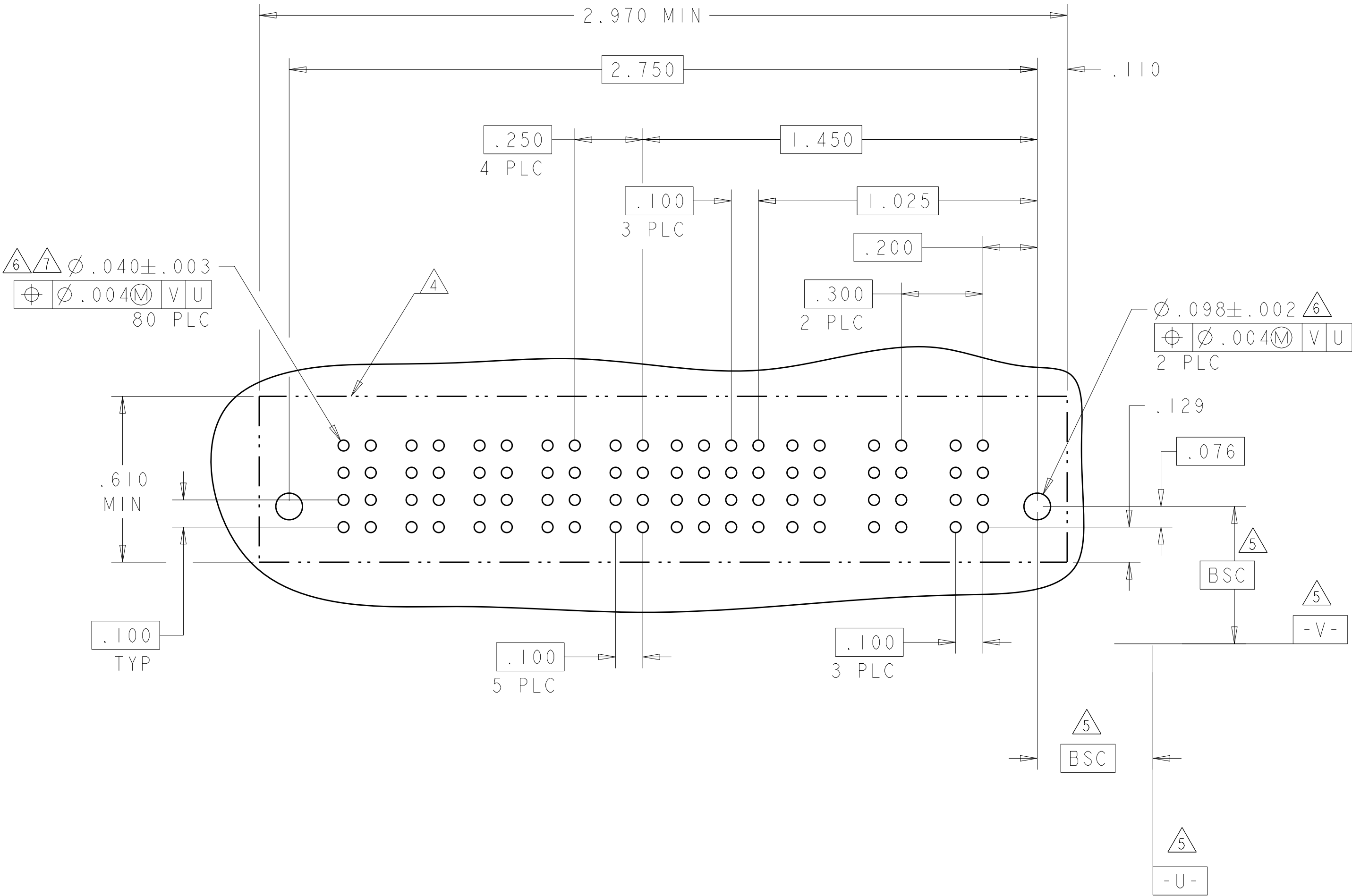

PART NUMBER	ROWS		POWER	SIGNAL		POWER	
			P2	2	1	P1	
1-6450850-7	D		VM	E	E	VM	
	C			E	E		
	B			E	E		
	A			E	E		
IP + 8S + IP							

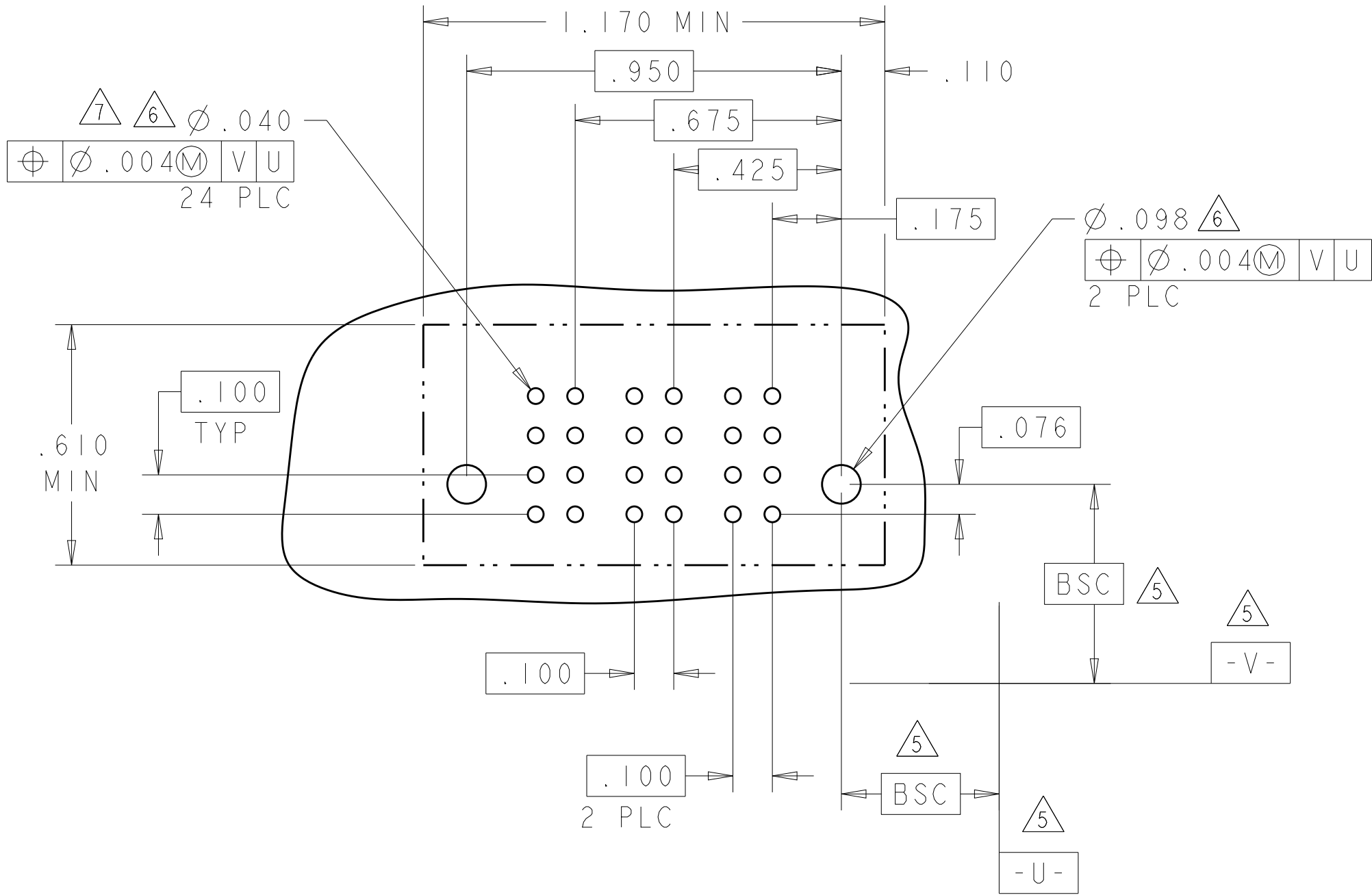

THIS DRAWING IS A CONTROLLED DOCUMENT.

DWN
S.ZHAO
CHK
S.ZHAO
APVD
S.YAO

20SEP2007
20SEP2007
-

DIMENSIONS:
INCHES

0 PLC ±.01
1 PLC ±.01
2 PLC ±.01
3 PLC ±.005
4 PLC ±.0020
ANGLES ±2°
FINISH

TOLERANCES UNLESS OTHERWISE SPECIFIED:

PRODUCT SPEC
108-1973
APPLICATION SPEC
114-13038
WEIGHT
CUSTOMER DRAWING

NAME
VERTICAL RECEPTACLE ASSEMBLY, WITH GUIDES MULTI-BEAM XLE

SIZE
A100779

CAGE CODE
C=6450850

RESTRICTED TO
-

TE Connectivity

SCALE
4:1

SHEET
5

OF
6

REV
D9

-NO CONTACTS LOADED