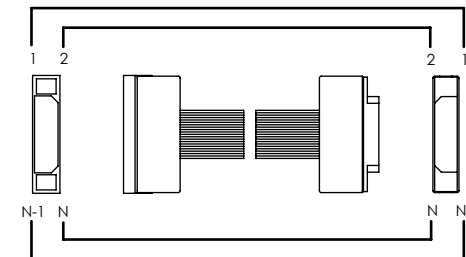
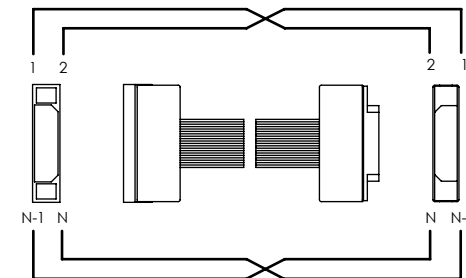
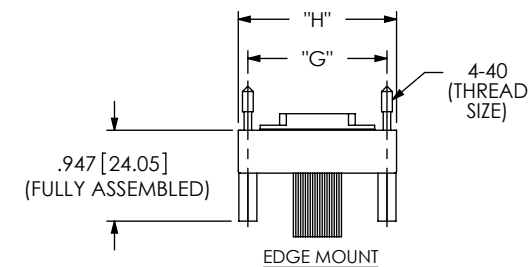

XQXX-XXX-XXXX-SEU-TEU-X-X

ALL DIMENSIONS REF

DO NOT SCALE
FROM THIS PRINT

TABLE 2			
SERIES	"D"	"K"	"L"
EQCD	0.501 [12.73]	0.619 [15.72]	0.775 [19.69]
SQCD	0.625 [15.88]	0.619 [15.72]	0.775 [19.69]
HQCD	0.751 [19.08]	0.619 [15.72]	0.775 [19.69]
EQDP	0.525 [13.34]	0.619 [15.72]	0.775 [19.69]
HQDP	0.800 [20.32]	0.719 [18.26]	0.875 [22.23]
EQSD	0.760 [19.30]	0.619 [15.72]	0.775 [19.69]

WIRING OPTION 1
POSITION 1 TO POSITION 1**WIRING OPTION 2**
POSITION 1 TO POSITION 2**ONLY APPLICABLE FOR SCREW-DOWN END OPTIONS****PROPRIETARY NOTE**

THIS DOCUMENT CONTAINS INFORMATION
CONFIDENTIAL AND PROPRIETARY TO
SAMTEC, INC. AND SHALL NOT BE REPRODUCED
OR TRANSFERRED TO OTHER DOCUMENTS OR
DISCLOSED TO OTHERS OR USED FOR ANY
PURPOSE OTHER THAN THAT WHICH IT WAS
OBTAINED WITHOUT THE EXPRESSED WRITTEN
CONSENT OF SAMTEC, INC.

SHEET SCALE: 1.25:1

520 PARK EAST BLVD, NEW ALBANY, IN 47150
PHONE: 812-944-6733 FAX: 812-948-5047
e-Mail: info@SAMTEC.com code: 55322

DESCRIPTION:
QSX / QTX CABLE ASSEMBLYDWG. NO.
XQXX-XXX-XXXX-SEU-TEU-X-X

BY: BRATCHER 6/20/2003 SHEET 1 OF 1

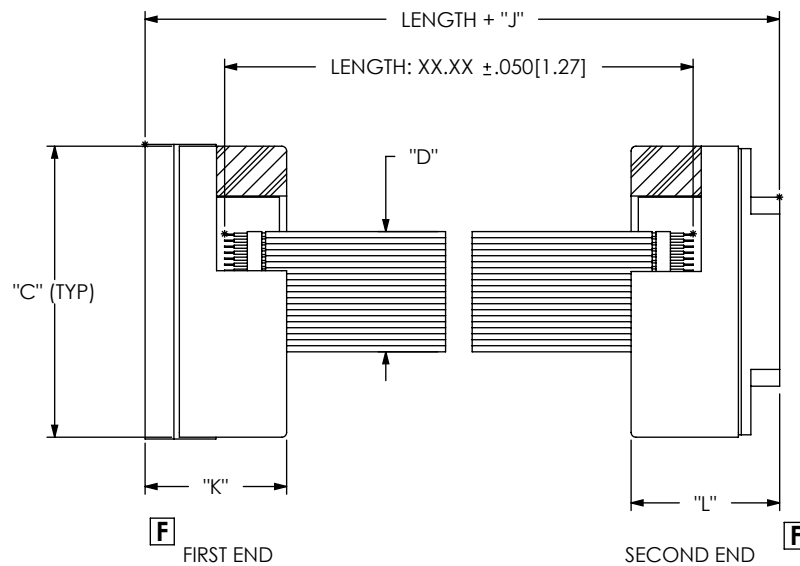
**TABLE 1**

EQCD	SQCD	HQCD	EQDP	HQDP	EQSD	"C"		"J"	
No. OF POSITIONS	No. OF POSITIONS	No. OF POSITIONS	No. OF POSITIONS	No. OF POSITIONS	No. OF POSITIONS				
N/A	N/A	N/A	N/A	N/A	-020	1.213	[30.80]	0.691	[17.55]
N/A	N/A	N/A	N/A	N/A	-040	2.000	[50.80]	0.691	[17.55]
-020	-025	-030	-014	N/A	N/A	1.213	[30.80]	0.691	[17.55]
-040	-050	-060	-028	N/A	N/A	2.000	[50.80]	0.691	[17.55]
-060	-075	-090	-042	N/A	N/A	2.788	[70.80]	0.691	[17.55]
-080	-100	-120	-056	N/A	N/A	3.575	[90.80]	0.691	[17.55]
N/A	N/A	N/A	N/A	-020	N/A	1.515	[38.48]	1.065	[27.05]
N/A	N/A	N/A	N/A	-040	N/A	2.303	[58.50]	1.065	[27.05]
N/A	N/A	N/A	N/A	-060	N/A	3.090	[78.49]	1.065	[27.05]
N/A	N/A	N/A	N/A	-080	N/A	3.878	[98.50]	1.065	[27.05]