

EE-Zone für durchkontaktierte
Löcher $\phi 0.6 \pm 0.05$
compliant zone for through hole
 $\phi 0.6 \pm 0.05$

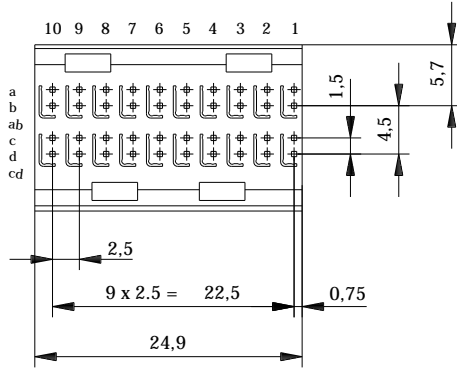

Kontaktversion, Messerkontakt
Contact Option, Male Contact

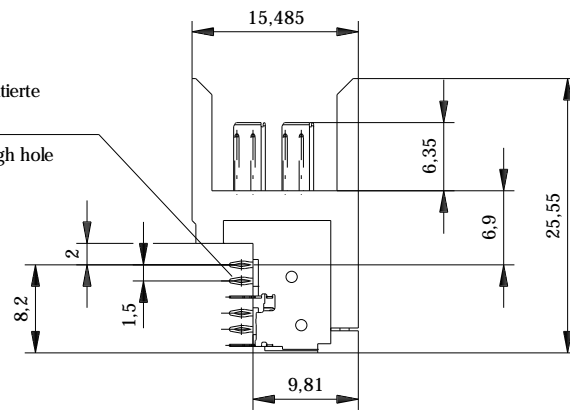
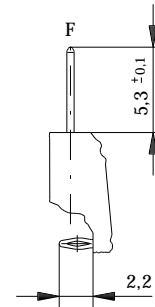

Kontaktversion, Schirmmesser
Contact Option, Shielding Contact

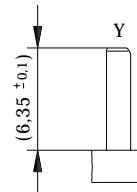

Bestückungsplan - contact layout

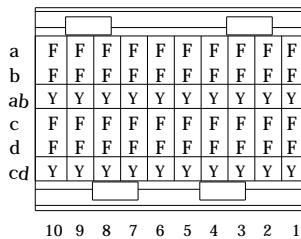

Lochbild für Leiterplatte
(Bestückungsseite)

Board hole pattern
(Component mounting side)

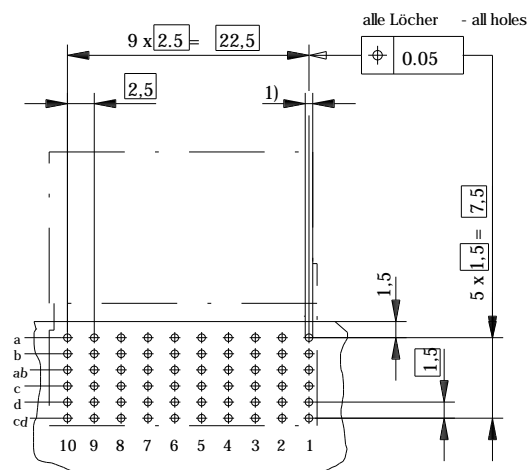

- 1) $\phi 0.6 \pm 0.05$ Durchmesser des metallisierten Loches
 $\phi 0.6 \pm 0.05$ Diameter of finished plated-through hole
- $\phi 0.7 \pm 0.02$ Bohrungsdurchmesser des Loches
 $\phi 0.7 \pm 0.02$ Diameter of drilled hole

Schichtaufbau im metallisierten Loch
siehe Zeichnung 114406

Metal plating of plated-through hole
see drawing 114406

Information: F + Y siehe Bestückungsplan / see contact layout Anforderungsstufe 2 / class 2	Tolerances All Dimensions in mm	Scale	2:1
		Designation ERmetZD Messerleiste abg. 2-10 ERmetZD Male Con. angle 2-10	
All rights reserved. Only for information. To insure that this is the latest version of this drawing, please contact one of the ERNI companies before using.	Subject to modification without prior notice. Drawing will not be updated.	204780	
		www.ERNI.com	I
a Index	29.05.2006 Date	H:00057739.SZA ERMZ D	

Consider protection memo from DFN 34