

REVISION

NOTES:

1. SET UP ASP PART NUMBER FOR INDUSTRY STANDARD.
2. Ⓢ REPRESENTS A CRITICAL DIMENSION.
3. BURR ALLOWANCE: 0.015[.038] MAX.
4. MINIMUM PUSHOUT FORCE: .5 LB.
5. PARTS TO BE PACKAGED IN TAPE AND REEL.

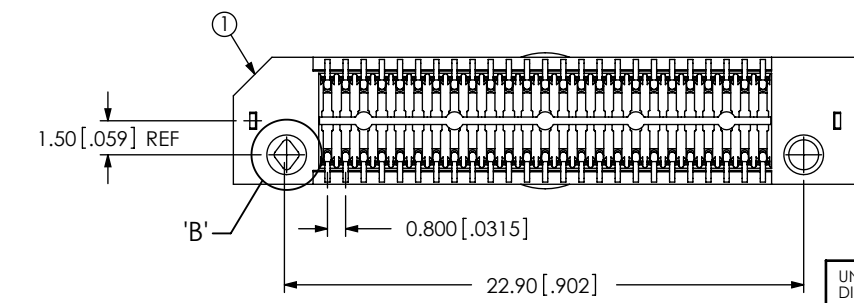
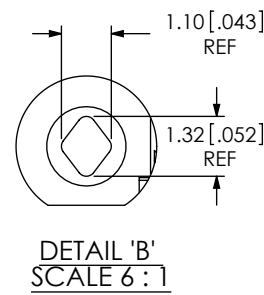
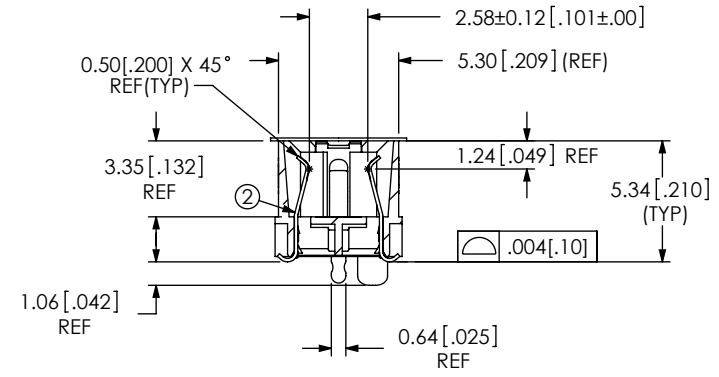
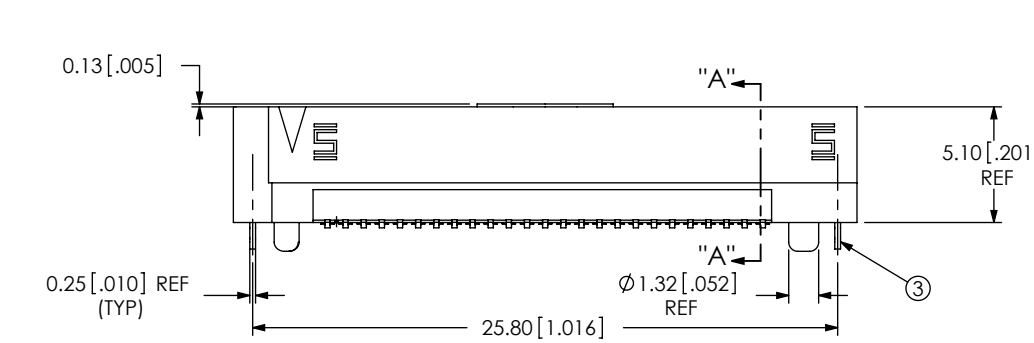
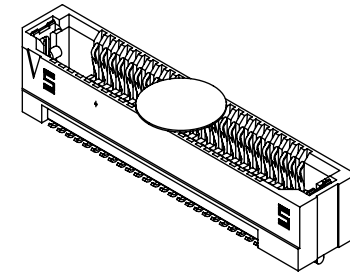
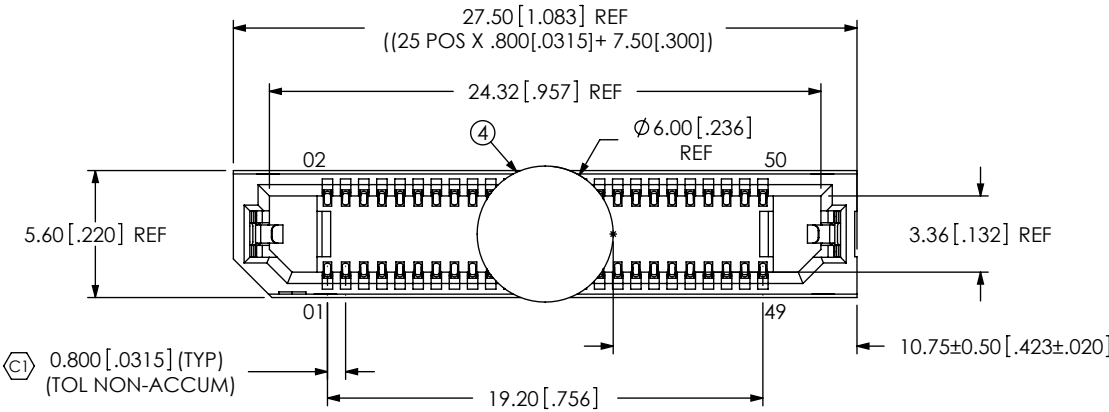

ACCEPTANCE OF DRAWING
 ACCEPTED WITH DEVIATIONS LISTED

DATE: _____
 COMPANY: _____
 CUSTOMER SIGNATURE _____
 PRINTED NAME _____
 PHONE NO: _____
 FAX No: _____

ITEM NO.	PART NUMBER	QUANTITY	MATERIAL
1	ERF8-025-05.0-DV-L	1.0000	VECTRA E130i, COLOR: BLACK
2	C-211-05.0-S	50.000	BeCu, ALLOY 390 HT
3	WT-30-01-F	2.0000	BeCu, #25, 1/2 HT
4	K-500-300	1.0000	POLYIMIDE FILM
5	CT-ERF8016MS	1.0000	CONDUCTIVE POLYMER

UNLESS OTHERWISE SPECIFIED, DIMENSIONS ARE IN MILLIMETERS
 TOLERANCES ARE:
 DECIMALS ANGLES
 .XX: ±.3[.01] 2°
 .XXX: ±.13[.005]
 .XXXX: ±.051[.0020]

PROPRIETARY NOTE
 THIS DOCUMENT CONTAINS INFORMATION CONFIDENTIAL AND PROPRIETARY TO SAMTEC, INC. AND SHALL NOT BE REPRODUCED OR TRANSFERRED TO OTHER DOCUMENTS OR DISCLOSED TO OTHERS OR USED FOR ANY PURPOSE OTHER THAN THAT WHICH IT WAS OBTAINED WITHOUT THE EXPRESSED WRITTEN CONSENT OF SAMTEC, INC.

samtec

520 PARK EAST BLVD, NEW ALBANY, IN 47150
 PHONE: 812-944-6733 FAX: 812-948-5047
 e-Mail info@SAMTEC.com code 55322

DO NOT SCALE DRAWING SHEET SCALE: 1:0.333333

DESCRIPTION:
 .8MM EDGE RATE SOCKET ASM

DWG. NO.
ASP-148422-01

BY: TAMMY W. 06/12/09 SHEET 1 OF 2

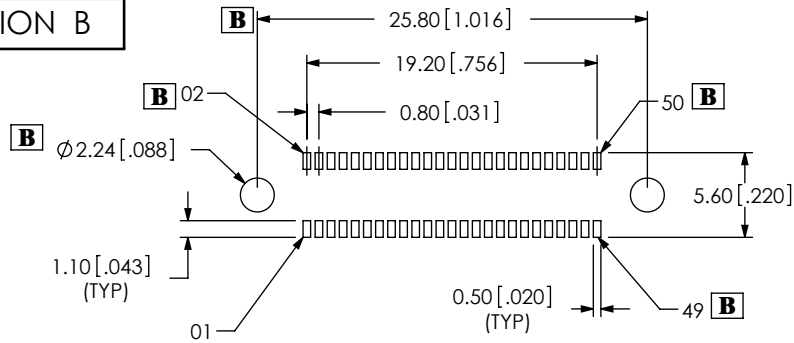

RECOMMENDED STENCIL LAYOUT

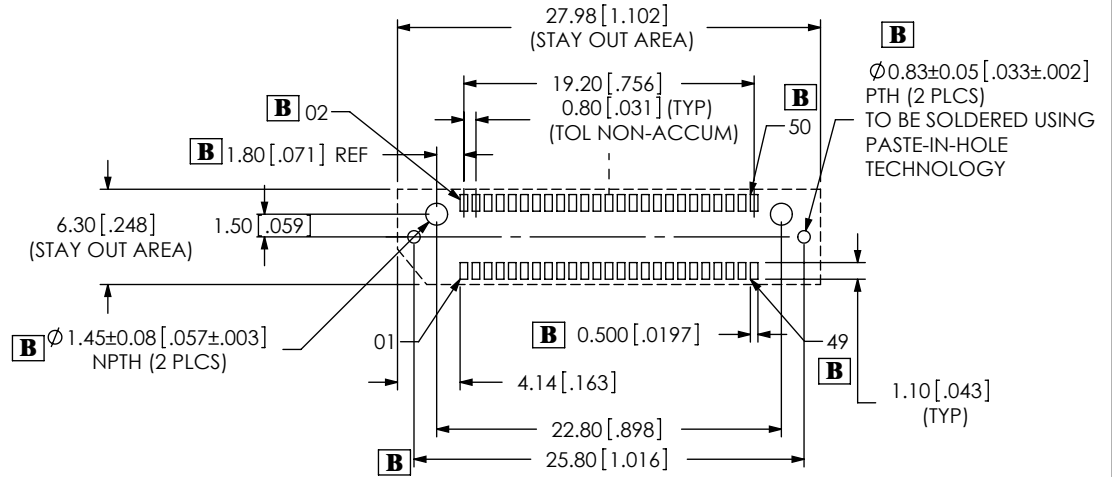

RECOMMENDED PCB LAYOUT

B
 $\varnothing 0.83 \pm 0.05$ [.033 ± .002]
 PTH (2 PLCS)
 TO BE SOLDERED USING
 PASTE-IN-HOLE
 TECHNOLOGY

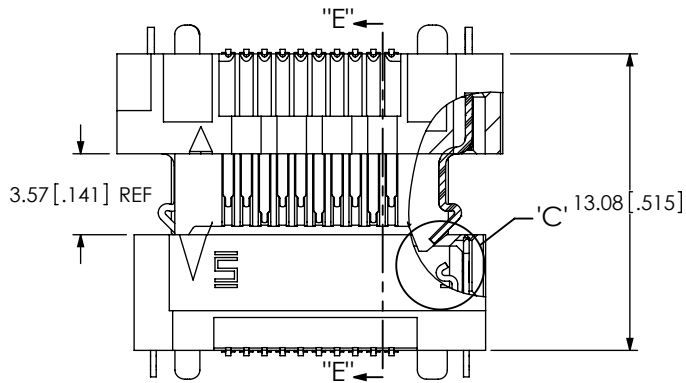

LATCH ENGAGING VIEW

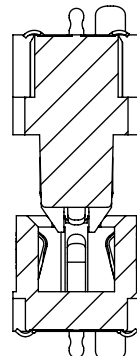

SECTION "E"-"E"
 SCALE 3 : 1

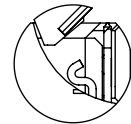

DETAIL 'C'

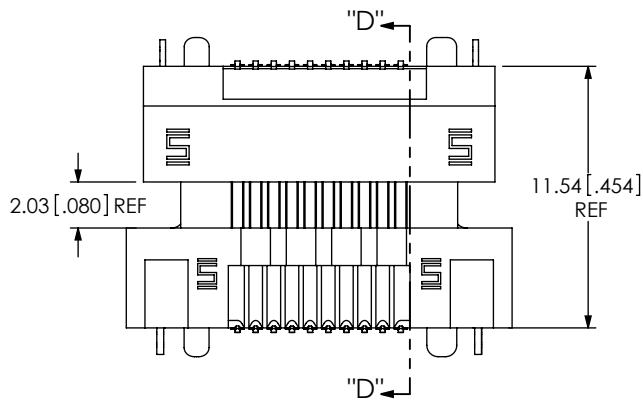

PIN ENGAGING VIEW

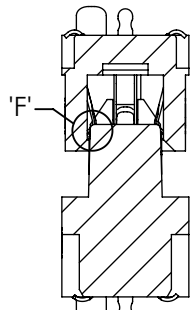

SECTION "D"-"D"
 SCALE 3 : 1

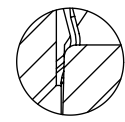

DETAIL 'F'
 SCALE 8 : 1

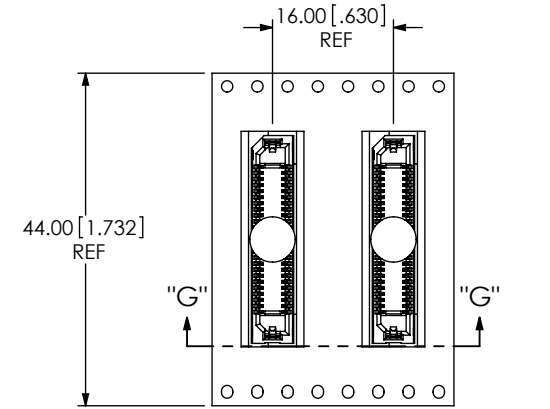

SECTION "G"-"G"
 SCALE 1 : 1

PACKAGING VIEW



520 PARK EAST BLVD, NEW ALBANY, IN 47150
 PHONE: 812-944-6733 FAX: 812-948-5047
 e-Mail info@SAMTEC.com code 53322

PROPRIETARY NOTE

THIS DOCUMENT CONTAINS INFORMATION CONFIDENTIAL AND PROPRIETARY TO SAMTEC, INC. AND SHALL NOT BE REPRODUCED OR TRANSFERRED TO OTHER DOCUMENTS OR DISCLOSED TO OTHERS OR USED FOR ANY PURPOSE OTHER THAN THAT WHICH IT WAS OBTAINED WITHOUT THE EXPRESSED WRITTEN CONSENT OF SAMTEC, INC.

SHEET SCALE: 4:1

DESCRIPTION:

.8MM EDGE RATE SOCKET ASM

DWG. NO.

ASP-148422-01

BY: TAMMY W. 06/12/09

SHEET 2 OF 2