

Vacuum and Absolute Pressure Regulator up to 310 bar

RE

Description

Vacuum pressure regulator with large, effective diaphragm sensing area for quick response, reliable regulation and long service life. Adjustable stop at REV and REA allows outlet pressure to be limited to any value between maximum rated and less than 50% of maximum value.

Media	compressed air or non-corrosive gases	Proof pressure	150% of the max. supply pressure
Adjustment	by black plastic knob, for control panel integration	Relieving function	non-relieving
Gauge port	none, optionally 1/4" NPT for outlet pressure	Mounting position	any

	REV	REA	RD5
Supply pressure	max. 4 bar	max. 310 bar	max. 28 bar
Temperature range	-25 °C to 75 °C / -13 °F to 167 °F		-40 °C to 75 °C / -40 °F to 167 °F
Leakage rate		bubble-tight	outwaRE < 2x10 ⁻⁶ mbar l/s He
Body	brass, optionally nickel-plated aluminium		316 stainless steel
Diaphragm	NBR/Buna-N, optionally EPDM or FKM		316 stainless steel
Valve seat	CTFE		PTFE
Inner valve	stainless steel and brass		316 stainless steel

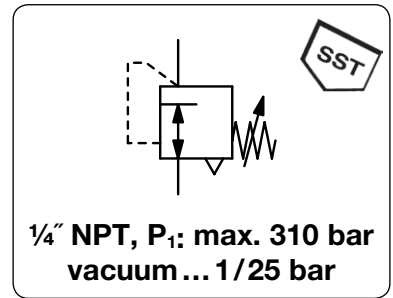

Dimensions			K _v value (m³/h)	Flow rate		Connection thread NPT	Pressure range bar _{abs}	OREer number
A	B	C		m³/h	l/min			

Brass vacuum pressure regulator							supply pressure max. 4 bar, non-relieving	REV
54	124	13	0.21	3*1	50*1	1/4" NPT	0.067 ... 1.0	REV-02A

Brass absolute pressure regulator							supply pressure max. 310 bar, non-relieving	REA
54	124	13	0.05	90*2	1500*2	1/4" NPT	0.067 ... 2.0 0.067 ... 4.5 0.067 ... 8.0 0.067 ... 25	REA-02B REA-02C REA-02D REA-02E

SST absolute pressure regulator							supply pressure max. 28 bar, non-relieving	RD5
58	140	19	0.21	4*3	70*3	1/4" NPT	0.067 ... 1.0	RD5-02S

Special options, add the appropriate letter

aluminium body	nickel-plated	for REV and REA	RE . -02 . A
FKM elastomer		for REV and REA	RE . -02 . V
EPDM elastomer		for REV and REA	RE . -02 . E
gauge port	1/4" NPT at the outlet		RE . -02 . M
brass pressure gauge	for brass body,	outlet side	RE . -02 . MGM
SST pressure gauge	for stainless steel body,	outlet side	RE . -02 . MG

Accessories, enclosed

mounting nut made of stainless steel, for panel mounting **M50x1,5S6**

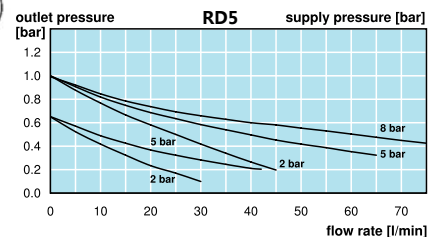
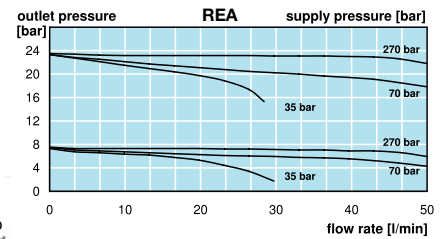
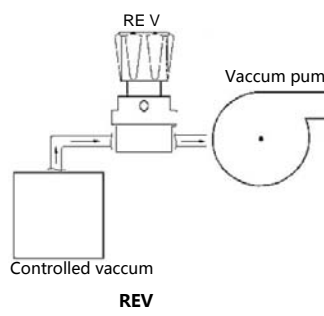
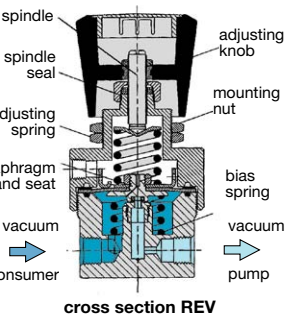
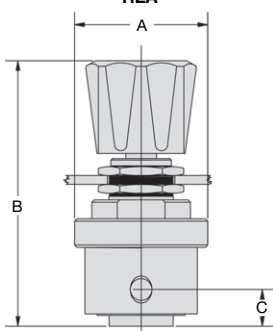
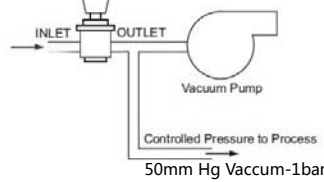
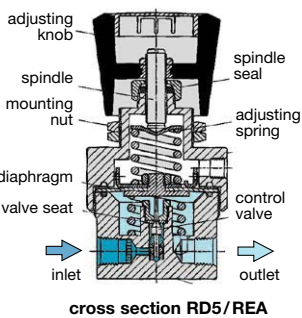
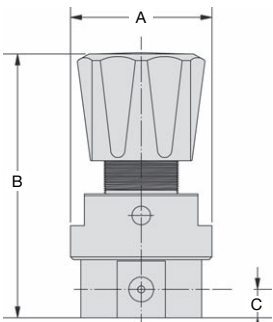

*1 at 3 bar supply pressure and 1 bar outlet pressure
*2 at 270 bar supply pressure and 25 bar outlet pressure

*3 at 5 bar supply pressure and 1 bar outlet pressure

