

# Quick Connector Series for high purity chemicals



We suggest total solution of chemicals transportation that customer will be satisfied with. The ultimate connector, which enables to prevent liquid leaking, has made Quick connector increased safety. You can choose the one from various types of Quick connectors according to containers used for chemicals depending on their usage and purpose.

**● Caution**

- Please acknowledge that product might be different from photograph on the catalog.
- The data described in the catalog is a reference value, not a guarantee value.
- It is likely to crack or split depending on chemicals, so please carefully select material or please contact us.

**Applications**

- High purity chemical container for semiconductor and liquid crystal
- Semiconductor manufacturing equipment
- Plastic drum for chemical supply
- Biochemical
- Nanotechnology
- Medical device
- Environmental equipment
- Chemical supply system

**Features**

- Quick connector can be furnished on a variety of containers such as small container, tank lorry and ISO container, and so on. Besides, the connector can make chemical supply stable.
- There is a option of body materials such as fluorine resin and polyethylene to meet cost and applications.



## Total coordinate

### AUTO CONNECTOR | AQC

Auto connector Model AQC has been developed to supply chemicals with safety and cleanness when high purity chemicals are supplied to semiconductor and FPD factory.

- Features**
- Safety** : Easy, No-touch chemicals.
  - Clean** : Washing and drying by Surpass original Eddy-cyclone method.
  - Preventing of miss-connection** : Preventing of miss-connection system by key-groove is available.
  - Compact** : Compact design for easy-to-use
  - Variation** : 25A~50A size, Organic and strong acid available.
  - Operation** : Possible to supply by one button.

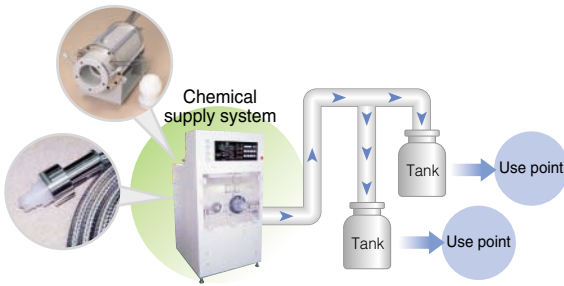

### PUSH DOWN CONNECTOR | PDC

**For link** PDC Push-Down Connector is a handy connector used to transfer high purity EL chemicals. It is designed for containers with the capacity of 200 ℓ, which are commonly used in the semiconductor industry.

- Features**
- The new mechanism developed specially for PDC is implemented, which eliminates liquid drop when detaching the connector.
  - The auto-stop valve, which minimized interfusion of foreign particles, is deployed to facilitate the attaching/detaching of the connector.
  - Surpass original "Super one-touch method" enables the connection of the PDC connector by one single push.
  - Surpass original key-type and dimension systems are implemented to allow the socket to be connected only to its corresponding plug to prevent wrong types of chemicals from getting into.

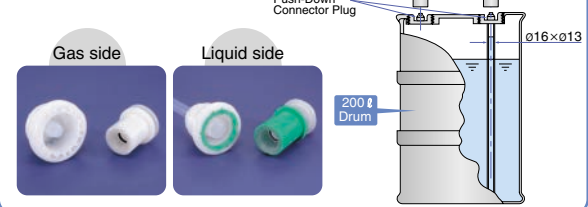

#### Chemical factory

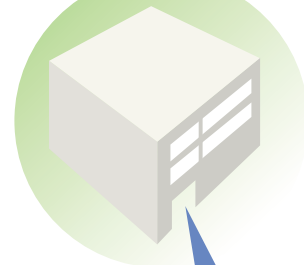

#### Semiconductor factory



### TAKUMI CONNECTOR | TKM

TKM connector is a new manual type connector to be implemented PDC new structure.

- Features**
- Auto-stop valve is used, so it has excellent seal performance.
  - The new mechanism is implemented, which eliminates liquid drop when detaching the connector.
  - Surpass original "Super one-touch method" enables the connection of the TKM connector by one single push.

#### Prevention of liquid drop type



### USE-ONE CONNECTOR | USE-ONE

**For One-way** USE-one connector is used for chemicals in general industry and semiconductor / liquid crystal market. It is designed for plastic drum with capacity of 200 ℓ to export and to provide lower-cost.

- Features**
- Siphon tube is integrated into the connector, facilitating installation.
  - The connector is designed for simple structure such as no-moving part or no excess parts on it.
  - One-touch connection method can make operation facilitate.
  - Connection-error prevention type which prevents wrong types of chemicals from getting mixed, is provided.
  - The mechanism to prevent liquid spouting is provided, ensuring safety although no valve simple structure.
  - The connector is PE molded product.
  - Socket on fluid side has a prevention mechanism of liquid leakage.

#### Prevention of liquid drop type

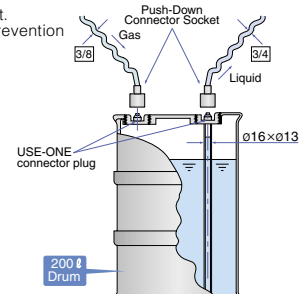

Model selection Table

	Model	Size	Body material	Feature/General	Reference application	Connection type	Preventing miss-connection structure	Page
For high purity chemicals	QCH	3/8~40A	PCTFE	Multipurpose connector	For pressurized container 100ℓ, 200ℓ, 1m <sup>3</sup> , 2m <sup>3</sup> Lorry, ISO container	Pull sleeve	Contact us	15, 16, 17
	QC4F	1/2, 3/4	PTFE	No compatibility with other connectors	For pressurized container 100ℓ, 200ℓ, 1m <sup>3</sup> , 2m <sup>3</sup>	Pull sleeve	Non available	18
	TKM	1/2, 3/4	PCTFE	Prevention of liquid drop	For pressurized container 100ℓ, 200ℓ	One-touch	Available	10, 11
	TKM6F	3/8, 3/4	PFA	Prevention of liquid drop	For pressurized container 100ℓ, 200ℓ	One-touch	Available	10
	TKM-BPF	equiv. 3/8	PFA	Prevention of liquid drop for compact bottle	For pressurized container 15ℓ, 18ℓ	One-touch	Available	12, 13
	TKM-BQ4F	equiv. 3/8	PTFE		For pressurized container 15ℓ, 18ℓ	One-touch	Available	12, 13
	BQC	equiv. 3/8	PCTFE	Multipurpose connector for compact bottle	For pressurized container 15ℓ, 18ℓ	Pull sleeve	Non available	14
	BPF	equiv. 3/8	PFA		For pressurized container 15ℓ, 18ℓ	Pull sleeve	Non available	14
	BQ4F	equiv. 3/8	PTFE		For pressurized container 15ℓ, 18ℓ	Pull sleeve	Non available	14
	PDC	1/2, 3/4	PFA (PCTFE)	Prevention of liquid drop For link	For pump up 100ℓ, 200ℓ power drum	One-touch	Available	8, 9
	AQC	25A~50A	Fluorine resin	With safety lock With washing & drying function Sus-made Auto connector available	For pressurized container 1m <sup>3</sup> , 2m <sup>3</sup> . Lorry, ISO container	One-touch	Available	22, 23
	ELS	25A~50A		Auto system unit installed AQC	For pressurized container 1m <sup>3</sup> , 2m <sup>3</sup> . Lorry, ISO container	One-touch	Available	26
	S-SE-QCH	40A~50A		Air-drive method that makes connection easy	For pressurized container 1m <sup>3</sup> , 2m <sup>3</sup> . Lorry, ISO container	One-touch	Available	27
For pure water	QCL	1/4	PCTFE	Compact type	Hand shower etc for semiconductor system	Pull sleeve	Non available	19
	MQC	1/4, 3/8	PTFE	Compact, One-touch, Low cost	Hand shower etc for semiconductor system	One-touch	Non available	21
	QCP	3/8~1/2	PP	Low cost	Hand shower etc for semiconductor system	Pull sleeve	Non available	20
For general chemicals	USE	equiv. 3/4	HDPE (Plug side)	For one-way PE molded and low cost No-valve and prevention liquid drop type Re-circulation type available	For pump up 100ℓ, 200ℓ drum	One-touch	Available	3, 4, 5, 6
	IBC-USE			One-touch method connection Low cost Chemicals pulled out vertically	For pump up IBC power tote, 1000ℓ container	One-touch	Non available	7







# Model USE One-way PE Connector <For plastic drum>

## Features

- No-moving part and simple structure due to one piece of molded structure.
- USE plug can be easy to connect to drum.
- Prevention of liquid spouting available.
- Connection-error prevention type with key-groove available.
- Low cost and short lead time due to mass production.
- One-touch method connection makes operation facilitate.
- Adopted prevention of liquid drop when detaching.

\* Caution : Please handle PE with care, because PE may have cracks or breaks against surface-active agent.

USE connector has 3 kinds of socket and 4 kinds of plug, so it is possible to make connection in various way according to your purpose.

	Socket on system side (Optional cap available)	Plug on drum side (With cap)
Socket for liquid	 <p>Name : Separate type socket for liquid Feature : Connection-error prevention with key-groove is provided.</p> <p>Specifications :                      Pressure ▶ 250kPa                      Temperature range ▶ 5~60°C                      Connection size ▶ NPT 3/4                      Wetted parts ▶ USE6F : PFA, Karlez®                      USEPE : HDPE, PFA, Various types of O-ring</p> <p>Ordering Information :  <b>USE</b> <input type="checkbox"/> - <b>S</b> - <input type="checkbox"/> - <input type="checkbox"/></p> <p>6F : PFA                      PE : HDPE</p> <p>▶ Key groove number                      09                      07                      08                      15                      16</p> <p>* O-ring / USEPE only                      V : FKM                      E : EPDM                      * O-ring for Model USE6F is Karlez®.</p> <p>* Please contact us for the other Key groove number.</p>	 <p>Name : Separate type plug for liquid Features : • Connection-error prevention with key-groove is provided. • Simple structure as tube is integrated into plug. • The mechanism to prevent liquid spouting is provided.</p> <p>Material : HDPE, Various types of O-ring</p> <p>Ordering Information :  <b>USE-P-L</b> - <input type="checkbox"/> - <input type="checkbox"/></p> <p>▶ Key groove number 09                      07                      08                      15                      16</p> <p>▶ O-ring material                      Non : FKM                      E : EPDM                      PE : PE</p>
Socket for liquid & gas	 <p>Name : • Re-circulation type socket (for liquid reverse and gas) • One-port socket (for liquid and gas) Feature : Supply by one port due to having flow channel for liquid and gas.</p> <p>Specifications :                      Pressure ▶ 250kPa                      Temperature range ▶ 5~60°C                      Connection size ▶ Liquid side : NPT 3/4                      ▶ Gas side : USE6F                      Flowell 60 series 1/4                      USEPE                      NPT 1/8                      Wetted parts ▶ USE6F : PFA, Karlez®                      USEPE : HDPE, Various types of O-ring</p> <p>Ordering Information :  <b>USE</b> <input type="checkbox"/> - <b>SGR</b> - <input type="checkbox"/></p> <p>6F : PFA                      PE : HDPE</p> <p>* O-ring / USEPE only                      V : FKM                      E : EPDM                      * O-ring for Model USE6F is Karlez®.</p>	 <p>Name : One-port type plug (for liquid and gas) Feature : Supply by one port due to having flow channel for liquid and gas.</p> <p>Material : HDPE, Various types of O-ring</p> <p>Ordering Information :  <b>USE-P-L</b> - <input type="checkbox"/></p> <p>▶ O-ring material                      Non : FKM                      E : EPDM                      PE : PE</p>
Socket for gas	 <p>Name : Separate type socket for gas Feature : One-touch connection method</p> <p>Specifications :                      Pressure ▶ 250kPa                      Temperature range ▶ 5~60°C                      Connection size ▶ NPT 3/8                      Wetted parts ▶ PFA·FEP</p> <p>Ordering Information :  <b>PDC6F-S-G</b></p>	 <p>Name : Separate type plug for gas</p> <p>Ordering Information :  <b>USE-P-G</b> - <input type="checkbox"/></p> <p>▶ O-ring material                      Non : FKM                      E : EPDM                      PE : PE</p> <p>Material : HDPE, Various types of O-ring</p>
Plug for liquid reverse	 <p>Name : Re-circulation type plug for liquid reverse and gas</p> <p>Ordering Information :  <b>USE-6P-G</b> - <input type="checkbox"/></p> <p>▶ O-ring material                      Non : FKM                      E : EPDM                      PE : PE</p> <p>Material : HDPE, Various types of O-ring</p>	

### Reference example USE separate type

<The following pattern : Key groove No.09, O-ring : FKM>

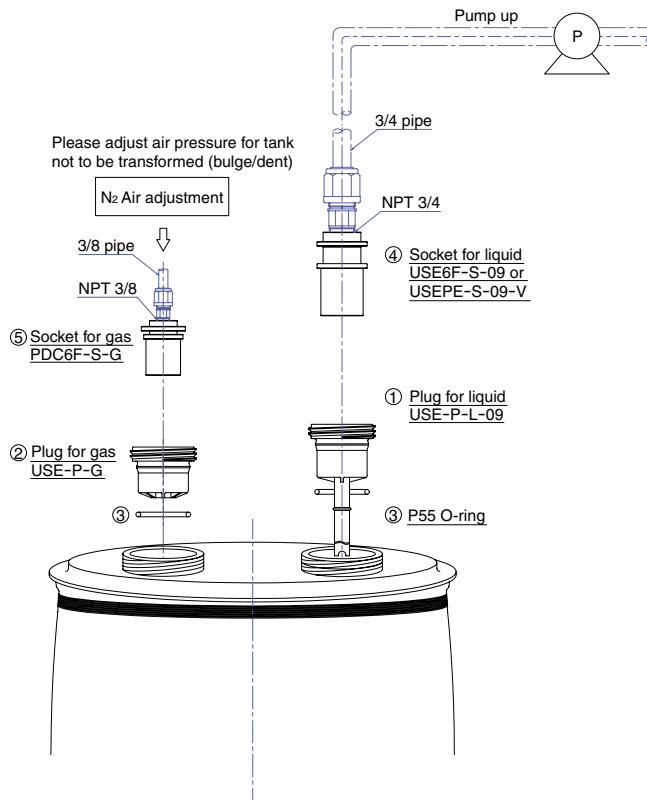

● Connection-error prevention mechanism with key groove

Key groove No.	Key groove position	Key groove No.	Key groove position
09	180°	15	230°
07	110°	16	210°
08	160°		

● List of jigs used

PDC-AIN	Mounting the bracket to the drum Removing the bracket from the drum
USE-TOOL	Attaching the cap to the bracket-embedded plug Removing the cap from the bracket-embedded plug



### Ordering Information

● Plug for liquid

**USE-P-L-** [ ] - [ ]

→ O-ring material Non : FKM  
E : EPDM  
PE : PE  
→ Key groove number 09  
07  
08  
15  
16

● Plug for gas

**USE-P-G-** [ ]

→ O-ring material Non : FKM  
E : EPDM  
PE : PE

● Socket for liquid

**USE** [ ] - **S-** [ ] - [ ]

\* O-ring / USEPE only  
V : FKM  
E : EPDM \* O-ring of USE6F is Karlez®

→ Key groove number 09  
07  
08  
15  
16  
→ Body material 6F : PFA  
PE : HDPE

● Socket for gas

**PDC6F-S-G**

→ Body material 6F : PFA

### Dimensions

● For gas

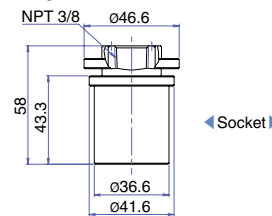

● For liquid

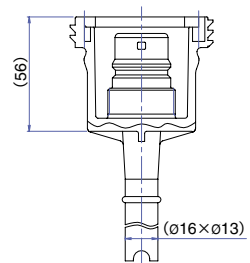
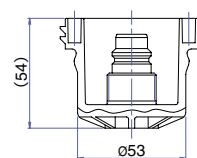
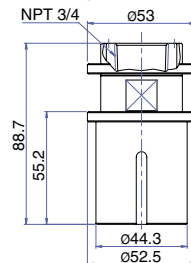

# Model USE One-way PE Connector <For plastic drum>

## Reference example USE One-port type

<The following pattern : O-ring : FKM>

Feature : The chemicals are supplied by one set of plug and socket using USE□-SGR type.

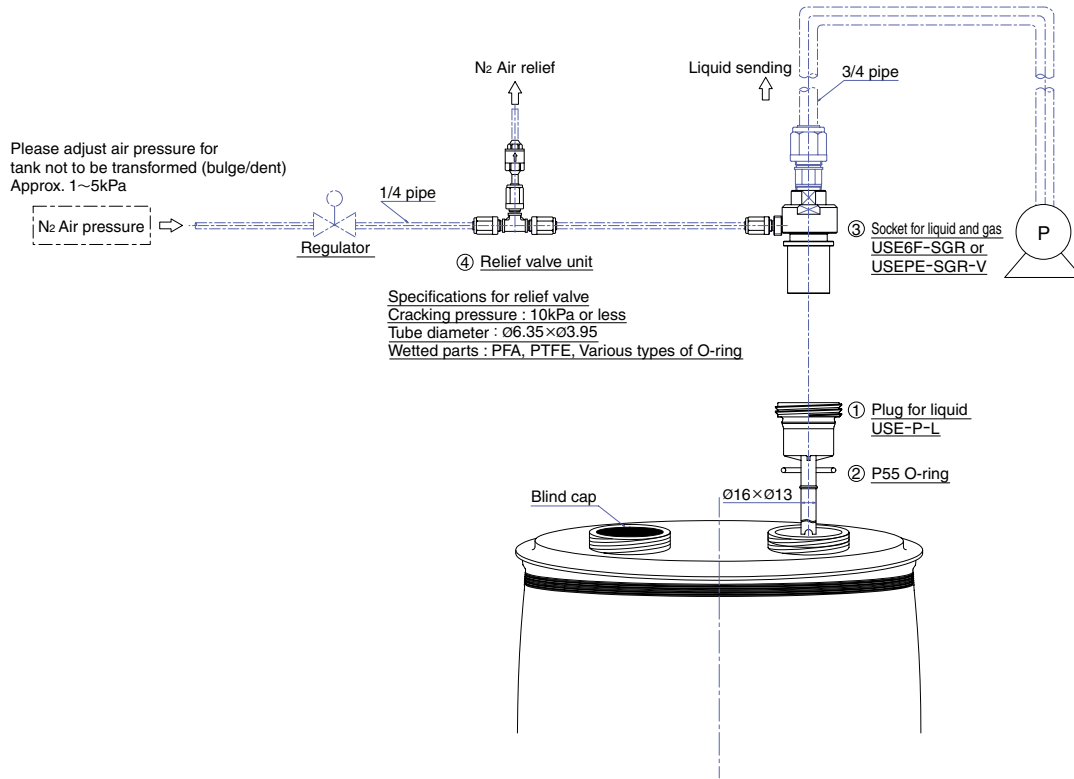

\* ④ Relief valve unit is optional.

\* Jigs used for this connector are the same as USE separate type use.

## Ordering Information

### ● Plug

**USE-P-L-□**

▶ O-ring material Non : FKM  
E : EPDM  
PE : PE

### ● Socket

**USE-□-SGR-□**

\* O-ring / USEPE only  
V : FKM  
E : EPDM

▶ Body material 6F : PFA  
PE : HDPE

## Dimensions

### ● USE6F-SGR

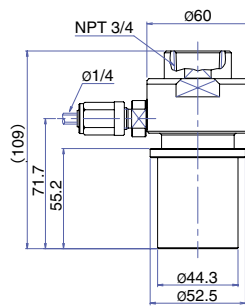

### ● USEPE-SGR

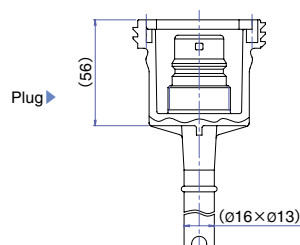
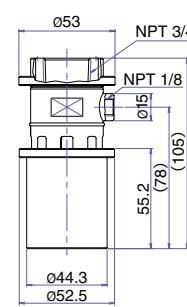

### Reference example Re-circulation type

<The following pattern : Key groove No.09, O-ring : FKM>

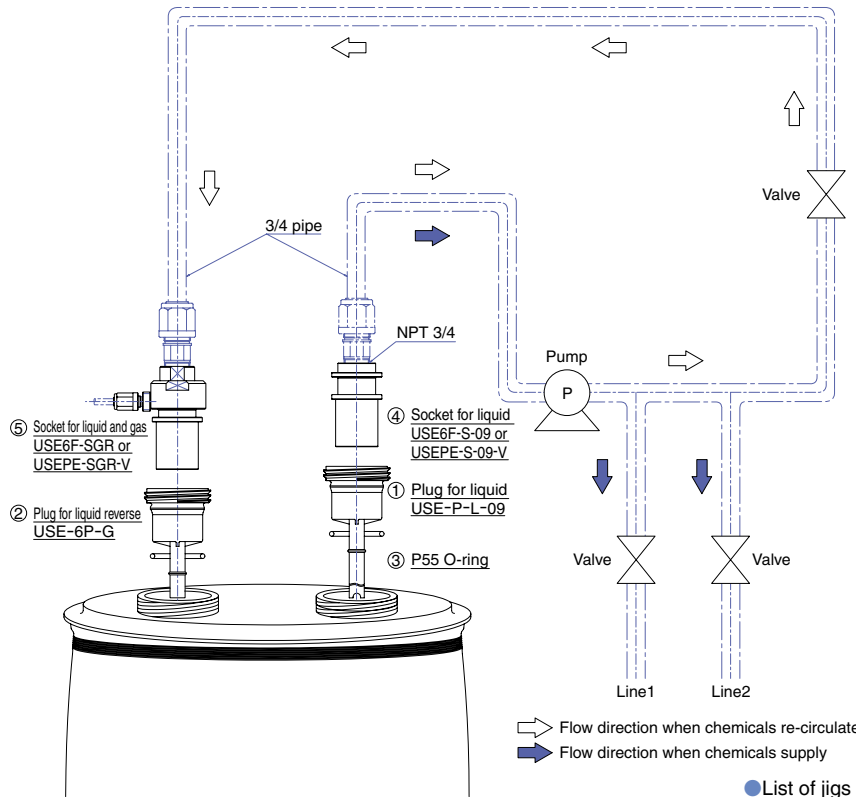

● Connection-error prevention mechanism with key groove

Key groove No.	Key groove position
09	
07	
08	
15	
16	

● List of jigs used

PDC-AIN	Mounting the bracket to the drum Removing the bracket from the drum Mounting & removing the cap
USE-TOOL	Mounting the bracket to the drum Attaching the cap to the bracket-embedded plug

### Ordering Information

● Plug for liquid

**USE-P-L-**

→ O-ring material Non : FKM  
E : EPDM  
PE : PE

→ Key groove number 09 07  
08 15  
16

● Plug for liquid reverse

**USE-6P-G-**

→ O-ring material Non : FKM  
E : EPDM  
PE : PE

● Socket for liquid

**USE-**

\* O-ring / USEPE only  
V : FKM  
E : EPDM

→ Key groove number 09 07  
08 15  
16

→ Body material 6F : PFA  
PE : HDPE

● Socket for liquid and gas

**USE-**

\* O-ring / USEPE only  
V : FKM  
E : EPDM

→ Body material 6F : PFA  
PE : HDPE

### Dimensions

● Socket for liquid and gas

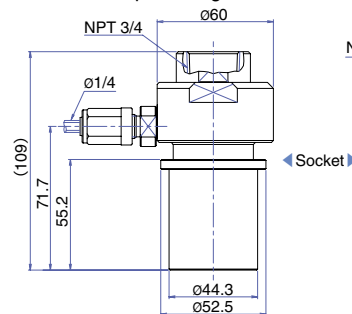

● Socket for liquid

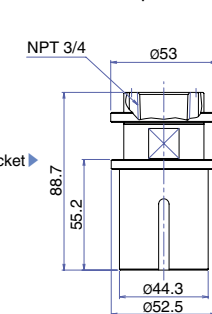

● Plug for liquid reverse

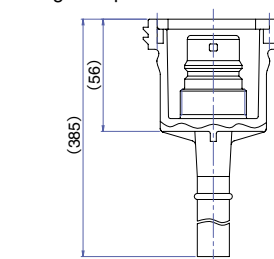

● Plug for liquid

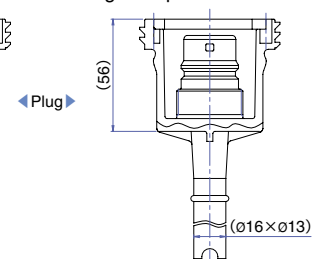

# Model IBC-USE One-touch Connector For Power tote / For One-way



IBC-USE



### Features

- One-touch connection method can facilitate to release liquid.
- This connector can prevent liquid drop when detaching.
- Chemicals can be pulled out vertically.
- Dust-proof cap comes with the connector as accessory and is usable as it is.

### Ordering Information

- Container side Plug for liquid

**IBC-USE-P-**



▶ O-ring material  
Non : FKM  
E : EPDM

- System side Socket for liquid and gas

**USE-GR-**



\* O-ring / USEPE only  
V : FKM  
E : EPDM  
▶ Body material 6F : PFA  
PE : HDPE

### Reference example Model IBC-USE connector for power tote

<The following pattern : O-ring : FKM>

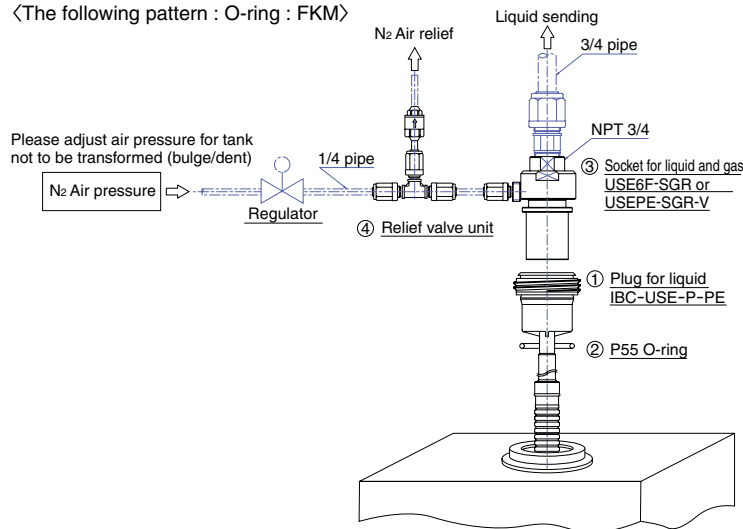

### Specifications

	Plug for liquid	Socket for liquid and gas	
		USE6F	USEPE
Temperature range	5~60°C		
Body material	HDPE	PFA	HDPE
O-ring	FKM or EPDM	Karlez® FEP Jacket	FKM or EPDM
Connection size	—	Liquid	NPT 3/4
		Gas	Flowell 60series 1/4
			NPT 1/8

### List of jigs used

PDC-AIN	Mounting the bracket to the drum Removing the bracket from the drum
USE-TOOL	Attaching the cap to the bracket-embedded plug Removing the cap from the bracket-embedded plug

### Dimensions

- IBC-USE-P

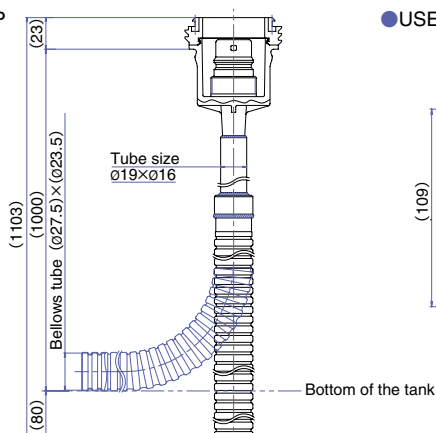

- USE6F-SGR

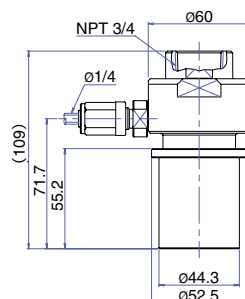

- USEPE-SGR

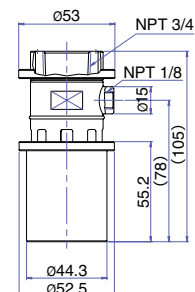



# Model PDC Push-Down Connector

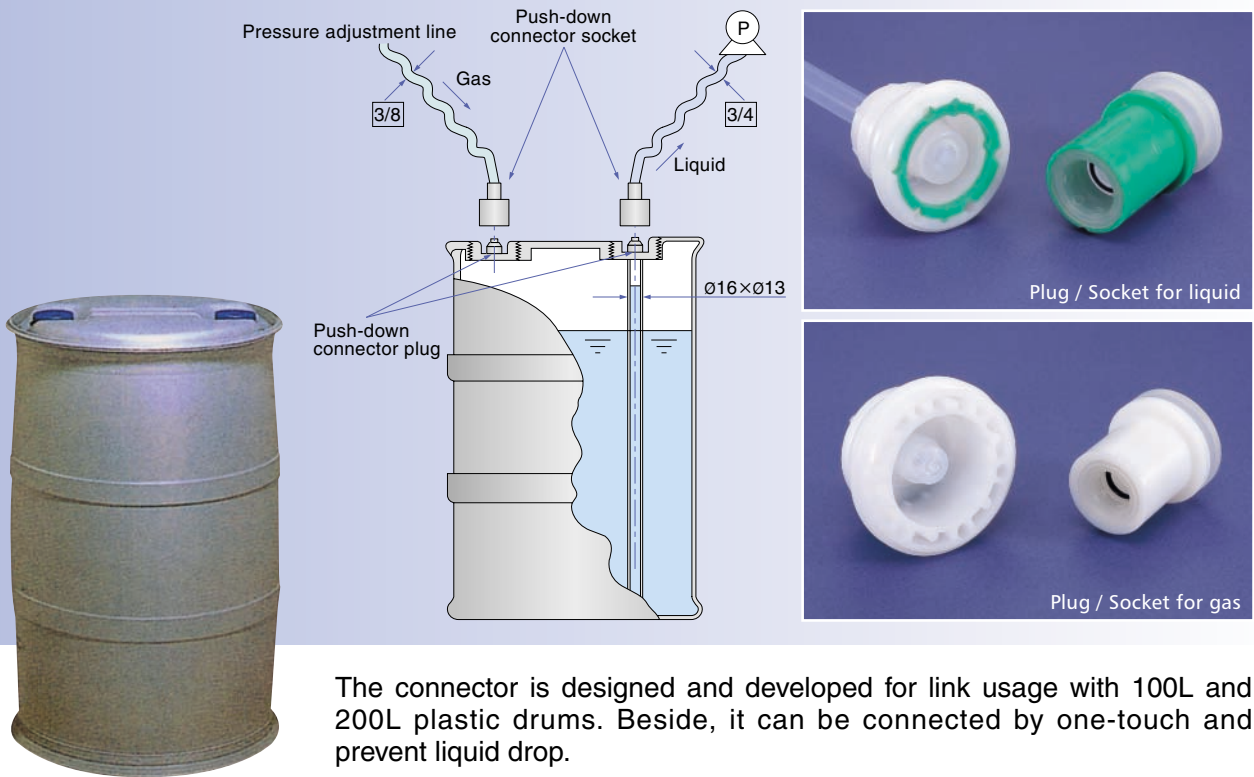

The connector is designed and developed for link usage with 100L and 200L plastic drums. Beside, it can be connected by one-touch and prevent liquid drop.

## Reference example

<The following pattern : Plug type : A, Key groove No.09, O-ring : FKM>

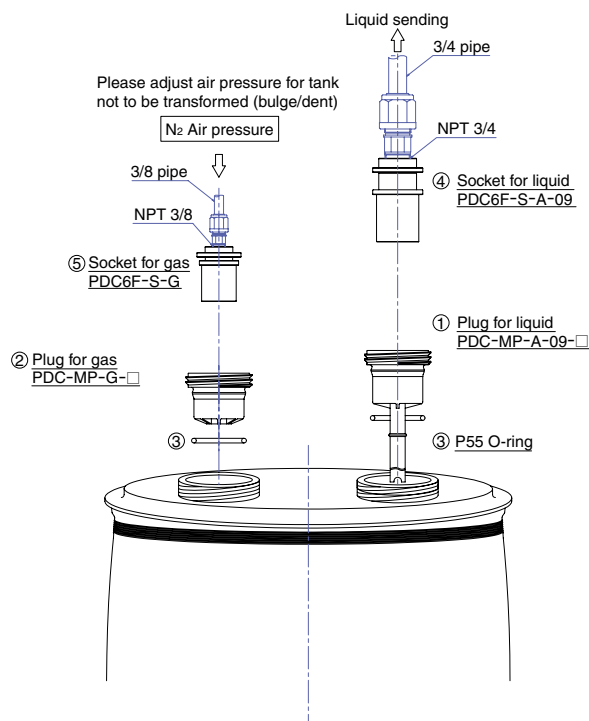

### ● Connection-error prevention mechanism with key-groove

Key groove No.	Key groove position	Key groove No.	Key groove position
04	80°	09	180°
05	100°	13	270°
06	120°	14	250°
07	140°	15	230°
08	160°	16	210°

### ● List of jigs used

Model	Applications
PDC-AIN	Mounting the bracket to the drum Removing the bracket from the drum

# Model PDC Push-Down Connector

## Features

- Surpass original key-type and dimension systems are implemented to prevent miss-connection for each chemicals and each connectors.
- Adopted prevention liquid drop mechanism when detaching the connector.
- Auto stop valve makes air sealing excellent.
- Surpass original 'Super one touch method' enables the connection of the PDC connector by one-touch.

## Specifications

Operating pressure	Max.250kPa
Operating temperature	5~60°C
Wetted parts	<ul style="list-style-type: none"> <li>PDC : PCTFE, PFA, PTFE, HDPE, Various types of O-ring</li> <li>PDC6F : PFA, PTFE, HDPE, Various types of O-ring</li> </ul>

## Flow rate

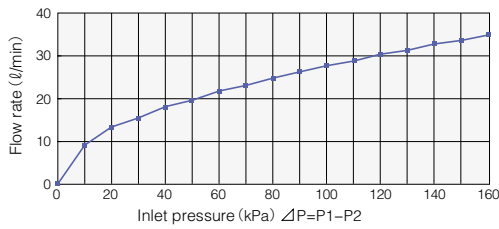

\* The above data is a reference value, not a guarantee value.

## Residual liquid measure when detaching socket and plug

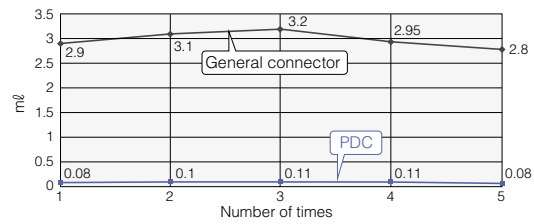

## Ordering Information

- Drum side Plug for liquid (Plug body PFA molded) (with cap)

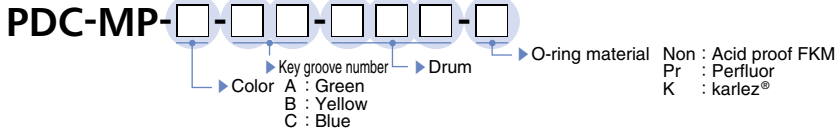

- Drum side Plug for gas (with cap)

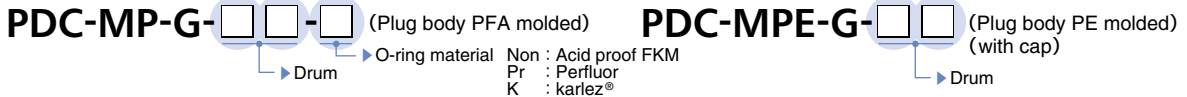

- Socket for liquid (Optional cap available)

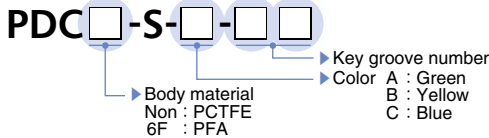

- Socket for gas (Optional cap available)

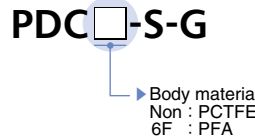

- Jig

**PDC-AIN**

\* Please select body material to be proper for operating chemicals.

## Dimensions

- For gas

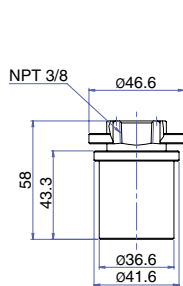

- For liquid

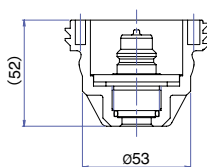
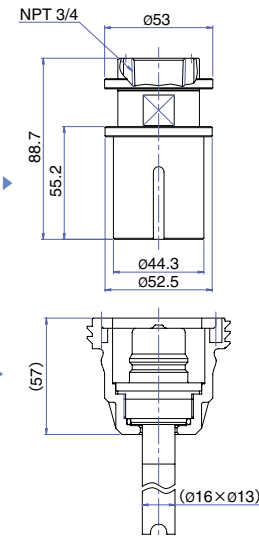

## Connection-error prevention mechanism



- Details of key groove types

Type A × 16 kinds	Connection-error prevention mechanism using key groove
Type B × 16 kinds	Connection-error prevention mechanism using key groove
Type C × 16 kinds	Connection-error prevention mechanism using key groove

\* Caution : Surpass Industry Co.,Ltd. shall have no liability for the chemicals corresponding to the key grooves.

# Model TKM6F PFA-made Prevention of Liquid drop Connector



### Features

- It is able to prevent liquid drop when detaching plug and socket. (Residual liquid : 0.1cc)  
\* Please refer to Model PDC "Residual liquid measure when detaching socket and plug."
- One-touch connection method can facilitate operation.

### Specifications

Operating temperature range	5~70°C
Connection size	PT3/8, PT3/4
Wetted parts	PFA, PTFE, Perfluor O-ring

### Ordering Information

● Plug

**TKM6F-P**

→ Connection size 3 : PT 3/8  
6 : PT 3/4

● Socket

**TKM6F-6S-Pr**

O-ring material : Perfluor  
Connection size : PT 3/4

**TKM6F-3S**

→ Connection size : PT 3/8 \* FEP Jacket O-ring

\* Plug is O-ring less.  
The combination of TKM6F-3P and TKM6F-3S does not have function for prevention of liquid drop.  
The way of connection is as same as the other TKM model due to one-touch connection method.

### Flow rate

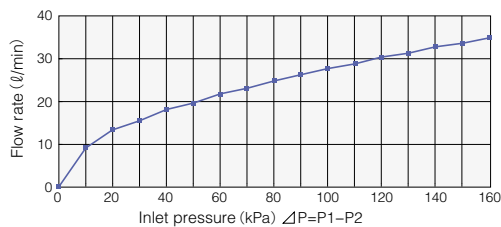

\* The data described in the catalog is a reference value, not a guarantee value.

### Residual liquid measure when detaching socket and plug

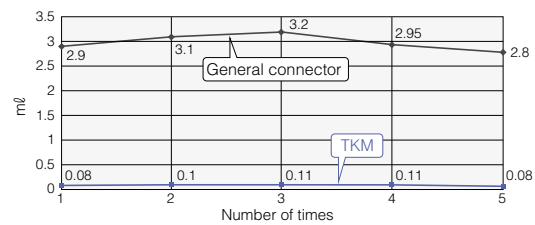

### Dimensions

● Plug

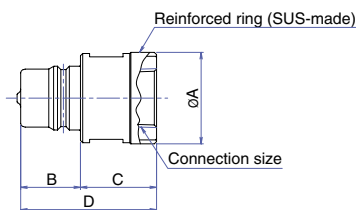

Model	øA	B	C	D	Connection size	Width across flats
TKM6F-3P	30	19	22.6	41.6	PT 3/8	26
TKM6F-6P	40	26.8	34.1	60.9	PT 3/4	37

● Socket

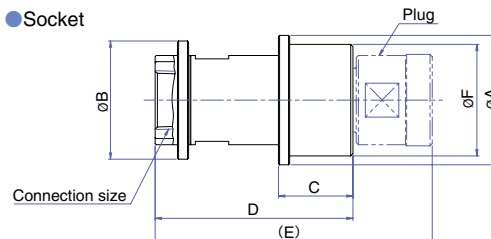

Model	øA	øB	C	D	(E)	øF	Connection size	Width across flats
TKM6F-3S	41.6	46.6	43.3	58	81	36.6	PT 3/8	41
TKM6F-6S-Pr	58	53	34	89.3	123.4	50	PT 3/4	37

# Model TKM PCTFE-made Prevention of liquid drop connector - 1/2 size only -

### Ordering Information

● Plug

**TKM-4P**

→ Connection size : PT 1/2

● Socket

**TKM-4S-Pr**

O-ring material : Perfluor  
Connection size : PT 1/2

\* Body material is PCTFE-made.  
Please carefully use it according to type of chemicals.

## Model TKM Prevention of Liquid drop Connector / Direct-mounted Pressurized Container type

### Model TKM-36MP One-port type



#### Ordering Information

**TKM-36MP-□-□-KM**

▶ O-ring material  
P : Perfluor  
E : EPDM

▶ Container  
100 : For 100ℓ  
200 : For 200ℓ

#### Dimensions

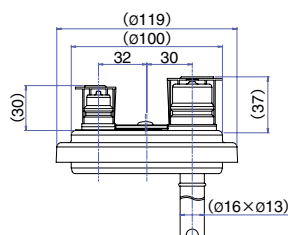

#### Features

- Model TKM is mounted in container with the capacity of 100L and 200L.
- Baffle has been adopted to the connector, which eliminate looseness.
- The outside screw of connector and fixed O-ring type make it leak-free.
- The reinforcing panel of SUS-made by SUS-made makes it possible to prevent from cracking polyethylene inner lid. (However, periodic replacement is required for the inner lid.)
- It has been designed for lower-cost and to resolve conventional problems.
- Siphon tube is integrated into Plug on liquid side.

### Model TKM-MS-MP Hexagon cap nut type



#### Ordering Information

**TKM-MS-6MP**  
**TKM-MS-3MP**

#### Features

- The product has preminent sealing characteristics for fixed O-ring.
- PFA tube (Siphon) is integrated into liquid side plug.

#### Dimensions

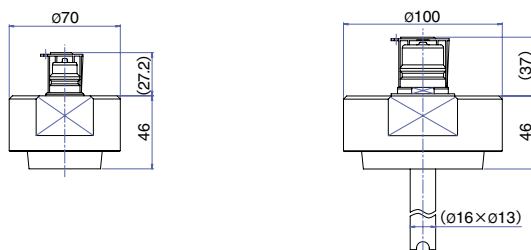

### Model TKM Connection-error prevention using key groove type

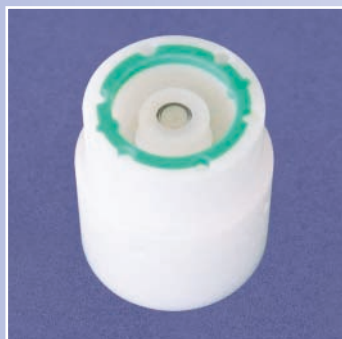

#### Features

- Connection-error prevention with key groove is provided.
- The product has preminent sealing characteristics for fixed O-ring.

# Model BPF / Model TKM-BQ4F

## Connectors to prevent liquid drop for compact bottle (15L, 18L)



TKM-BPF



The connector has been developed for pressurized containers for semiconductor high-purity chemicals, medical chemicals and industrial cleaning liquid, so that the connector has been combined safety with air sealing, working property.

### Features

- It is able to prevent liquid drop when detaching plug and socket. (Residual liquid : 0.05cc or less)
- One-touch connection method can facilitate installation.
- Body material on Plug side : PTFE type and PFA type available.
- Connection-error prevention type is available.

### Specifications

Operating temperature range	5~60°C
Valve (plug side)	O-ring less
Wetted parts	It differs according to each model

### Ordering Information

	Plug (with cap)	Socket (Optional cap available)
Liquid side	<p><b>TKM-□-PO-□L</b></p> <ul style="list-style-type: none"> <li>→ O-ring material P : Perfluor</li> <li>A : Alkali proof FKM</li> <li>E : EPDM</li> <li>→ Liquid side (OUT side)</li> <li>→ Plug</li> <li>→ Body material BQ4F : PTFE</li> <li>BPF : PFA</li> </ul>	<p><b>TKM-BPF-SO-P</b></p> <ul style="list-style-type: none"> <li>→ O-ring material P : Perfluor</li> <li>→ Liquid side (OUT side)</li> <li>→ Socket</li> </ul> <p>* Body material is PFA.</p>
Gas side	<p><b>□-PI-□</b></p> <ul style="list-style-type: none"> <li>→ O-ring material P : Perfluor</li> <li>A : Alkali proof FKM</li> <li>E : EPDM</li> <li>→ Gas side (IN side)</li> <li>→ Plug</li> <li>→ Body material BQ4F : PTFE</li> <li>BPF : PFA</li> </ul>	<p><b>S-BPF-SI-FL</b></p> <ul style="list-style-type: none"> <li>→ Valve : O-ring less</li> <li>→ Seal of plug : FEP Jacket O-ring</li> <li>→ Gas side (IN side)</li> <li>→ Socket</li> </ul> <p>* Body material is PFA.</p>

### Dimensions

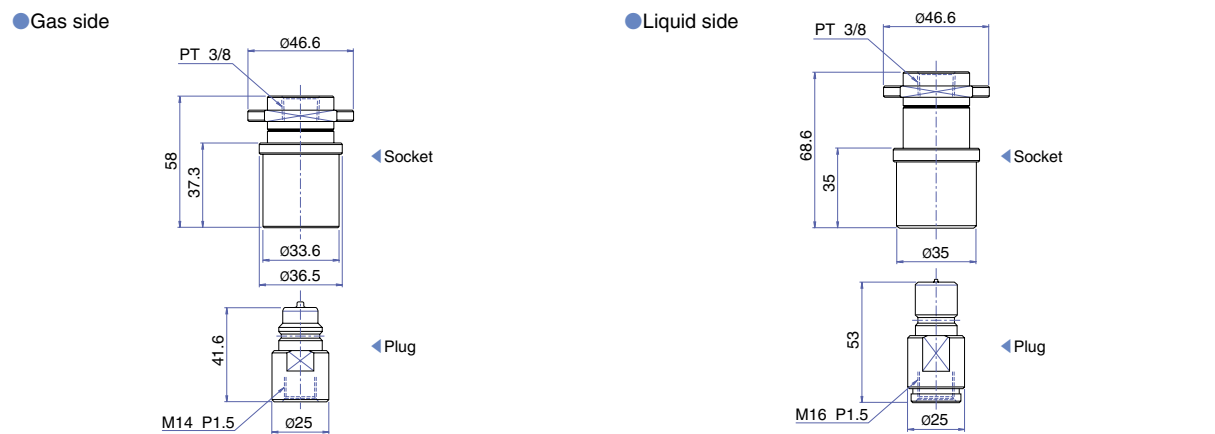

## Model TKM-BPF / Model TKM-BQ4F

Connection-error prevention type with difference key-ring



### Ordering Information

① Plug and difference key-ring set

**TKM-□-PO-PL-TYPE □-□**

Plug material BQ4F : PTFE  
BPF : PFA

② Difference key-ring only

**DKR-□-□**

Key-groove selection (Please select from the followings.)

③ Socket on liquid side only

**TKM-BPF-SO-P-TYPE □-□**

Key-groove selection (Please select from the followings.)

● Kinds of difference key-rings : 14 kinds

### All 14 kinds of key-grooves

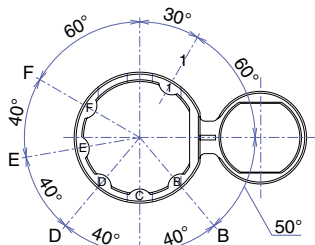

Key groove No.1

TYPE 1-B  
1-C  
1-D  
1-E  
1-F

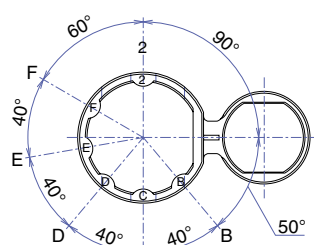

Key groove No.2

TYPE 2-B  
2-C  
2-D  
2-E  
2-F

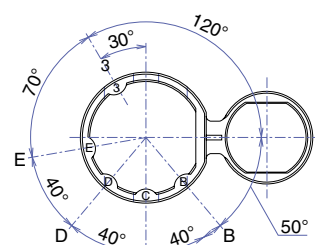

Key groove No.3

TYPE 3-B  
3-C  
3-D  
3-E

### Example of Ordering Information

**TKM-□-□-□-TYPE □-□**

□ : BPF  
□ : BQ4F (for plug)

SO : Socket  
PO : Plug

PL : Plug only  
P : Socket only

□ : Select from the above key grooves (alphabet)

□ : Select from the above key grooves (1~3)

● Body material

● BPF : PFA

● BQ4F : PTFE

\* Socket : optional cap available  
Plug : with cap

### Instructions of usage

- After set plug in, embed difference key-ring in the connector. Then, confirm that the plug and the key-ring match faces.
- Can not remove. If you remove it, please cut bridge by cutter.

### Cautions

#### ① Confirmation of connection error

Please be careful not to do that socket mounted difference key-ring connect to standard plug without difference key-ring (TKM-BQC, BQ4F, BPF)  
Natural color is used for difference key-ring and sleeve of connection-error prevention type. Green color ring is used for plug of standard type TKM. Green sleeve is used for socket of standard type TKM.

#### ② About sales

Model TKM plug only available. Can not correspond to Model BQC, BPF, BQ4F.

### Figure (Reference example)

#### ● Liquid side

Socket : TKM-BPF-SO-P-TYPE1-B  
Plug : TKM-BPF-PO-PL-TYPE1-B

#### ● Gas side

Socket : S-BPF-SI-FL  
Plug : BPF-PI-P

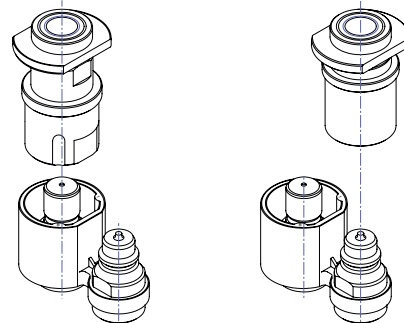

## Model BQC Connector for compact bottle <PCTFE-made>



BQC

### Specifications

Operating pressure	Max.350kPa
Operating temperature range	5~70°C
Connection size	Socket side : PT3/8 Plug side : M14 P1.5 (IN side) M16 P1.5 (OUT side)
Accessories	PP-made plug cap, PP-made baffle

### Ordering Information

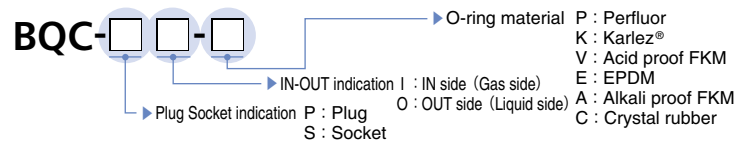

## Model BPF Connector for compact bottle <PFA-made>



BPF

### Specifications

Operating pressure	Max.250kPa
Operating temperature range	5~60°C
Connection size	Plug side : M14 P1.5 (IN side) M16 P1.5 (OUT side)
Accessories	PP-made plug cap, PP-made baffle

### Ordering Information

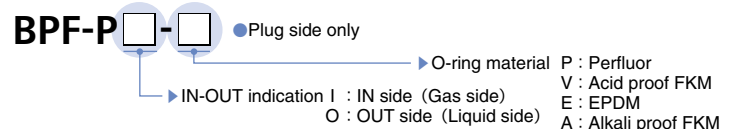

## Model BQ4F Connector for compact bottle <PTFE-made>



BQ4F

### Specifications

Operating pressure	Max.250kPa
Operating temperature range	5~60°C
Connection size	Socket side : PT3/8 Plug side : M14 P1.5 (IN side) M16 P1.5 (OUT side)
Accessories	PP-made plug cap, PP-made baffle

### Ordering Information

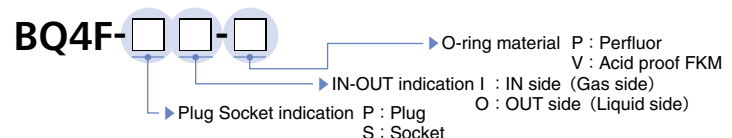

\* Please select materials according to type of chemicals BQC, BPF, BQ4F are compatible each other due to same measurement.  
\* Plug comes with cap, socket comes without cap (optional cap available)

# Model QCH Quick Connector



## Specifications

Operating pressure	Max.450kPa
Operating temperature range	5~70°C
Connection size	PT3/8, PT1/2, PT3/4, PT1, PT1 1/2
Wetted parts	25A, 40A : PCTFE, Various types of O-ring, PTFE 3~6 : PCTFE, PFA, Various types of O-ring, PTFE

## Ordering Information

### ● Plug

QCH-W□-□P

- Connection size 3 : PT 3/8  
4 : PT 1/2  
6 : PT 3/4  
25A : PT 1  
40A : PT 1 1/2
- O-ring material P : Perfluor  
K : Karlez®  
V : Acid proof FKM  
E : EPDM  
A : Alkali proof FKM  
C : Crystal rubber

\* Optional cap available

### ● Socket

QCH-W□-□S

QCH-WF□-□S

- Connection size 3 : PT 3/8  
4 : PT 1/2  
6 : PT 3/4
- Connection size 25A : PT 1  
40A : PT 1 1/2
- O-ring material P : Perfluor  
K : Karlez®  
V : Acid proof FKM  
E : EPDM  
A : Alkali proof FKM  
C : Crystal rubber

\* FEP Jacket O-ring is used for 25A, 40A size.

## Dimensions

### ● Plug

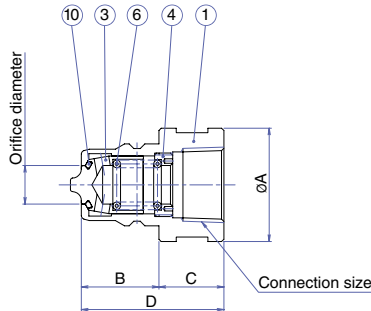

### ● Socket

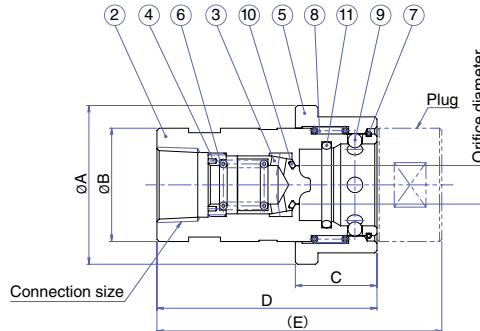

Model	∅A	B	C	D	Orifice diameter	Connection size	Width across flats
QCH-W□-3P	30	16.5	28.75	45.25	∅6.5	PT3/8	26
QCH-W□-4P	35	22.4	28.5	50.9	∅10	PT1/2	30
QCH-W□-6P	40	22.4	34.1	56.5	∅13	PT3/4	37
QCH-W□-25AP	50	34.2	28.6	62.8	∅17	PT1	46
QCH-W□-40AP	73	51	47	98	∅27	PT1 1/2	66

\* Put o-ring material into □.

Model	∅A	∅B	C	D	(E)	Orifice diameter	Connection size	Width across flats
QCH-W□-3S	35	30	22.3	61.75	90.5	∅6.5	PT3/8	26
QCH-W□-4S	45	35	24.5	72.5	101	∅10	PT1/2	30
QCH-W□-6S	50	40	26	79.4	113.5	∅13	PT3/4	37
QCH-WF□-25AS	70	50	36	97	125.6	∅17	PT1	46
QCH-WF□-40AS	95	73	54	144	191	∅27	PT1 1/2	66

\* Put o-ring material into □.

### ● Parts List

P/No	Parts name	Material
1	Plug	PCTFE
2	Socket	PCTFE
3	Valve	PCTFE
4	Stopper	PFA
5	Sleeve	PCTFE
6	Spring for valve	PTFE
7	Stop ring	PTFE
8	Spring for sleeve	PTFE
9	Ball	PCTFE
10	O-ring	*
11	O-ring	*

\* As for No.4 stopper material PCTFE is used for 25A, 40A size.  
\* As for No.5 sleeve material P.P is used for 25A, 40A size.  
\* Please refer to the Ordering Information for O-ring material.

## Flow rate

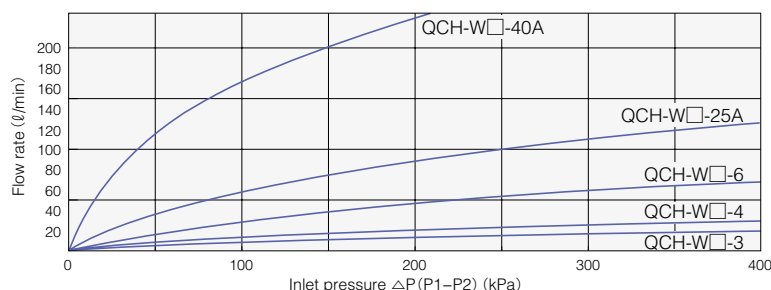

\* The flow rate is obtained when socket and plug are connected.  
\* The flow rate is reference value, not a guarantee value.



# Model QCH-WL O-ring Less Quick Connector



QCH-WL-4P / QCH-WPL-4S

## Specifications

Operating pressure	Max.450kPa
Operating temperature range	5~70°C
Connection size	PT3/8, PT1/2, PT3/4
Wetted parts	PCTFE, PFA, Perfluor O-ring, PTFE

## Ordering Information

● Plug

**QCH-WL-□P**

▶ Connection size 3 : PT 3/8  
4 : PT 1/2  
6 : PT 3/4

● Socket

**QCH-WPL-□S**

▶ Connection size 3 : PT 3/8  
4 : PT 1/2  
6 : PT 3/4

▶ O-ring material : Perfluor

\* Optional cap available

\* Valve is O-ring less, Sealing part of socket has O-ring.

## Dimensions

● Plug

● Socket

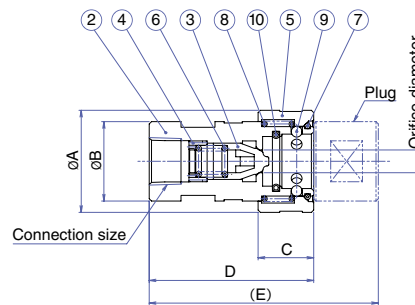
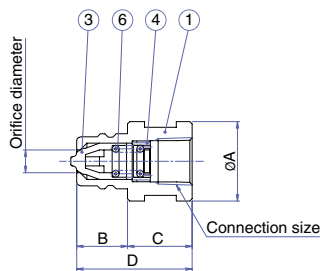

### ● Parts List

P/No	Parts name	Material
1	Plug	PCTFE
2	Socket	PCTFE
3	Valve	PFA
4	Stopper	PFA
5	Sleeve	PCTFE
6	Spring for valve	PTFE
7	Stop ring	PTFE
8	Spring for sleeve	PTFE
9	Ball	PCTFE
10	O-ring	Perfluor

Model	øA	B	C	D	Orifice diameter	Connection size	Width across flats
QCH-WL-3P	30	16.5	28.75	45.25	ø6.5	PT3/8	26
QCH-WL-4P	35	22.4	28.5	50.9	ø10	PT1/2	30
QCH-WL-6P	40	22.4	34.1	56.5	ø13	PT3/4	37

Model	øA	øB	C	D	(E)	Orifice diameter	Connection size	Width across flats
QCH-WPL-3S	35	30	22.3	61.75	90.5	ø6.5	PT3/8	26
QCH-WPL-4S	45	35	24.5	72.5	101	ø10	PT1/2	30
QCH-WPL-6S	50	40	26	79.4	113.5	ø13	PT3/4	37

# Model QCH-F Quick Connector Flange type



## Specifications

Operating pressure	Max.450kPa
Operating temperature range	5~70°C
Wetted parts	25A, 40A : PCTFE, Various types of O-ring, PTFE 6 : PCTFE, PFA, Various types of O-ring, PTFE

## Ordering Information

### ● Plug

QCH-W□-□P-□

Flange F : JIS 10K  
ANSI-F : ANSI-150

Body size 6 : Compatible with QCH-W□-6  
25A : Compatible with QCH-W□-25A  
40A : Compatible with QCH-W□-40A

O-ring material P : Perfluor  
K : Karlez®  
V : Acid proof FKM  
E : EPDM  
A : Alkali proof FKM  
C : Crystal rubber  
L : O-ring less

\* Compatibility with Model QCH is possible. \* Optional cap available

### ● Socket

QCH-W□-6S-□

QCH-WF□-□S-□

Flange F : JIS 10K  
ANSI-F : ANSI-150

Body size 25A : Compatible with QCH-W□-25A  
40A : Compatible with QCH-W□-40A

O-ring material P : Perfluor  
K : Karlez®  
V : Acid proof FKM  
E : EPDM  
A : Alkali proof FKM  
C : Crystal rubber

\* FEP Jacket O-ring is used for 25A, 40A size.

## Dimensions

### ● Plug

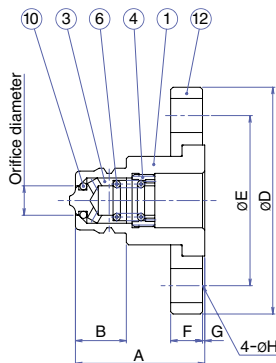

Model	A	B	∅D	∅E	F	G	H	Orifice diameter	Flange size
QCH-W□-6P-F	57	22.4	100	75	14	1	15	∅13	JIS 10K 20A
QCH-W□-25AP-F	72.2	34.2	125	90	14	1	19	∅17	JIS 10K 25A
QCH-W□-40AP-F	98	51	140	105	16	2	19	∅27	JIS 10K 40A

\* Put o-ring material into □.

### ● Socket

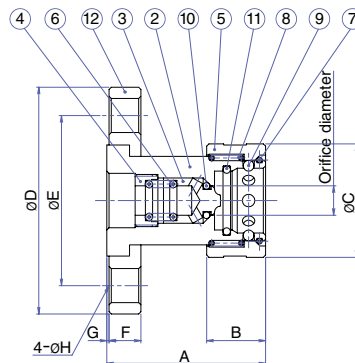

Model	A	B	∅C	∅D	∅E	F	G	H	Orifice diameter	Flange size
QCH-W□-6S-F	70	26	50	100	75	14	1	15	∅13	JIS 10K 20A
QCH-WF□-25AS-F	97	36	70	125	90	14	1	19	∅17	JIS 10K 25A
QCH-WF□-40AS-F	112	54	95	140	105	16	2	19	∅27	JIS 10K 40A

\* Put o-ring material into □.

### ● Parts List

P/No	Parts name	Material
1	Plug	PCTFE
2	Socket	PCTFE
3	Valve	PCTFE
4	Stopper	PFA
5	Sleeve	PCTFE
6	Spring for valve	PTFE
7	Stop ring	PTFE
8	Spring for sleeve	PTFE
9	Ball	PCTFE
10	O-ring	*
11	O-ring	*
12	Flange	SUS316

\* As for No.4 stopper material PFA is used for 3/4 size.

\* As for No.5 sleeve material PCTFE is used for 3/4 size.

\* Please refer to the Ordering Information for O-ring material.

## Flow rate

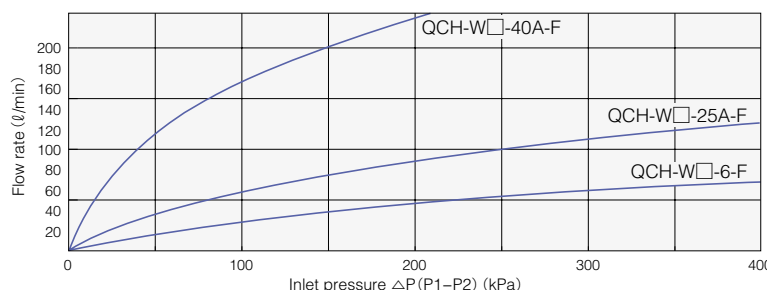

\* The flow rate is obtained when socket and plug are connected.

\* The flow rate is reference value, not a guarantee value.

# Model QC4F PTFE-made Quick Connector



**Feature**

- Body material is made of PTFE, so it has excellent chemical resistance.

**Specifications**

Operating pressure	Max.250kPa
Operating temperature range	5~60°C
Connection size	PT1/2, PT3/4
Wetted parts	PTFE, PFA, Perfluor O-ring (Socket only)

\* Please handle with care since PTFE is the softest material in the other fluorine resin.

## Ordering Information

● Plug

**QC4F-WL-□P**

▶ Connection size 4 : PT 1/2  
6 : PT 3/4

● Socket

**QC4F-WPL-□S**

▶ Connection size 4 : PT 1/2  
6 : PT 3/4  
▶ O-ring material : Perfluor

\* Optional cap available

## Dimensions

● Plug

● Socket

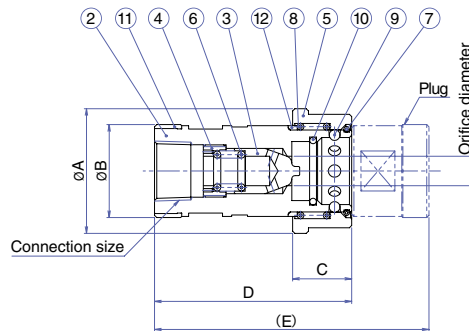
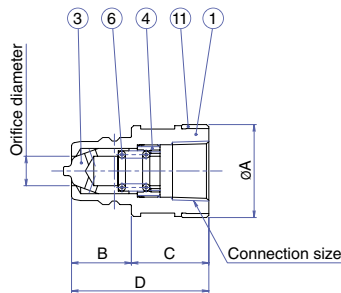

● Parts List

P/No	Parts name	Material
1	Plug	PTFE
2	Socket	PTFE
3	Valve	PFA
4	Stopper	PFA
5	Sleeve	PTFE
6	Spring for valve	PTFE
7	Stop ring	PTFE
8	Spring for sleeve	PTFE
9	Ball	PCTFE
10	O-ring	Perfluor
11	Reinforced O-ring	SUS304
12	Ring	PCTFE

Model	øA	B	C	D	Orifice diameter	Connection size	Width across flats
QC4F-WL-4P	37	26.4	31.1	57.5	ø10	PT1/2	30
QC4F-WL-6P	41	26.4	34.1	60.5	ø13	PT3/4	37

Model	øA	øB	C	D	(E)	Orifice diameter	Connection size	Width across flats
QC4F-WPL-4S	50	37	24.5	83.9	115	ø10	PT1/2	30
QC4F-WPL-6S	55	41	26	86.9	121	ø13	PT3/4	37

# Model QCL Quick Connector



QCL-WP-2P / 2S

## Specifications

Operating pressure	Max.450kPa
Operating temperature range	5~70°C
Connection size	PT1/4
Wetted parts	PCTFE, PTFE, Various types of O-ring

\* Please make sure not to use for strong gas permeability chemicals.

## Ordering Information

● Plug

QCL-W□-2P

▶ O-ring material P : Perfluor  
K : Karlez®  
V : Acid proof FKM

● Socket

QCL-W□-2S

▶ O-ring material P : Perfluor  
K : Karlez®  
V : Acid proof FKM

\* Optional cap available

## Dimensions

● Plug

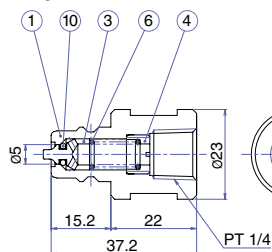

● Socket

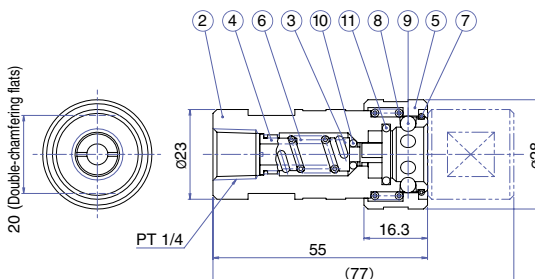

● Parts List

P/No	Parts name	Material
1	Plug	PCTFE
2	Socket	PCTFE
3	Valve	PCTFE
4	Stopper	PCTFE
5	Sleeve	PCTFE
6	Spring for valve	PTFE
7	Stop ring	PTFE
8	Spring for sleeve	PTFE
9	Ball	PCTFE
10	O-ring	*
11	O-ring	*

\* Please refer to the Ordering Information for O-ring material.

## Flow rate

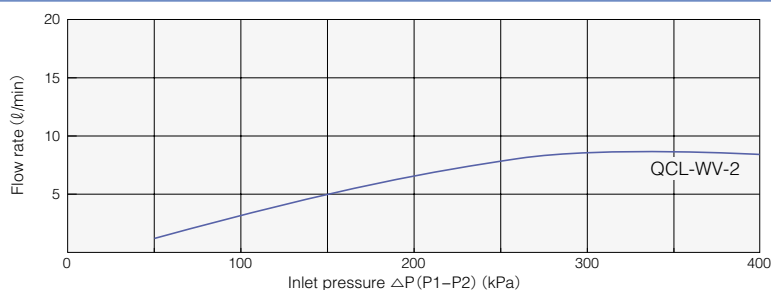

\* The flow rate is obtained when socket and plug are connected.

\* The flow rate is reference value, not a guarantee value.

# Model QCP P.P-made Quick Connector



**Feature**

- The connector is made of P.P, and lower cost.

**Specifications**

Operating pressure	Max.350kPa
Operating temperature range	5~60°C
Connection size	PT3/8, PT1/2
Wetted parts	P.P, PTFE, PFA, PCTFE, FEP Jacket O-ring, Acid proof FKM O-ring

\* Please be careful for compatibility of polypropylene with your fluid type.

**Ordering Information**

● Plug

**QCP-WV-□P**

O-ring material : Acid proof FKM

Connection size 3 : PT 3/8  
4 : PT 1/2

\* Optional cap available.

● Socket

**QCP-WV-□S**

O-ring material : FEP Jacket  
Acid proof FKM

Connection size 3 : PT 3/8  
4 : PT 1/2

**Dimensions**

● Plug

Model	øA	B	C	D	Orifice diameter	Connection size	Width across flats
QCP-WV-□3P	30	16.5	28.75	45.25	ø6.5	PT 3/8	26
QCP-WV-□4P	35	22.4	28.5	50.9	ø10	PT 1/2	30

\* Put o-ring material into □.

● Socket

Model	øA	øB	C	D	(E)	Orifice diameter	Connection size	Width across flats
QCP-WV-□3S	35	30	22.5	61.75	90.5	ø6.5	PT 3/8	26
QCP-WV-□4S	45	35	24.5	72.5	101	ø10	PT 1/2	30

\* Put o-ring material into □.

● Parts List

P/No	Parts name	Material
1	Plug	P.P
2	Socket	P.P
3	Valve	PCTFE
4	Stopper	PFA
5	Sleeve	P.P
6	Spring for valve	PTFE
7	Stop ring	PTFE
8	Spring for sleeve	PTFE
9	Ball	PCTFE
10	O-ring	Acid proof FKM
11	O-ring	FEP Jacket

## Plug for Hand shower



**Feature**

- The product has developed to solve problems of the high-purity water accumulation when hand shower does not use. Please use in sets with QCP-WV-3S.

**Specifications**

Operating pressure	Max.350kPa
Operating temperature range	5~60°C
Connection size	Main pipe : PT3/8 Side port : PT1/4

**Ordering Information**

**QCP-WV-3P-R**

\* Optional cap available.

**Dimensions**

# Model MQC Mini Quick Connector



### Feature

- One-touch connection

### Specifications

Operating pressure	Max.200kPa
Operating temperature range	5~50°C
Connection size	Tube fitting or PT thread
Wetted parts	PTFE, PFA

\* Size 1/4 can not be used for strong gas permeability chemicals.

### Ordering Information

#### Plug

MQC-WL-□P-□

- Connection size PT1/4 : PT 1/4  
PT3/8 : PT 3/8
- Tube size 3 :  $\text{Ø}3 \times \text{Ø}2$   
1/4 :  $\text{Ø}6.35 \times \text{Ø}3.96$
- Body size 1 : 1/4  
2 : 3/8

#### Socket

MQC-WPL-□S-□

- Connection size PT1/4 : PT 1/4  
PT3/8 : PT 3/8
- Tube size 3 :  $\text{Ø}3 \times \text{Ø}2$   
1/4 :  $\text{Ø}6.35 \times \text{Ø}3.96$
- Valve size 1 : 1/4  
2 : 3/8
- O-ring material : Perfluor

### Dimensions

#### Plug

##### Tube fitting type

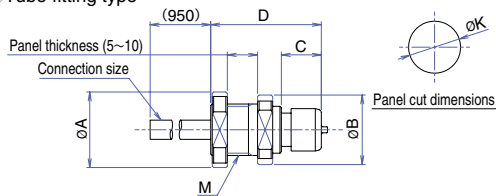

##### PT thread type

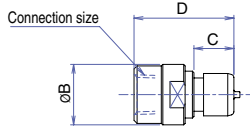

#### Socket

##### Tube fitting type

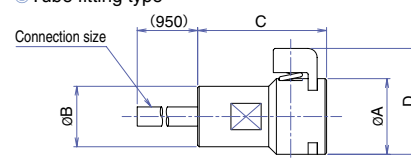

##### PT thread type

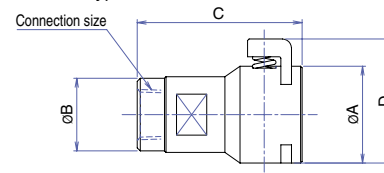

Model	ØA	ØB	C	D	M	ØK	Connection size	Width across flats
MQC-WL-1P-3	25	23	13.2	36.6	M17 P1.5	Ø17.2	Ø3×Ø2	19
MQC-WL-1P-1/4	25	23	13.2	36.6	M17 P1.5	Ø17.2	Ø6.35×Ø3.95	19
MQC-WL-2P-3/8	30	30	14.2	38.6	M24 P1.5	Ø24.2	Ø9.53×Ø6.35	27
MQC-WL-1P-PT1/4	—	20	13.2	33	—	—	PT 1/4	18
MQC-WL-2P-PT3/8	—	25	14.2	38	—	—	PT 3/8	21

Model	ØA	ØB	C	D	Connection size	Width across flats
MQC-WPL-1S-3	25	20	42.6	35	Ø3×Ø2	18
MQC-WPL-1S-1/4	25	20	42.6	35	Ø6.35×Ø3.96	18
MQC-WPL-2S-3/8	32	25	56.1	41	Ø9.53×Ø6.35	21
MQC-WPL-1S-PT1/4	25	20	49	35	PT 1/4	18
MQC-WPL-2S-PT3/8	32	25	54.5	41	PT 3/8	21

### Flow rate

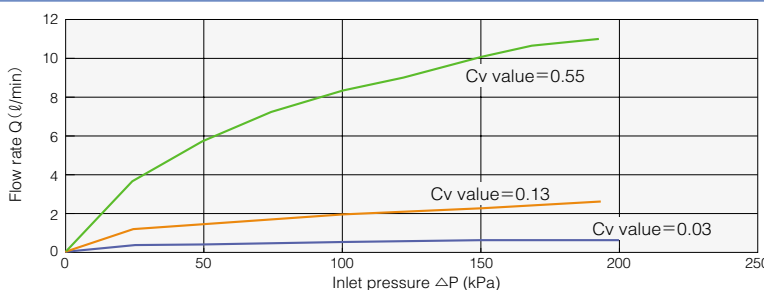

\* The flow rate is reference value, not a guarantee value.

# Model AQC Auto Connector

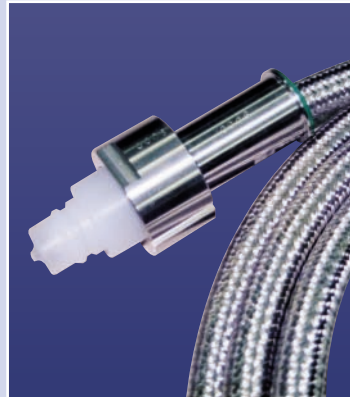

## Features

- Parts contact with fluid are made of fluorine resin.
- Washing & drying using the auto valve and eddy-cyclone methods makes it possible to wash & dry only the plug and socket contact areas.
- Auto connector plugs can be connected either to an Auto connector main socket unit (Model AQC), Semi-Auto Connector (Model S-SE-QCH), or to a Quick Connector Socket (Model QCH), providing the connection aperture dimensions are the same.
- Connection-error prevention model of the Auto Connector using key groove method can be manufactured on request.
- The Auto Connectors' light weight and compact size make it easy to connect to system.
- The Auto Connector comes in sizes 25A, 40A and 50A.
- An all-stainless-steel model of the Auto Connector is also available for organic fluid use. Available only in size 40A.

## Ordering Information

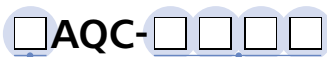

- ▶ Connector size
  - 25 : PT1
  - 40 : PT1 1/2
  - 50 : PT2
  - S40 : PT1 1/2 (All-stainless-steel)
- ▶ Control number (O-ring material / key groove No.)

## Specifications

Operating pressure	Max.250kPa
Type of fluid	Liquids
Operating temperature range	5~50°C
Wetted parts	PCTFE, PFA, PTFE, Various types of O-ring
Pure water cleaning pressure	Max.200kPa
Brow-drying pressure	Max.200kPa
Cylinder operating pressure	450~480kPa

## Connection-error prevention mechanism using key-groove

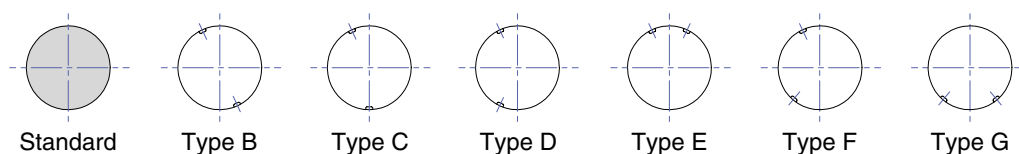

# Model AQC Auto Connector

## Dimensions

### ●25AQC

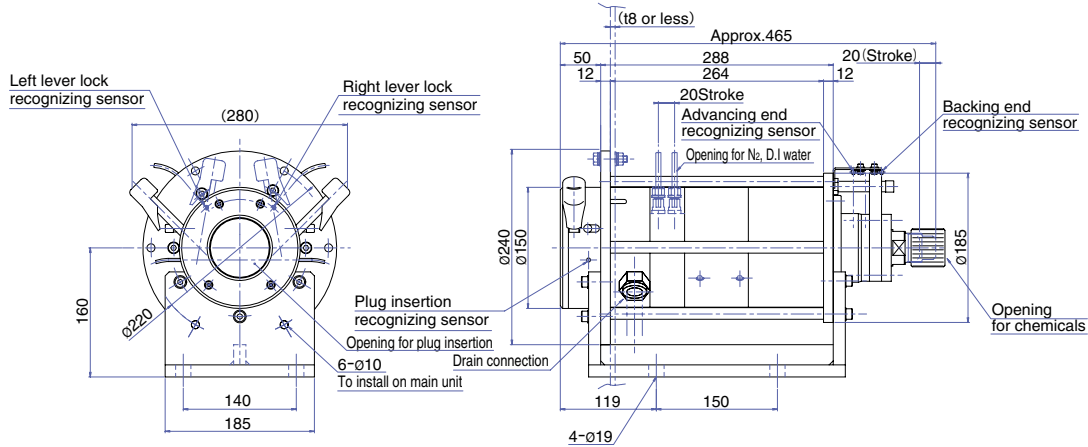

### ●40AQC

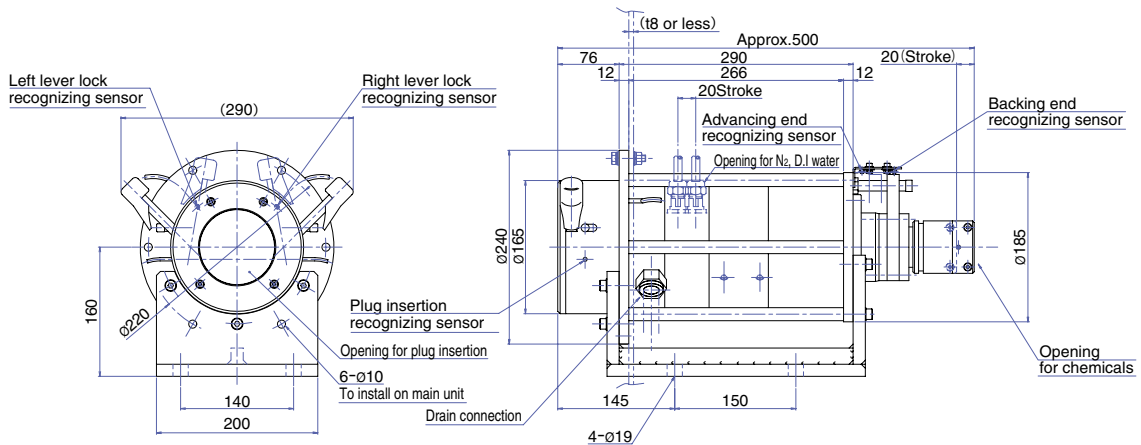

### ●50AQC

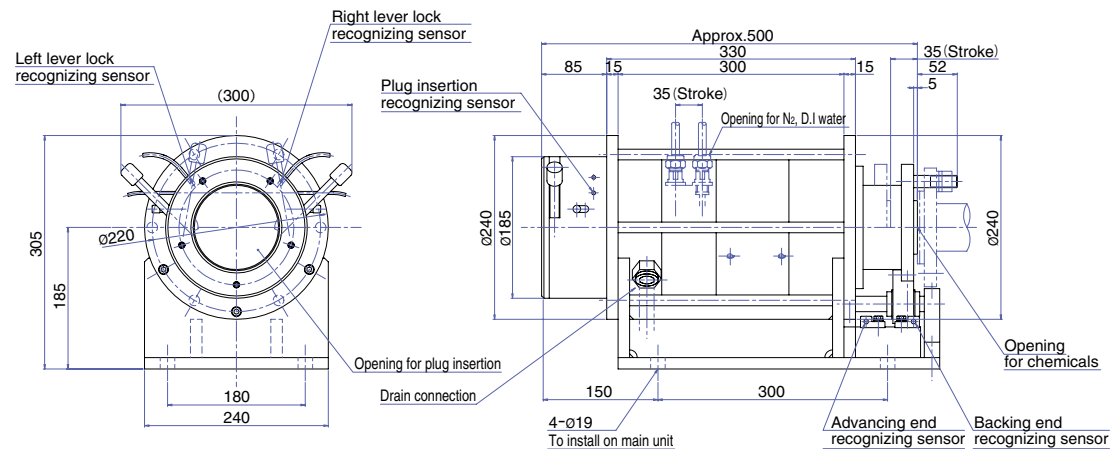



# Model AQC Quick Connector Hose

## Fluoropolymer NSB Hose

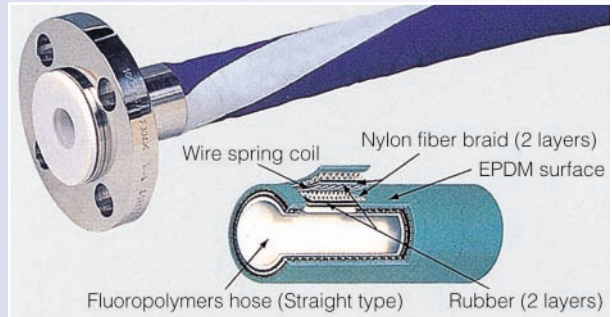

### Dimensions

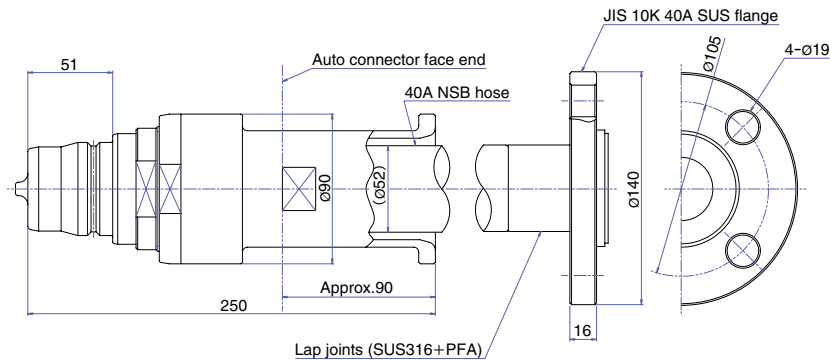

Hose size	(Tube ID)	(Tube OD)
20A	ø19	ø32
25A	ø25	ø38
40A	ø38	ø52
50A	ø51	ø67

\* The above drawing shown that when insert 40A NSB hose to AQC-50AP plug.

## Flexible Stainless Steel Wire Braid Hose

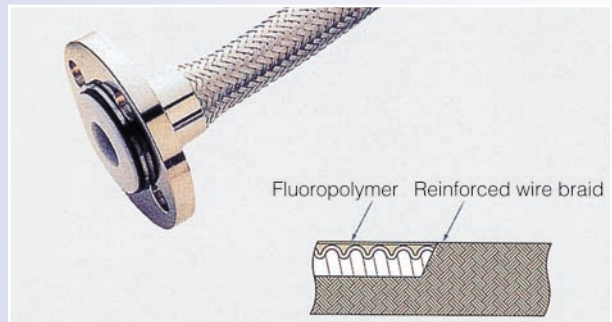

### Dimensions

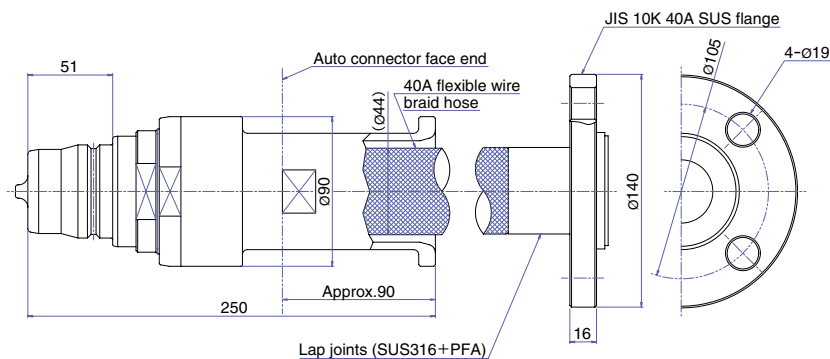

Hose size	(Tube ID)	(Tube OD)
20A	ø14	ø24
25A	ø19	ø30
40A	ø29	ø44
50A	ø38	ø56

\* The above drawing shown that when insert 40A flexible wire braid hose to AQC-50A.

# Quick Connectors

## Ordering Information

**AQC-W** □ - □ **P** - □ □ □ □ - □ **F** - □ □

- ▶ Color ring
    - Non : Color ring unattached
    - R : Red
    - Gn : Green
    - Y : Yellow
  - ▶ Approval of flange
    - Non : JIS 10K
    - ANSI : ANSI 150
    - DIN : DIN
  - ▶ Flange size
    - 25A
    - 40A
    - 50A
  - ▶ Hose length
    - NSB 25A : Min 0.5m / Max 30m
    - 40A : Min 0.5m / Max 30m
    - 50A : Min 0.5m / Max 30m
    - RBYBFLX 25A : Min 0.5m / Max 8m
    - 40A : Min 0.5m / Max 7m
    - 50A : Min 0.5m / Max 6m
  - ▶ Hose type
    - NSB : PFA straight + Rubber + Nylon fiber braid + Wire spring coil + Rubber + Nylon fiber braid + EPDM
    - RBYBFLX : PTFE flexible hose + SUS reinforced braid + Rubber coating
    - YBFLX : PTFE flexible hose + SUS reinforced braid
  - ▶ Hose size
    - NSB 25A :  $\varnothing 25.4 \times \varnothing 38.1$
    - 40A :  $\varnothing 38.1 \times \varnothing 52$
    - 50A :  $\varnothing 50.8 \times \varnothing 67.3$
    - RBYBFLX 25A :  $\varnothing 25 \times \varnothing 28$
    - 40A :  $\varnothing 39 \times \varnothing 42$
    - 50A :  $\varnothing 50 \times \varnothing 54$
    - YBFLX 25A
    - 40A
    - 50A
  - ▶ Key-groove type (only for connection-error prevention type)
    - Non : Standard
    - B : Type B ⊕
    - C : Type C ⊕
  - ▶ Plug size
    - 25A
    - 40A
    - 50A
  - ▶ O-ring material
    - V : Acid proof FKM
    - P : Perfluor
    - A : Alkali proof FKM
    - C : Crystal rubber
    - E : EPDM
    - K : karlez®
- \* There are some flange sizes not to be able to combine according to hose diameter and type of hose.

## Compatibility List of Plug and Socket

Socket \ Plug			Plug for Auto Model AQC					Manual plug for Model QCH	
			25A	40A			50A	25A	40A
				No key groove	Standard	Key groove B			
Auto Model AQC	25A	No key groove	○	×	×	×	×	×	×
		Standard	×	○	×	×	×	×	×
	40A	Key groove B	×	×	○	×	×	×	×
		Key groove C	×	×	×	○	×	×	×
	50A	No key groove	×	×	×	×	○	×	×
Semi Auto Model S-SE-QCH	40A	No key groove	×	○	○	○	×	×	○
	50A	No key groove	×	×	×	×	○	×	×
Manual Model QCH	25A	Standard	○	×	×	×	×	○	×
	40A	Standard	×	○	○	○	×	×	○

# Model ELS-2500/4000/5000 Chemical Supply System for Electronics Industry



ELS-2500/4000/5000

## Features

- System unit that is built-in Model AQC Auto Connector.
- The system has developed to supply chemicals automatically with clean condition when diameter of chemical supply system for semiconductor fabrication were being enlarged.



## Chemical Supply System (Flow sheet)

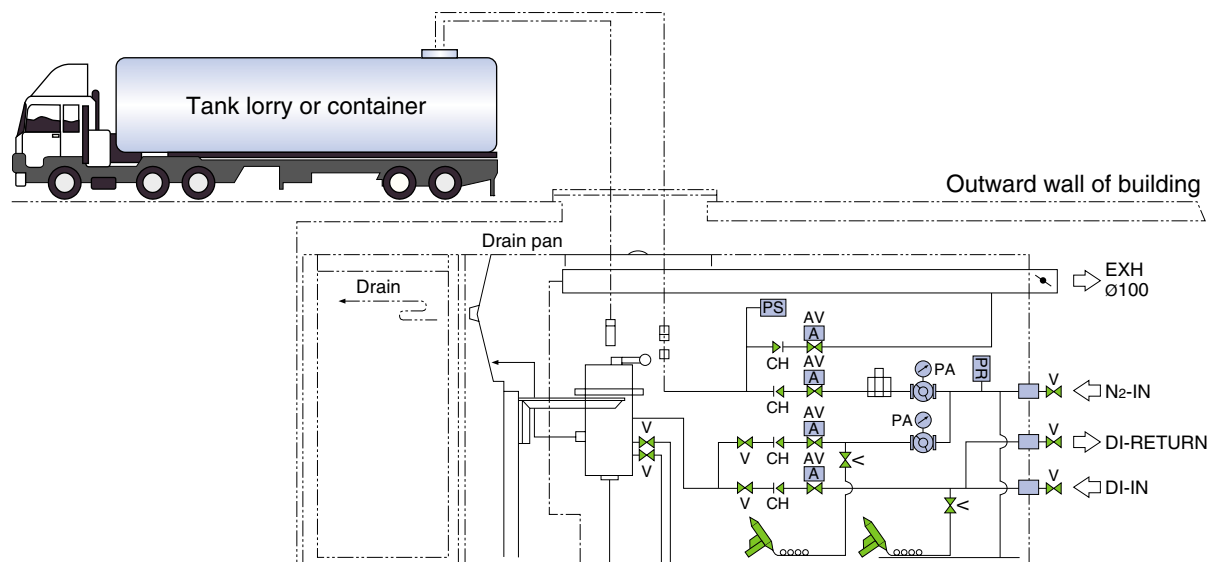

AV : Pneumatic operation valve  
 V : Manual valve  
 CH : Check valve

# Model S-SE-QCH One-touch Semi-Auto Connector

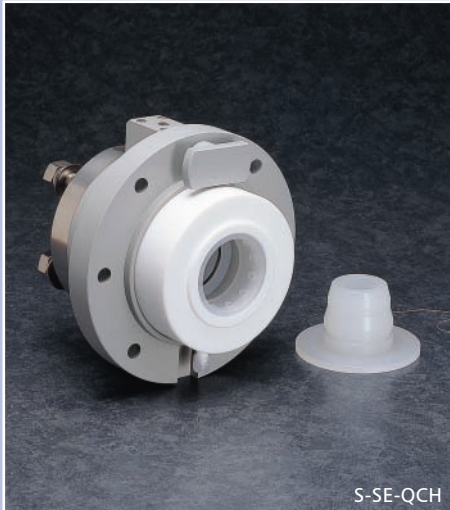

### Features

- The specially developed super one-touch mechanism and air-drive method make connection and detachment of plug easy and safe.
- S-SE-QCH-WFK-40A is compatible with QCH-40A  
S-SE-QCH-WFK-50A is compatible with AQC-50A
- Connection-error prevention type with key groove can be manufactured on request.
- When using connection error prevention type with key grooves, always use a Semi-Auto Bracket and key frame.

### Specifications

Operating pressure	Max.250kPa
Operating temperature range	5~50°C
Cylinder operating pressure	400~450kPa
Wetted parts	PCTFE, PTFE, FEP Jacket O-ring, Karlez® O-ring

### Dimensions

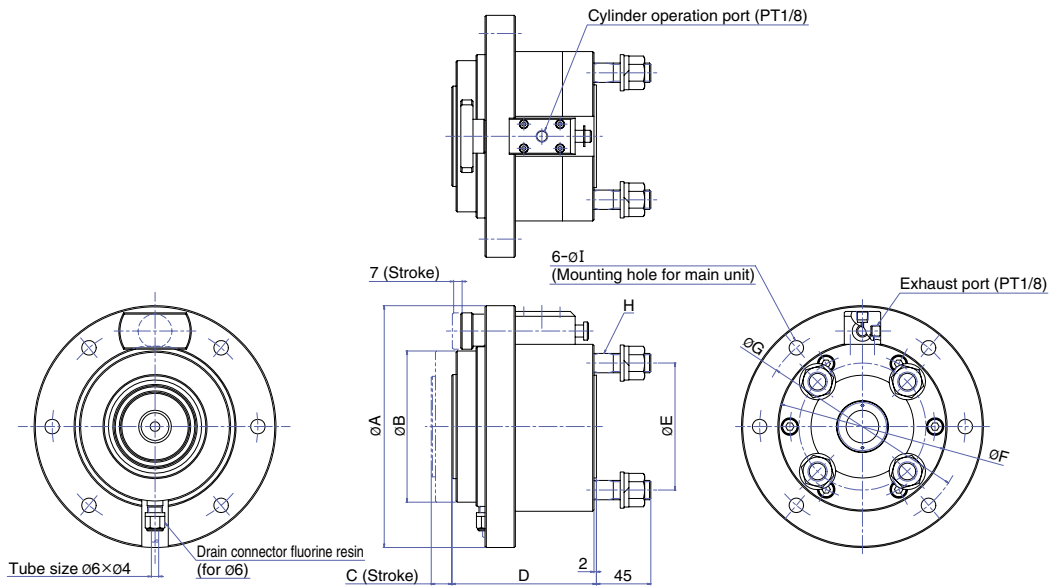

Model	ØA	ØB	C	D	ØE	ØF	ØG	H	ØI
S-SE-QCH-WFK-40AS	200	125	16	125	105	140	170	M16P2.0	12
S-SE-QCH-WFK-50AS	250	160	27	161.5	120	185	218	M16P2.0	17
S-SE-QCH-WFK-S40AS	200	125	17	119.5	105	140	170	M16P2.0	12

### Bracket for Semi-Auto

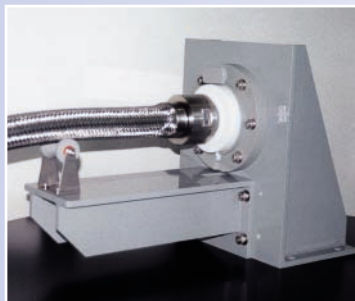

### Ordering Information

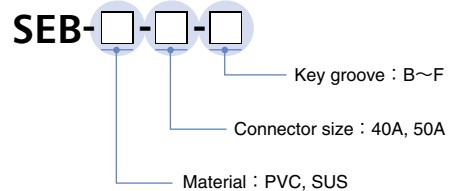

# Model HB Handy Box (For Large Aperture)



HB

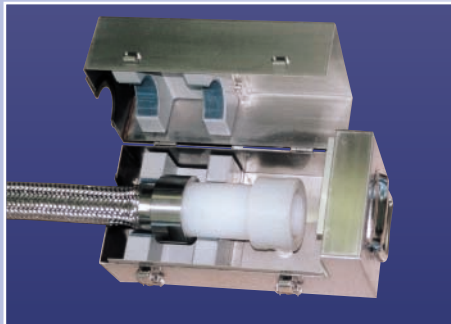

### Features

- Handy box is protective box designed to contain Large aperture models of Quick connector.
- Quick connector can be carried in the Handy box without detaching the fluoropolymer hose.
- Handy box is made of SUS304.

### Ordering Information

Model Size	QCH		S-SE-QCH	AQC
	Socket	Plug	Plug	Plug
25A	QCH-HB-25AS	QCH-HB-25AP	—	—
40A	—	—	AQC-HB-40AP	AQC-HB-40AP
50A	—	—	AQC-HB-50AP	AQC-HB-50AP

### Dimensions

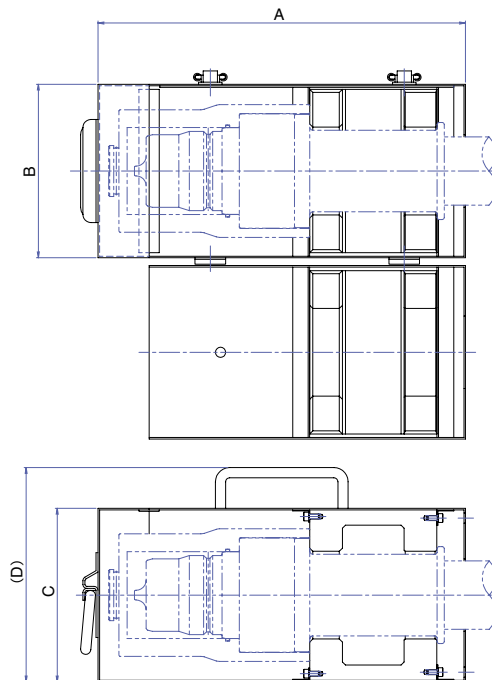

Model	A	B	C	(D)
QCH-HB-25AS	180	100	100	130
QCH-HB-25AP	180	100	100	130
AQC-HB-40AP	300	130	130	170
AQC-HB-50AP	360	170	170	210

# Cap series

## Dust Proof Cap

● For QCH



### Ordering Information

**QC-□-PP-□**

- ▶ Plug/Socket indication P : Plug  
S : Socket
- ▶ Material : P.P
- ▶ Size 3 : QCH-□-3□  
4 : QCH-□-4□  
6 : QCH-□-6□  
25A : QCH-□-25A□  
40A : QCH-□-40A□

● For BQC



### Ordering Information

● Plug side **BQC-P-□-CAP**

- ▶ IN-OUT indication I : IN side (Gas side)  
O : OUT side (Liquid side)

● Socket side **BQC-S-□-D**

- ▶ IN-OUT indication I : IN side (Gas side)  
O : OUT side (Liquid side)

● For PDC



### Ordering Information

● Liquid side **PDC-□-□-CAP**

- ▶ Type : A·B·C
- ▶ Plug/Socket indication P : Plug  
S : Socket

● Gas side **PDC-□-G-CAP**

- ▶ Plug/Socket indication P : Plug  
S : Socket

● For TKM



### Ordering Information

for TKM-3S : PDC-S-G-CAP  
 for TKM-4S-Pr : PDC-4S-CAP  
 for TKM6F-6S-Pr : TKM-6S-CAP

TKM6F-3P : PDC-P-G-CAP  
 TKM-4P : PDC-4P-CAP  
 TKM6F-6P : PDC-P-AN-CAP

## Vent Cap

● PDC-VENT



### Ordering Information

**PDC-VENT** (O-ring : FKM)  
**PDC-VENT-Pr** (O-ring : Perfluor)

# Connector Variation

● One-port type

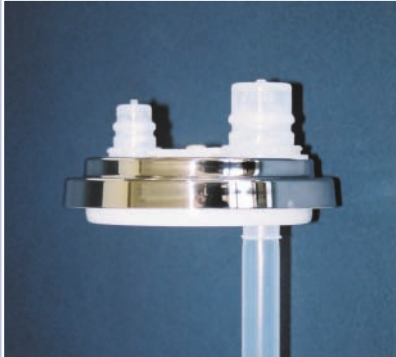

● Cleaning type



● Elbow socket



● For 22ℓ PE



● QCH color ring



● MQC for resist gallon bin



● STKM



● Total



● 100/200ℓ pressurized container



● PFA18ℓ



● PE Elbow socket USE-SGR type



● 1000ℓ container



# Quick Connectors

## ● Safety Instructions



- ⊙ Before you use this product, carefully read this manual for safety operation. We are not liable to any accident caused by neglect of our instructions.
- ⊙ Use this product in accordance with its specification.
- ⊙ Confirm the compatibility of the type of fluid to be used and the material of the part in contact with fluids before using this product.
- ⊙ Do not connect or detach Fluoropolymers Quick Connectors under pressurized conditions. Doing so may cause contents (chemical fluids) to splash out, causing accidents or injuries.
- ⊙ Using inappropriate O-ring material may cause leakage. Before specifying your O-ring material make sure that it is compliant with your fluid type and temperature.
- ⊙ Do not use this product for liquid containing foreign substances. Such usage may degrade the performance of the product.
- ⊙ Please handle abrasive and coagulable fluids with care not to cleave. Such fluids may degrade the system performance.
- ⊙ Do not use Fluoropolymers Quick Connectors in applications subject to flexural or tensile stress.
- ⊙ Do not use Fluoropolymers Quick Connectors as rotary joints or for other rotary applications. Rotary joints are available as separate products.
- ⊙ Make sure that all connections and detachments of Fluoropolymers Quick Connectors are done in a clean, litter-free area.
- ⊙ Never use this product in a place that could have vibration. Such usage may cause abnormal operation.
- ⊙ When connection or detaching Fluoropolymers Quick Connectors, always wear a protective face mask, protective gloves, and protective clothing.
- ⊙ Fully examine and select the appropriate material for the part in contact with fluid.

## ● Notes on product warranty



This product is warranted for a period of one (1) year from the date of delivery by Surpass Industry Co.,Ltd. Within this period, we will replace the product with any defect that is undoubtedly due to design or workmanship. This warranty does not apply to the followings.

- ① Any defective products due to mishandling or improper usage.
- ② Any defective products due to alteration or improper repair by other than Surpass Industry.
- ③ Any defective products due to a natural disaster, riot or accident that we are not liable to.



This product is not designed for use with any equipment or in the system that is operated under conditions that could be critical to human life.



The data described in the catalog is a reference value, not a guarantee value.

## ● Description of marks used in this manual



**Caution** Indicates a potential hazardous situation that, if not avoided, could result in personal injury or damage to the property.



Indicates proper procedures and instructions to avoid any damage to the product and use it properly.

We take an order for customizing the product according to your specific needs. For more information, please contact us.

\* The contents of this manual may subject to future modifications without prior notice.

\* We made best efforts in completing this manual. However, if you find any questionable area, mistakes or omissions, please contact us.

\* We are not liable to any consequential influence due to usage of this product.

\* We are not liable to any damage due to incorrect usage or unauthorized usage of product.

\* Using inappropriate O-ring material may cause leakage. Before specifying your O-ring material make sure that it is compliant with your fluid type and corrosion resistance.

\* Please be careful about similar products.

\* Karlez® is registered trademarks of DuPont Dow Elastomers.

\* We are sanctioned by International Export Control and Chemical Weapons Conventions. Our products will be subject to "List controls" and "Catch-all controls" that corresponds with Foreign Exchange and Foreign Trade Law. All our products are subject to "Catch-all controls". Please observe the procedures under the laws of export regulations.

# SURPASS

Surpass Industry Co., Ltd.

Head office 2203 Shimooshi, Gyoda-City, Saitama-Pref.  
Zip 361-0037  
Tel. +81-48-554-9767  
Fax. +81-48-554-9906

● Distributor