

SSL SERIES

0.5mm PITCH CONNECTOR FOR MICRO COAXIAL CABLE

RoHS
Compliant

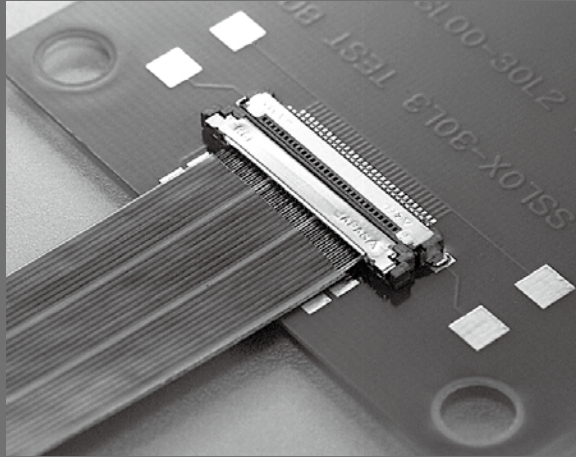

FEATURES

- ▶ Compact connector with a low profile of 1.4 mm(0.055") and a mating width of 6.08 mm(0.239").
- ▶ For micro coaxial cable(#40 AWG).
- ▶ IDC of contacts all together is adopted for improved connection reliability and more compact connectors.
- ▶ Equipped with a metal shell, noise reduction and product strength are ensured.
- ▶ Multiple ground terminals are provided for enhanced transmission characteristics and EMS protection.
- ▶ Highly reliable design with effective contact displacement of 0.5mm(0.020").

ORDER CODE

SSL0 - -

① ② ③ ④

*Please order in multiples of the quantity per package.

- ① **[Type]** Receptacle (PCB side connector) **SSL00** : without positioning posts **SSL01** : with positioning posts (Right angle only)
- ② **[Number of contacts]** 10 : 10 pin 20 : 20 pin 30 : 30 pin 40 : 40 pin
- ③ **[Contact tail style]** L3 : Right angle S : Straight
- ④ **[Number of packaging]** 0500 : 500pcs./1 reel 1000 : 1000pcs./1 reel 1500 : 1500pcs./1 reel (Straight only) 3000 : 3000pcs./1 reel (Right angle only)

ORDER CODE

SSL20 - **S** **B**

① ② ③ ④

*Please order in multiples of the quantity per package.

- ① **[Type]** **SSL20** : Plug (cable side connector)
- ② **[Number of contacts]** 10 : 10 pin 20 : 20 pin 30 : 30 pin 40 : 40 pin
- ③ **[Cable exit style]** S : Straight
- ④ **[Recommended cable]** B : Micro coaxial cable(#40 AWG)

* Plug (cable side connector) is composed of base and shell.

SPECIFICATIONS

Material and plating		Electrical Characteristics	
Insulator material	Glass-filled LCP(UL94V-0),Black	Current rating	0.3A per contact
Contact material	Copper alloy	Contact resistance	100mΩ max.
Contact plating	Gold over Nickel	Dielectric withstanding voltage	200V AC for 1minute
Shell material	Copper alloy	Insulation resistance	100MΩ min.at 250V DC
Shell plating	Tin copper over Nickel	Operating temperature	-40°C to +85°C
IDC cover material	[SSL20]Glass-filled LCP (UL94V-0), Off-white	Recommended cable	#40 AWG Micro coaxial cables

Mating Drawing

Unit : mm (inch)

◆ Horizontal Mating

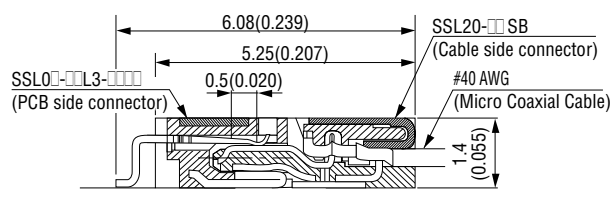

◆ Vertical Mating

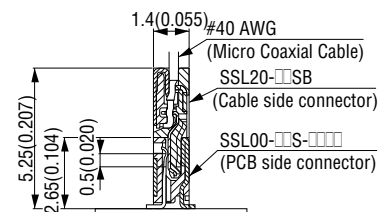

SSL0□-□□L3-□□□□ (Receptacle, PCB side connector, Right angle)

Unit : mm(inch)

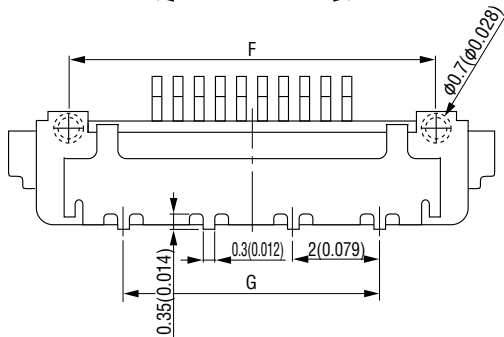
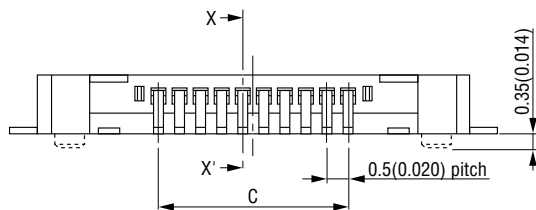
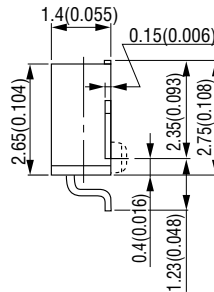
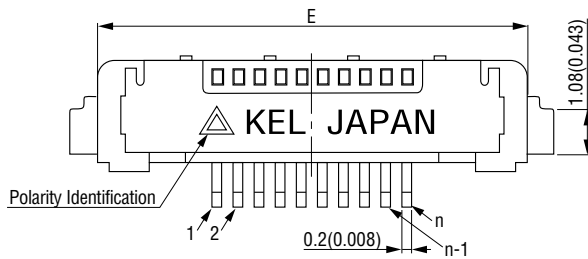
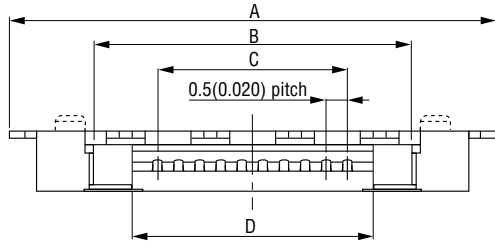
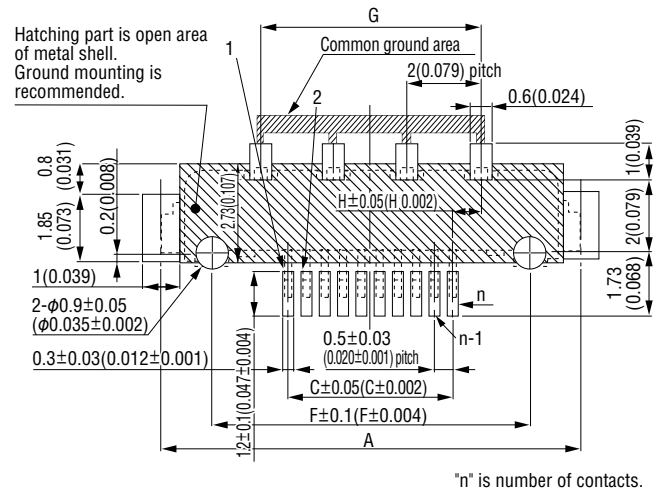
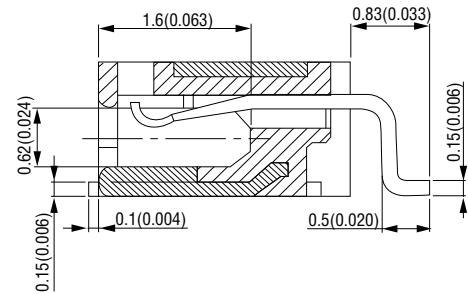
► Printed Circuit Board Layout (Component Side View)

X-X' Cross Section

► Ground Installation

No. of contacts	No. of ground
10	6
20	8
30	11
40	13

Packaging style

Embossed tape

► Product Table

Part Number	Number of packaging
SSL0□-□□L3-0500	500
SSL0□-□□L3-1000	1,000
SSL0□-□□L3-3000	3,000

► Product Table / Dimensions

No. of contacts	Part Number	A	B	C	D	E	F	G	H
10	SSL0□-10L3-□□□□	11.4 (0.449)	7.5 (0.295)	4.5 (0.177)	5.7 (0.224)	10.1 (0.398)	8.6 (0.339)	6.0 (0.236)	0.75 (0.030)
20	SSL0□-20L3-□□□□	16.4 (0.646)	12.5 (0.492)	9.5 (0.374)	10.7 (0.421)	15.1 (0.594)	13.6 (0.535)	10.0 (0.394)	0.25 (0.010)
30	SSL0□-30L3-□□□□	21.4 (0.843)	17.5 (0.689)	14.5 (0.571)	15.7 (0.618)	20.1 (0.791)	18.6 (0.732)	16.0 (0.630)	0.75 (0.030)
40	SSL0□-40L3-□□□□	26.4 (1.039)	22.5 (0.886)	19.5 (0.768)	20.7 (0.815)	25.1 (0.988)	23.6 (0.929)	20.0 (0.787)	0.25 (0.010)



SSL00-□□S-□□□□ (Receptacle, PCB side connector, Straight)

Unit : mm(inch)

► Printed Circuit Board Layout (Component Side View)

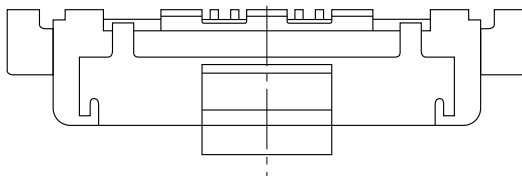
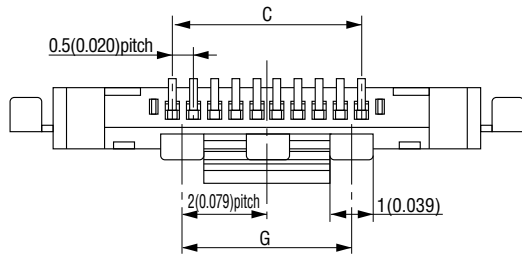
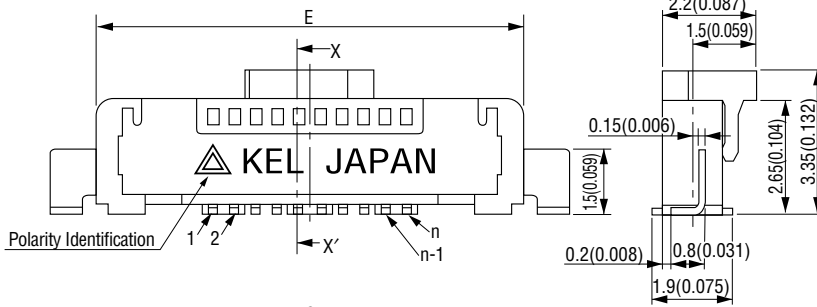
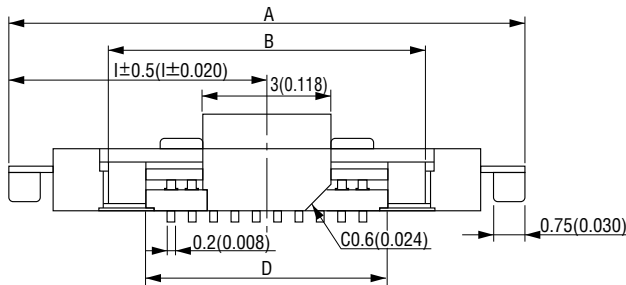
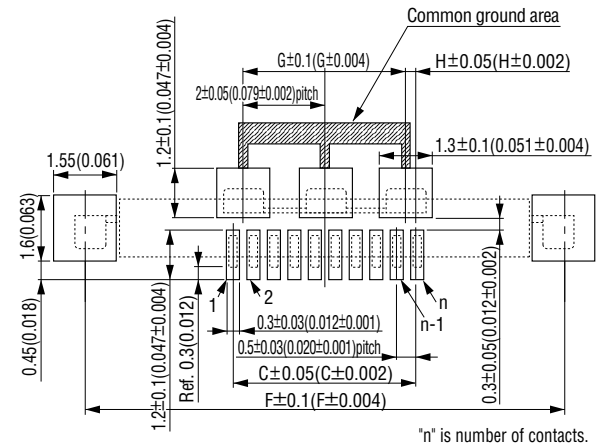

X-X' Cross Section

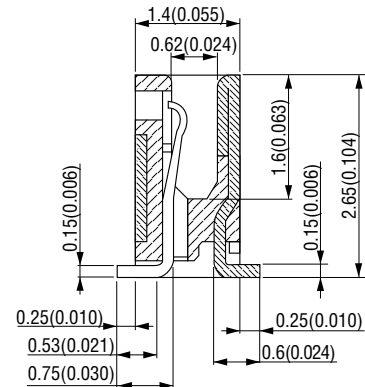

► Ground Installation

No. of contacts	No. of ground
10	5
20	7
30	10
40	12

Packaging style

Embossed tape

► Product Table

Part Number	Number of packaging
SSL00-□□S-0500	500
SSL00-□□S-1000	1,000
SSL00-□□S-1500	1,500

► Product Table / Dimensions

No. of contacts	Part Number	A	B	C	D	E	F	G	H	I
10	SSL00-10S-□□□□	12.2 (0.480)	7.5 (0.295)	4.5 (0.177)	5.7 (0.224)	10.1 (0.398)	11.75 (0.463)	4.0 (0.157)	0.25 (0.010)	6.1 (0.240)
20	SSL00-20S-□□□□	17.2 (0.677)	12.5 (0.492)	9.5 (0.374)	10.7 (0.421)	15.1 (0.594)	16.75 (0.659)	8.0 (0.315)	0.75 (0.030)	8.6 (0.339)
30	SSL00-30S-□□□□	22.2 (0.874)	17.5 (0.689)	14.5 (0.571)	15.7 (0.618)	20.1 (0.791)	21.75 (0.856)	14.0 (0.551)	0.25 (0.010)	11.1 (0.437)
40	SSL00-40S-□□□□	27.2 (1.071)	22.5 (0.886)	19.5 (0.768)	20.7 (0.815)	25.1 (0.988)	26.75 (1.053)	18.0 (0.709)	0.75 (0.030)	13.6 (0.535)

SSL20-□□SB (Plug, Cable side connector)

Unit : mm(inch)

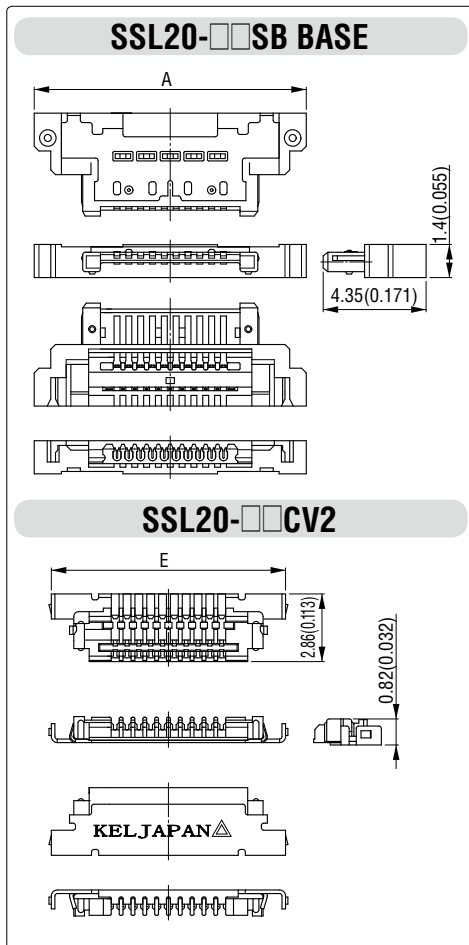

*SSL20-□□SBBASE and SSL20-□□CV2 are component parts of SSL20-□□SB.

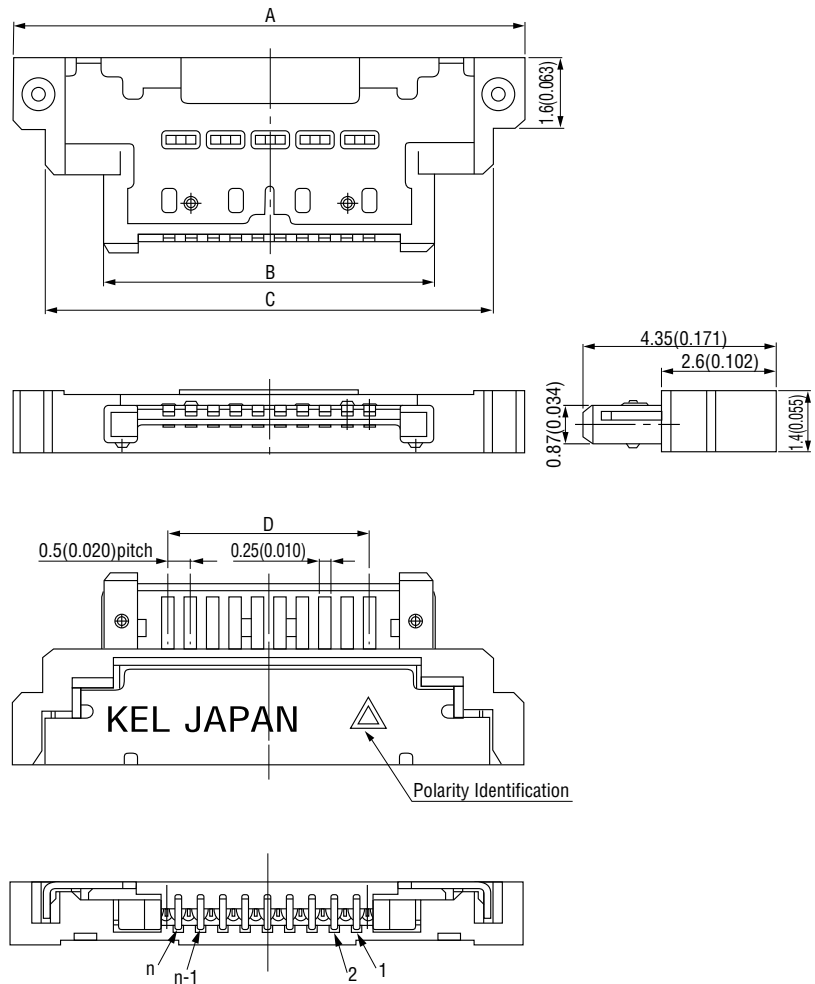

"n" is number of contacts.

Packaging style

Tray

► Product Table / Dimensions

No. of contacts	Part Number	A	B	C	D	E	Number of packaging
10	SSL20-10SB	11.5 (0.453)	7.5 (0.295)	10.1 (0.398)	4.5 (0.177)	9.9 (0.390)	160
20	SSL20-20SB	16.5 (0.650)	12.5 (0.492)	15.1 (0.594)	9.5 (0.374)	14.9 (0.587)	120
30	SSL20-30SB	21.5 (0.846)	17.5 (0.689)	20.1 (0.791)	14.5 (0.571)	19.9 (0.783)	100
40	SSL20-40SB	26.5 (1.043)	22.5 (0.886)	25.1 (0.988)	19.5 (0.768)	24.9 (0.980)	80

