

Head part with MHG and electrode

Connector for mains supply 230V/50Hz, 350VA max.

Cylindrical outer tube

Base part

Oil outlet cock

Base plate. Device is preferably mounted standing on a console.

Connector for suck in hose. Inner hose diameter is 110mm as standard, but this can be changed if desired.

Top view on base plate

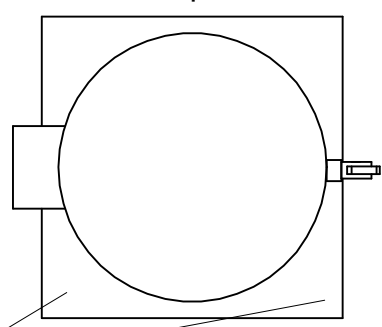

Mounting possibilities on base plate (Drill holes and place screws)

Total weight of device about 20 kg.

			Datum	Name	Kolb System- technik AG	Copyright: Kolb AG
		Bearb.	15.9.00	Kolb Gernot		Blatt 1 von 1
		Gepr.				Ref: m222_m14
Änderung	Datum	Name	SmokeX 222 dimensions			