

# Accessories

## DZ51 (Relay adapter) For connections of DG-B, DL-BR, DL-B and DT12/32N/P\* to LG, LH and LY displays

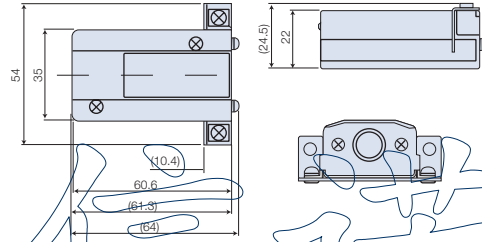

To connect the DT12/32N/P, use the DZ51 in combination with the MT10 detector.



Unit : mm

## DZ-811 Bushing (for mounting a U60A or a DE30BR to a DZ-501 stand)

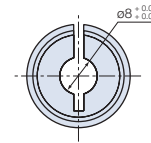
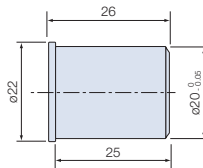

Unit : mm

## DZ173 Air release (for DE12BR/30BR, U Series)

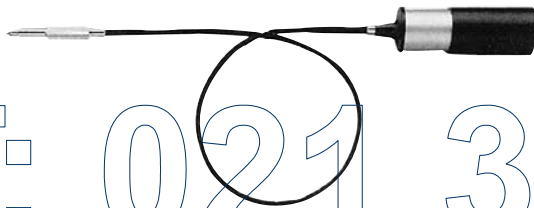

## DZ175-010 Air Lifter (for DL10BR) -030 (for DL30BR) -060 (for DL60BR)

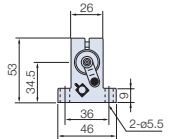

Measuring unit	A	B	C
DL10BR	26.5	102	1
DL30BR	48.5	102	1
DL60BR	83	161	5.5

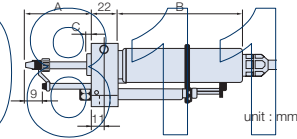

Unit : mm

## DZ301 Bellows set (for DL330B, DE30BR)

Bellows

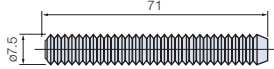

Extension spindle

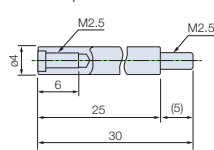

•With the extension spindle attached, the spindle is extended by 25 mm and the measuring force increases by about 0.3 N.

Unit : mm

## DZ-191 Coupling

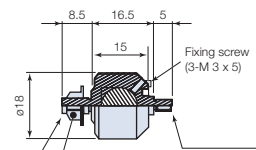

Nut (M 5)  
Spindle mounting screw (M 2.5)  
Mounting screw for machine carriage (M 5)  
Fixing screw (3-M 3 x 5)

Unit : mm

## SZ70-1 Adapter

SZ70-1 is required for connecting the following scale units and counters:

Gauge unit: DE-BR Series, DG-B Series

Counter: LY71 and LY72

\* Adapter DZ51 is also required

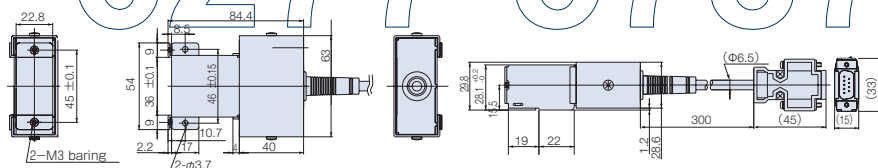

Unit : mm

\*Please refer to p54 for the details of the screw.

# Accessories

## DZ301 Bellows set (for DL330B, DE30BR)

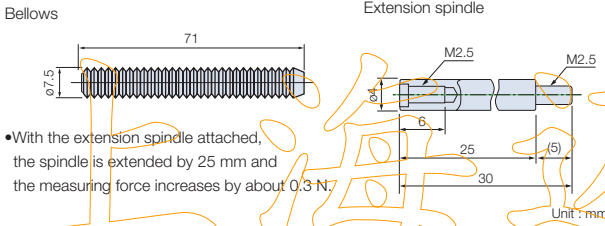

•With the extension spindle attached, the spindle is extended by 25 mm and the measuring force increases by about 0.3 N.

## DZ302 Bellows set (for DE12BR)

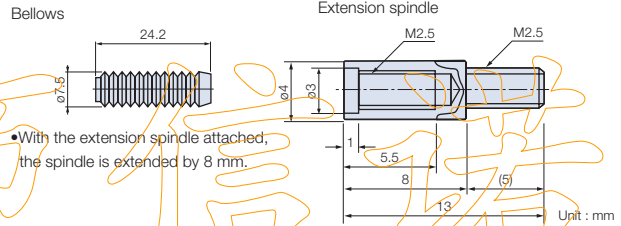

•With the extension spindle attached, the spindle is extended by 8 mm.

## DZ-501 Digital gauging stand (for U60B, DG10B to DG100B, DE-30BR)



- Surface plate material : alumina ceramic
- Surface plate flatness : 2  $\mu$ m
- Surface plate size : 110 mm (4.33") x 110 mm (4.33")
- Maximum workpiece height : approx. 190 mm (7.48")
- Gauge mounting hole :  $\phi$  20mm (0.79")
- Mass : 13kg (28.67 lbs)

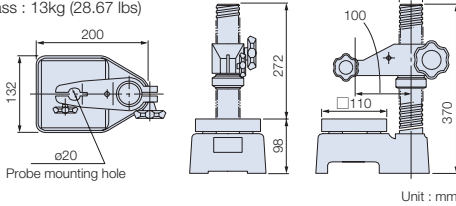

## DZ521 Gauging stand (for DG805BL/810B/810BL, U Series, DE12BR)



- Surface plate material : alumina ceramic (dark brown)
- Surface plate flatness : 2  $\mu$ m
- Surface plate size : 80 mm (3.15") x 80 mm (3.15")
- Maximum workpiece height : approx. 105 mm (4.13")
- Gauge mounting hole :  $\phi$  8 mm (0.31")
- Mass : 3.8 kg (8.38 lbs)

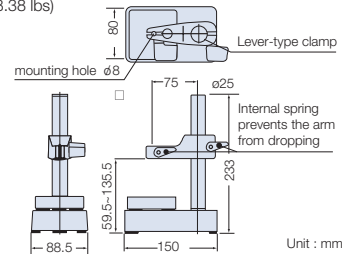

## SZ70-1 Adapter

SZ70-1 is required for connecting the following scale units and counters:

Gauge unit : DE-BR Series, DG-B Series  
Counter : LH71A, LH72-3, LY71 and LY72  
\* Adapter DZ51 is also required

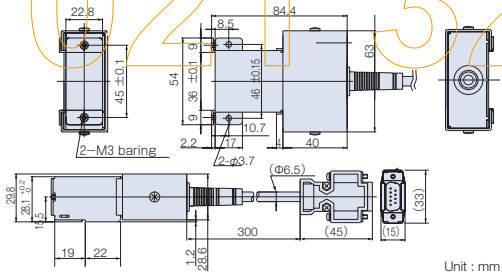

## DZ-191 Coupling

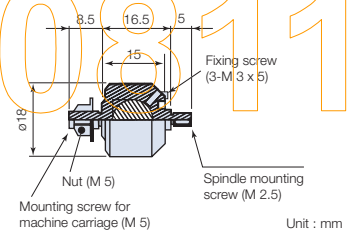
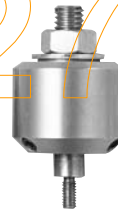

## DZ-5100 Feeler set

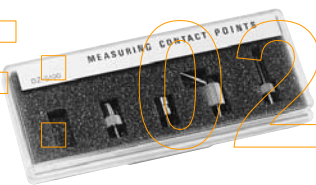

Note : The four contactors shown at right are included.

•Plastic ball contact point:  $\phi$  3mm nylon ball

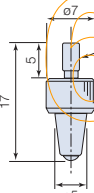
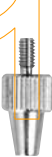

•Flat carbide contact point

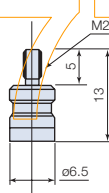

•Off-center contact point:  $\phi$  1mm steel ball

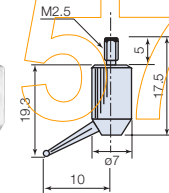

•Pin contact point

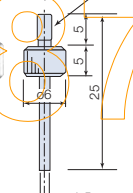

## SZ70-2 Adapter

SZ70-2 is required for connecting the following scale units and counters:

Gauge unit : DE-BR Counterunit : LT30 Interface unit : MG series

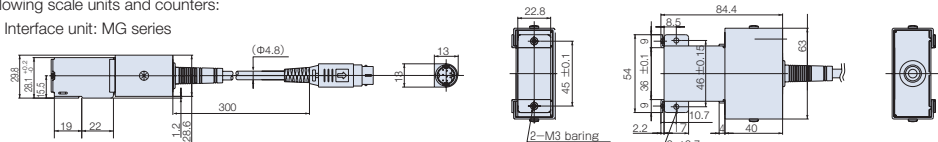

\*Please refer to p54 for the details of the screw.

Unit : mm

# Accessories (for DT series)

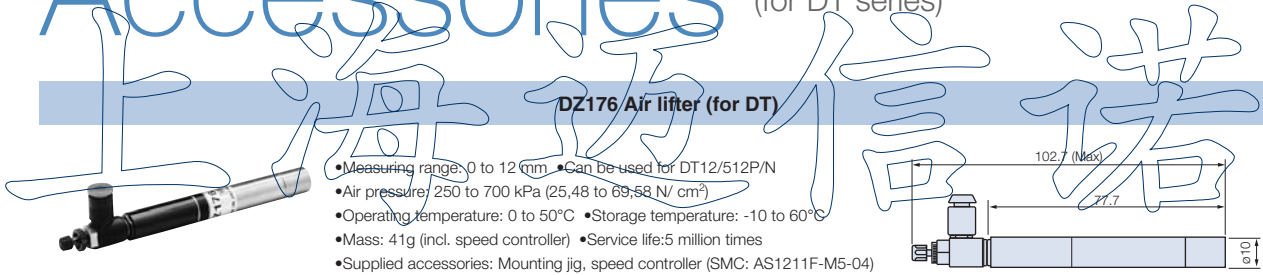

unit : mm

## DZ-191 Coupling

## DZ-100 Roller feeler (for DT Series, DG-B Series: except for DG155BP/205BP)

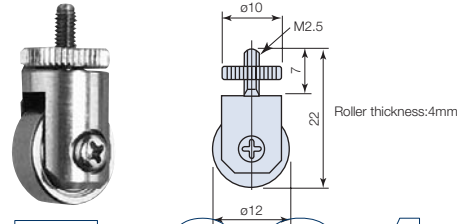
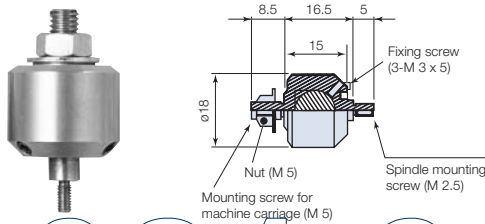

T: 021 3227 0811

Unit : mm

Unit : mm

**Other accessories**

- CE-08 Extension cable : CE08-01 (1m) , 03 (3m) , 05 (5m) , 10 (10m) , 15 (15m)
- CK-T Extension cable (Ahead-proof) : CK-T12 (1m) , T13 (3m) , T14 (5m) , T15 (10m)
- CK-T101/T105 (Winding-proof) : T101 (3m) , T105 (5m) S

F: 021 6277 5787

\*Please refer to p54 for the details of the screw.